



Danbury Close, Grassmoor Chesterfield S42 5HG

welcome to

Danbury Close, Grassmoor Chesterfield

****Guide Price £190,000 - £200,000**** A well-presented two-bedroom detached bungalow offering spacious accommodation throughout, ample off-road parking and attractive gardens, making it an excellent choice for those seeking comfortable single-storey living.

Front Of Property & Driveway

This attractive detached bungalow enjoys a pleasant position with a neatly maintained front lawn and a generous driveway providing off-road parking for multiple vehicles. The property offers excellent kerb appeal with low-maintenance brick elevations and access to the rear garden.

Hallway

A welcoming entrance hall provides access to the principal rooms of the property. The space offers a practical introduction to the home with a bright and airy feel.

Kitchen

Fitted with a range of wall and base units, the kitchen provides ample worktop and storage space. There is room for essential appliances, and the layout has been designed to maximise functionality, making it ideal for everyday cooking and meal preparation.

Lounge

The spacious lounge is a comfortable and inviting reception room, benefiting from a large window that allows plenty of natural light to flood the space. Offering ample room for a variety of furniture arrangements, it is ideal for both relaxing and entertaining.

Bedroom One

A generously proportioned double bedroom featuring fitted wardrobes which provide excellent storage solutions. The room is bright and well-presented, offering ample space for bedroom furnishings.

Bedroom Two

A versatile second bedroom that could comfortably accommodate a double bed or be utilised as a guest room, home office or hobby room. The room enjoys pleasant natural light and a neutral décor.

Bathroom

The bathroom is fitted with a three-piece suite with a shower, wash/ hand basin and WC. Functional and well-maintained, the room serves the needs of the household with ease.

Outside

To the rear, the property benefits from an enclosed garden with patio and lawn areas, providing an excellent space for outdoor seating, gardening and entertaining during the warmer months.

The property also benefits from solar panels on the roof that belong to Shades Greener. The roof space is rented and the home owner gets the benefit of the electric generated. After the remaining 10 year lease is completed, the solar panels then become the property of the home owner.





view this property online williamhbrown.co.uk/Property/CSF105056



welcome to

Danbury Close, Grassmoor Chesterfield

- ****Guide Price £190,000 - £200,000****
- Council Tax Band - B
- Two Well-Proportioned Bedrooms
- Spacious Lounge
- Generous Driveway And Off-Road Parking

Tenure: Freehold EPC Rating: Awaiting

Council Tax Band: B

guide price

£190,000

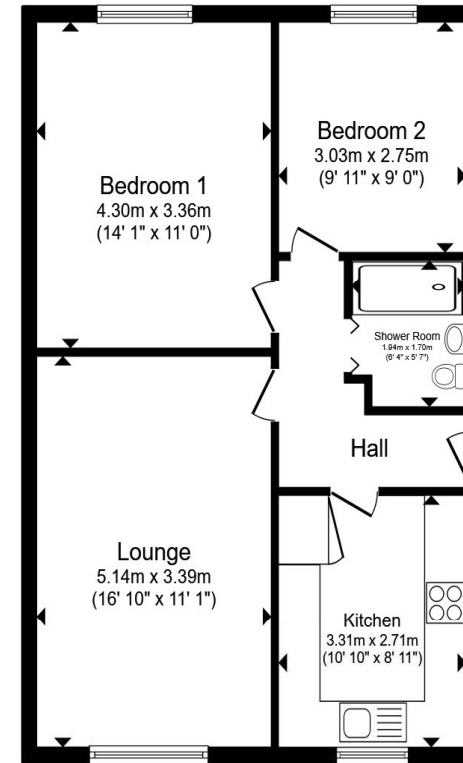

Total floor area 59.1 m² (637 sq.ft.) approx

This floor plan is for illustrative purposes only. It is not drawn to scale. Any measurements, floor areas (including any total floor area), openings and orientation are approximate. No details are guaranteed, they cannot be relied upon for any purpose and they do not form part of any agreement. No liability is taken for any error, omission or misstatement. A party must rely upon its own inspection(s). Powered by www.propertybox.io



view this property online williamhbrown.co.uk/Property/CSF105056



Property Ref:
CSF105056 - 0005

1. MONEY LAUNDERING REGULATIONS Intending purchasers will be asked to produce identification documentation at a later stage and we would ask for your co-operation in order that there is no delay in agreeing the sale. 2. These particulars do not constitute part or all of an offer or contract. 3. The measurements indicated are supplied for guidance only and as such must be considered incorrect. Potential buyers are advised to recheck measurements before committing to any expense. 4. We have not tested any apparatus, equipment, fixtures or services and it is in the buyers interest to check the working condition of any appliances. 5. Where an EPC, or a Home Report (Scotland only) is held for this property, it is available for inspection at the branch by appointment. If you require a printed version of a Home Report, you will need to pay a reasonable production charge reflecting printing and other costs. 6. We are not able to offer an opinion either written or verbal on the content of these reports and this must be obtained from your legal representative. 7. Whilst we take care in preparing these reports, a buyer should ensure that his/her legal representative confirms as soon as possible all matters relating to title including the extent and boundaries of the property and other important matters before exchange of contracts.

William H Brown is a trading name of Sequence (UK) Limited which is registered in England and Wales under company number 4268443, Registered Office is Cumbria House, 16-20 Hockliffe Street, Leighton Buzzard, Bedfordshire, LU7 1GN. VAT Registration Number is 500 2481 05.

 william h brown



01246 204492



chesterfield@williamhbrown.co.uk



6 Glumangate, CHESTERFIELD, Derbyshire, S40 1TP



williamhbrown.co.uk