



**Fairbank, Shipley BD18 2EW**

**welcome to**

**Fairbank, Shipley**

Available with no chain and situated in Shipley, we have a three bedroom detached property for sale. This property offers versatile accommodation and great potential to improve throughout. EPC: C.



Situated in a highly convenient location of Shipley and available with no onward chain, we have a three bedroom detached property for sale. This property offers versatile accommodation and great potential to improve throughout. Located within easy reach of local shops and everyday amenities, this property is ideal for families, first-time buyers, or anyone seeking a comfortable home with excellent access to the surrounding area.

Internally, the property offers an entrance hallway, kitchen, living room and three bedrooms to the first floor with a family bathroom. Externally, the property benefits from a good size gated driveway and an enclosed artificial lawned area to the front with a patio area and garden shed to the rear. Double glazing and central heating throughout.

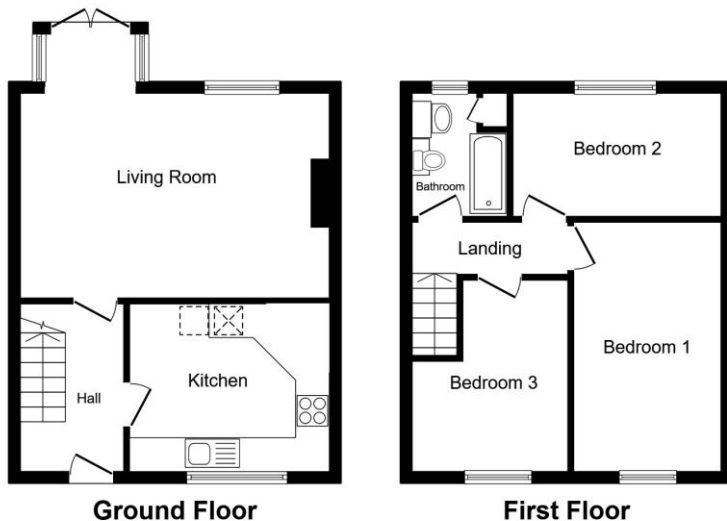

Total floor area 75.5 m<sup>2</sup> (813 sq.ft.) approx

This floor plan is for illustrative purposes only. It is not drawn to scale. Any measurements, floor areas (including any total floor area), openings and orientation are approximate. No details are guaranteed, they cannot be relied upon for any purpose and they do not form part of any agreement. No liability is taken for any error, omission or misstatement. A party must rely upon its own inspection(s). Powered by [www.propertybox.io](http://www.propertybox.io)



## Entrance Hallway

## Kitchen

9' 10" x 11' 9" ( 3.00m x 3.58m )

## Living Room

11' 10" x 18' 2" ( 3.61m x 5.54m )

## Bedroom One

7' 2" x 11' 10" ( 2.18m x 3.61m )

## Bedroom Two

14' 6" x 8' 8" ( 4.42m x 2.64m )

## Bedroom Three

5' 10" x 11' 3" ( 1.78m x 3.43m )

## Bathroom

## Exterior



**view this property online** [williamhbrown.co.uk/Property/SHP111536](http://williamhbrown.co.uk/Property/SHP111536)



welcome to

## Fairbank, Shipley

- Detached three bedroom home
- Ideal first time purchase
- Highly convenient location
- Gated driveway
- Front and rear garden

Tenure: Freehold EPC Rating: C  
Council Tax Band: B

**£160,000**



Please note the marker reflects the  
postcode not the actual property

**view this property online** [williambrown.co.uk/Property/SHP111536](https://www.williambrown.co.uk/Property/SHP111536)



Property Ref:  
SHP111536 - 0003

1. MONEY LAUNDERING REGULATIONS Intending purchasers will be asked to produce identification documentation at a later stage and we would ask for your co-operation in order that there is no delay in agreeing the sale. 2. These particulars do not constitute part or all of an offer or contract. 3. The measurements indicated are supplied for guidance only and as such must be considered incorrect. Potential buyers are advised to recheck measurements before committing to any expense. 4. We have not tested any apparatus, equipment, fixtures or services and it is in the buyers interest to check the working condition of any appliances. 5. Where an EPC, or a Home Report (Scotland only) is held for this property, it is available for inspection at the branch by appointment. If you require a printed version of a Home Report, you will need to pay a reasonable production charge reflecting printing and other costs. 6. We are not able to offer an opinion either written or verbal on the content of these reports and this must be obtained from your legal representative. 7. Whilst we take care in preparing these reports, a buyer should ensure that his/her legal representative confirms as soon as possible all matters relating to title including the extent and boundaries of the property and other important matters before exchange of contracts.

William H Brown is a trading name of Sequence (UK) Limited which is registered in England and Wales under company number 4268443, Registered Office is Cumbria House, 16-20 Hockliffe Street, Leighton Buzzard, Bedfordshire, LU7 1GN. VAT Registration Number is 500 2481 05.



william h brown



**01274 531233**



ShIPLEY@williambrown.co.uk



21 Market Square, SHIPLEY, West Yorkshire,  
BD18 3QB



**williambrown.co.uk**