



David Drive, Skegness PE25 1TS

welcome to

David Drive, Skegness

A well-presented semi-detached two bedroom bungalow in a sought-after area of Skegness. Offering a spacious lounge, fitted kitchen, generous driveway with electric gates, private rear garden, substantial workshop with conversion potential. Viewing is highly recommended.

Entrance

A spacious and welcoming entrance hall with loft access, radiator and useful built-in storage cupboard, providing access to all principal rooms.

Lounge/Dining Room

11' x 10' (3.35m x 3.05m)

A bright and comfortable reception room featuring dual aspect windows allowing plenty of natural light, electric fireplace, radiator and ample space for lounge furniture.

Kitchen

15' x 6' (4.57m x 1.83m)

A well-appointed fitted kitchen comprising a range of cream wall and base units with contrasting worktops, integrated gas hob, electric oven, space for further appliances, sink unit with mixer tap and window overlooking the rear aspect. Finished with attractive tiled flooring.

Conservatory

14' x 8' (4.27m x 2.44m)

A lovely additional reception room enjoying views across the rear garden and open fields beyond. Double doors lead directly onto the patio, making this an excellent space for relaxing or entertaining.

Bedroom One

13' x 10' (3.96m x 3.05m)

A spacious double bedroom with window to the front aspect, fitted wardrobes, radiator and attractive décor providing excellent storage.

Bedroom Two

12' x 8' (3.66m x 2.44m)

A well-proportioned second bedroom with rear aspect window enjoying countryside views, radiator and space for bedroom furniture.

Shower Room

Modern shower room fitted with a large walk-in shower enclosure with sliding doors, vanity wash hand basin with storage, low-level WC, heated towel radiator and contemporary wall finishes.

External Front

The property is accessed via electric gates opening onto a generous driveway providing off-road parking for several vehicles, together with access to the workshop.

External Rear

A private, low maintenance rear garden laid with decorative gravel, patio seating areas, mature planting and attractive field views, offering a peaceful outdoor setting.

Workshop

19' x 17' (5.79m x 5.18m)

A substantial detached workshop complete with power, lighting, windows and double entrance doors. This versatile space is ideal for storage, hobbies or, subject to the relevant permissions, could be converted into a games room, home office, gym or additional entertaining space.





view this property online williamhbrown.co.uk/Property/SKG110413



welcome to

David Drive, Skegness

- Semi-Detached two bedroom bungalow
- Popular residential location in Skegness
- Bright lounge with electric fireplace
- Fitted kitchen with integrated appliances
- Conservatory overlooking the rear garden

Tenure: Freehold EPC Rating: C

Council Tax Band: B

£210,000

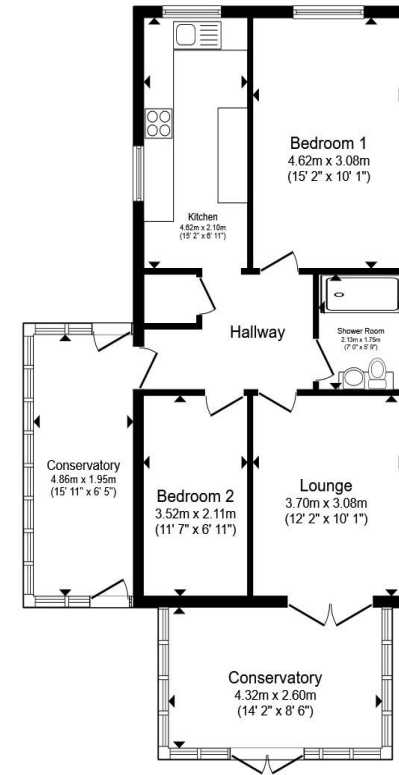

Total floor area 79.1 m² (852 sq.ft.) approx

This floor plan is for illustrative purposes only. It is not drawn to scale. Any measurements, floor areas (including any total floor area), openings and orientation are approximate. No details are guaranteed, they cannot be relied upon for any purpose and they do not form part of any agreement. No liability is taken for any error, omission or misstatement. A party must rely upon its own inspection(s). Powered by www.propertybox.io



view this property online williamhbrown.co.uk/Property/SKG110413



Property Ref:
SKG110413 - 0006

1. MONEY LAUNDERING REGULATIONS Intending purchasers will be asked to produce identification documentation at a later stage and we would ask for your co-operation in order that there is no delay in agreeing the sale. 2. These particulars do not constitute part or all of an offer or contract. 3. The measurements indicated are supplied for guidance only and as such must be considered incorrect. Potential buyers are advised to recheck measurements before committing to any expense. 4. We have not tested any apparatus, equipment, fixtures or services and it is in the buyers interest to check the working condition of any appliances. 5. Where an EPC, or a Home Report (Scotland only) is held for this property, it is available for inspection at the branch by appointment. If you require a printed version of a Home Report, you will need to pay a reasonable production charge reflecting printing and other costs. 6. We are not able to offer an opinion either written or verbal on the content of these reports and this must be obtained from your legal representative. 7. Whilst we take care in preparing these reports, a buyer should ensure that his/her legal representative confirms as soon as possible all matters relating to title including the extent and boundaries of the property and other important matters before exchange of contracts.



01754 768311



Skegness@williamhbrown.co.uk



20 Roman Bank, SKEGNESS, Lincolnshire, PE25 2RU



williamhbrown.co.uk