



## Dawson Road, NW2

**TO LET - £5,000 Per Month**

AVAILABLE TO LET - A superb four/five-bedroom double-fronted semi-detached home. This substantial property offers an impressive 1864 sq ft of accommodation, making it an ideal family home.

On the Ground Floor, there are two spacious reception rooms, a large kitchen/dining room, and an additional room ideal as a study or fifth bedroom. The Upper Floors contain the principal bedroom with en-suite shower room, three further bedrooms, and a loft conversion providing an additional bedroom. Outside there's a well maintained private rear garden, a high-quality garden studio and off-street parking for two vehicles at the front.

Located just moments from the open green spaces of Gladstone Park and within easy reach of Willesden Green Station (Jubilee Line, Zone 2),

- 4/5 Bedroom semi-detached house laid out over 1864 sq ft
- 3 Spacious reception rooms and 2 bathrooms
- Off Street Parking and Private Garden
- Close to local park transport (Zone 2)
- Council: Brent - G Deposit: £6,057



020 8450 9377

[rentals@cameronsstiff.co.uk](mailto:rentals@cameronsstiff.co.uk)

[cameronsstiff.co.uk](http://cameronsstiff.co.uk)

## Dawson Road, NW2

Approx Gross Internal Area = 173.2 sq m / 1864 sq ft  
 Restricted head height / Eaves = 31.6 sq m / 340 sq ft

Studio = 13.6 sq m / 146 sq ft

Shed = 2 sq m / 22 sq ft

Total = 220.4 sq m / 2372 sq ft

For identification only - Not to scale

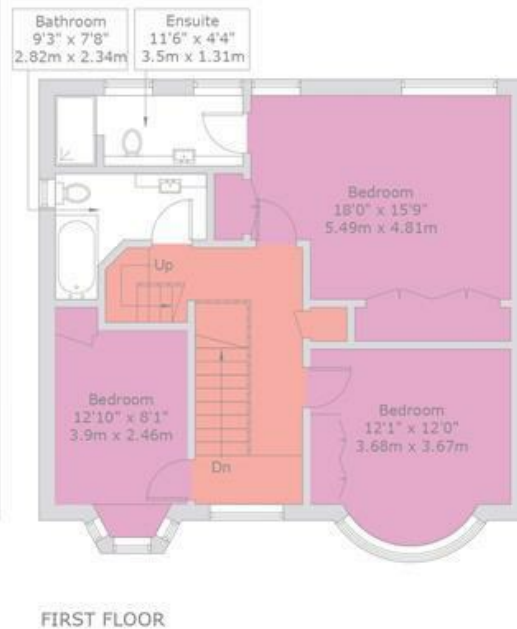
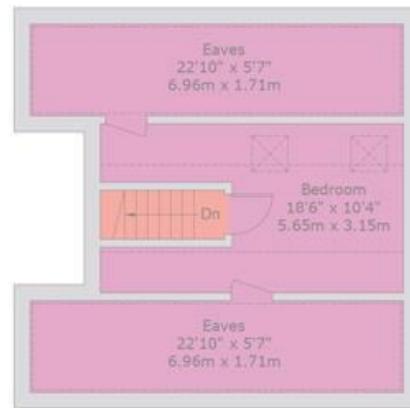
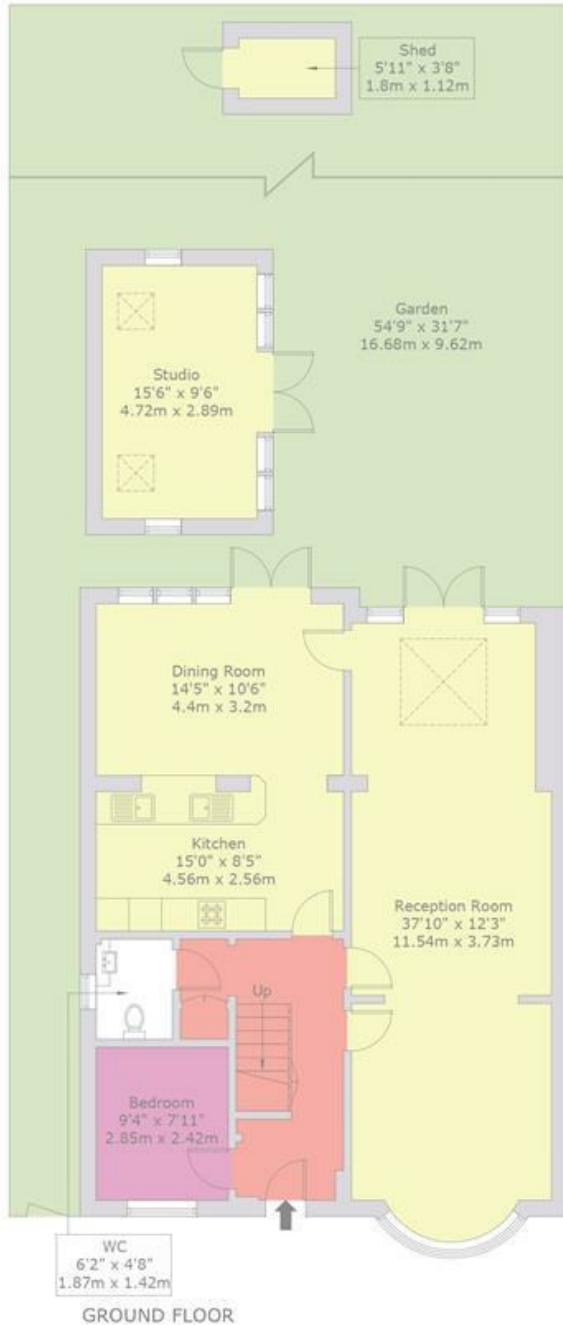

This floor plan is produced in accordance with RICS Property Measurement Standards incorporating International Property Measurement Standards (IPMS2 Residential). Maximum lengths and widths are represented on the floor plan. Produced for Cameron Stiff & Co. Copyright © BLEUPLAN

EPC: D  
 Ref: 19456623

