



Highfield, King's Lynn, PE30 4RD

welcome to

Highfield, King's Lynn

Ideal first time buy or investment opportunity with this three bedroom end terrace house which has been recently refurbished and is located close to The Queen Elizabeth Hospital and is being offered with no onward chain. Viewing highly recommended.



Double Glazed Entrance Door To

Entrance Hall

Stairs to first floor

Cloakroom

Low level WC, wash hand basin,

Lounge

15' 10" x 11' 9" (4.83m x 3.58m)

Double glazed window, electric radiator, double doors to:-

Kitchen/ Dining Room

17' 11" x 9' 9" (5.46m x 2.97m)

Range of base and wall units, roll edge work top, inset stainless steel sink, space for cooker, washing machine, tumble dryer, two double glazed windows, double glazed door to rear

First Floor Landing

Loft access, storage cupboard

Bedroom One

11' 10" x 10' 11" (3.61m x 3.33m)

Double glazed window, storage cupboard

Bedroom Two

12' 10" x 9' 9" (3.91m x 2.97m)

Double glazed window, built-in wardrobe

Bedroom Three

8' 9" x 7' 9" (2.67m x 2.36m)

Double glazed window

Bathroom

7' 9" x 5' 10" (2.36m x 1.78m)

Bath with mains shower and shower screen, low level WC, wash hand basin with cupboards below, part tiled walls, double glazed window

Outside

Enclosed rear garden with rear access gate and large garden shed.

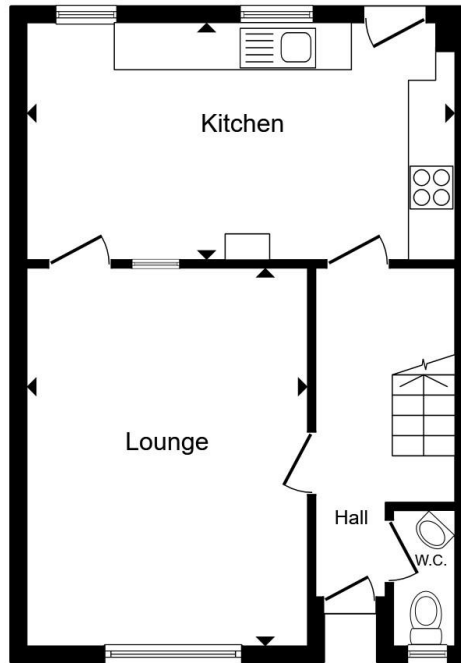

Ground Floor

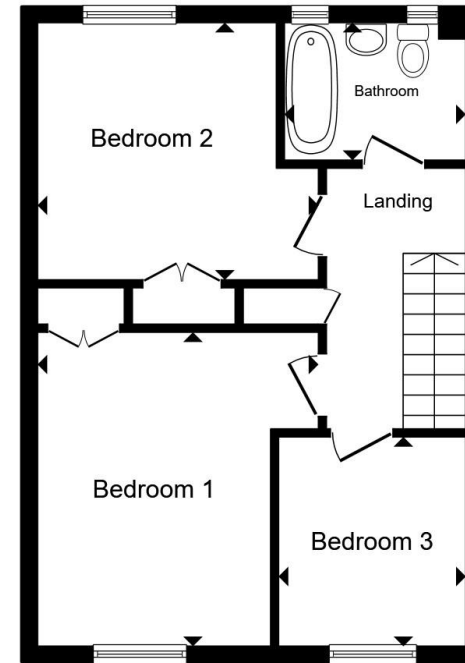

First Floor

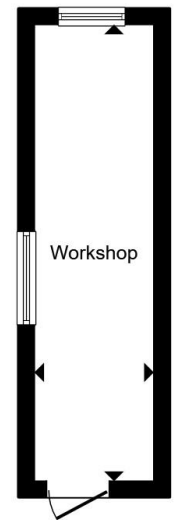

Outbuilding

Total floor area 94.9 m² (1,021 sq.ft.) approx

This floor plan is for illustrative purposes only. It is not drawn to scale. Any measurements, floor areas (including any total floor area), openings and orientation are approximate. No details are guaranteed, they cannot be relied upon for any purpose and they do not form part of any agreement. No liability is taken for any error, omission or misstatement. A party must rely upon its own inspection(s). Powered by www.propertybox.io



view this property online williamhbrown.co.uk/Property/KLN119532



william
h brown

welcome to

Highfield, King's Lynn

- Ideal First Time Buy or Investment Opportunity
- End of Terrace House
- Kitchen/ Dining Room
- Spacious Lounge
- Cloakroom

Tenure: Freehold EPC Rating: D
Council Tax Band: A

£165,000



Please note the marker reflects the postcode not the actual property

view this property online [williamhbrown.co.uk/Property/KLN119532](https://www.williamhbrown.co.uk/Property/KLN119532)



Property Ref:
KLN119532 - 0004

1. MONEY LAUNDERING REGULATIONS Intending purchasers will be asked to produce identification documentation at a later stage and we would ask for your co-operation in order that there is no delay in agreeing the sale. 2. These particulars do not constitute part or all of an offer or contract. 3. The measurements indicated are supplied for guidance only and as such must be considered incorrect. Potential buyers are advised to recheck measurements before committing to any expense. 4. We have not tested any apparatus, equipment, fixtures or services and it is in the buyers interest to check the working condition of any appliances. 5. Where an EPC, or a Home Report (Scotland only) is held for this property, it is available for inspection at the branch by appointment. If you require a printed version of a Home Report, you will need to pay a reasonable production charge reflecting printing and other costs. 6. We are not able to offer an opinion either written or verbal on the content of these reports and this must be obtained from your legal representative. 7. Whilst we take care in preparing these reports, a buyer should ensure that his/her legal representative confirms as soon as possible all matters relating to title including the extent and boundaries of the property and other important matters before exchange of contracts.

William H Brown is a trading name of Sequence (UK) Limited which is registered in England and Wales under company number 4268443, Registered Office is Cumbria House, 16-20 Hockliffe Street, Leighton Buzzard, Bedfordshire, LU7 1GN. VAT Registration Number is 500 2481 05.



william h brown



01553 771337



KingsLynn@williamhbrown.co.uk



40-42 King Street, KING'S LYNN, Norfolk, PE30 1ES



[williamhbrown.co.uk](https://www.williamhbrown.co.uk)