



Apartment 33 Hythe Lodge, 157 Boyn Valley Road, Maidenhead SL6 4GB

welcome to

Apartment 33 Hythe Lodge, 157 Boyn Valley Road, Maidenhead

A beautifully presented top floor one double bedroom apartment set within a highly popular modern development, just a short and easy walk from the town centre and station. Immaculately maintained by the current owner, the property is ideal for buyers seeking a genuine 'turn-key' home. A secure communal entrance leads to well-kept shared areas and a lift serving the upper floors. Inside, the apartment features a hallway which opens into the bright and spacious living area with access to the balcony which stretches across the property. The lovely reception space enjoys plenty of natural light and flows seamlessly into the modern, well-appointed kitchen, complete with a range of units and integrated appliances. The property is completed by the impressive double bedroom and the contemporary bathroom. Outside, residents enjoy access to well-maintained communal grounds, along with the convenience of allocated parking.



Boyn Valley Road, Maidenhead, SL6

Approximate Area = 524 sq ft / 48.6 sq m

For identification only - Not to scale

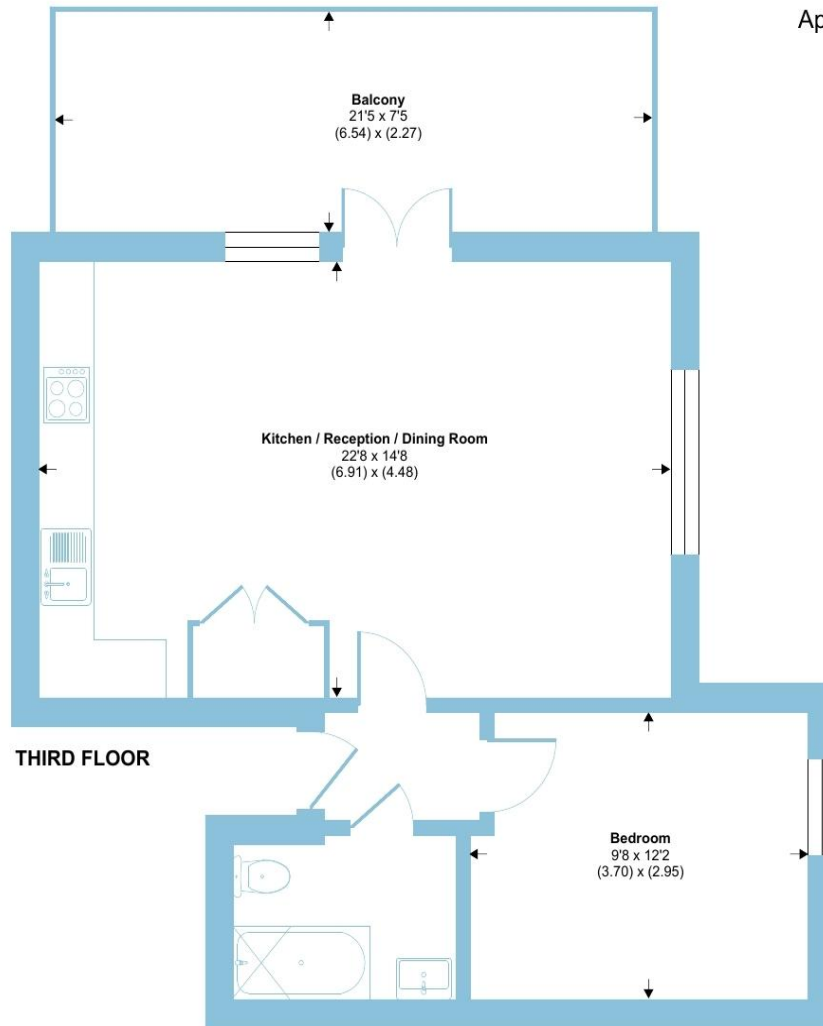

welcome to

Apartment 33 Hythe Lodge

- EASY ACCESS TO TOWN CENTRE & STATION
- BEAUTIFULL PRESENTED TOP FLOOR APARTMENT
- ONE DOUBLE BEDROOM
- CONTEMPORARY BATHROOM
- LARGE OPEN PLAN LIVING ROOM & KITCHEN
- BALCONY
- RESIDENTS PARKING
- IDEAL FIRST PURCHASE AND/OR INVESTMENT

Tenure: Leasehold EPC Rating: C

Council Tax Band: C Service Charge: 1788.72

Ground Rent: Ask Agent

This is a Leasehold property with details as follows; Term of Lease 250 years from 01 Dec 2021. Should you require further information please contact the branch. Please Note additional fees could be incurred for items such as Leasehold packs.

£300,000



check out more properties at rogerplatt.co.uk



Property Ref:
MHD123936 - 0002

1. MONEY LAUNDERING REGULATIONS Intending purchasers will be asked to produce identification documentation at a later stage and we would ask for your co-operation in order that there is no delay in agreeing the sale. 2. These particulars do not constitute part or all of an offer or contract. 3. The measurements indicated are supplied for guidance only and as such must be considered incorrect. Potential buyers are advised to recheck measurements before committing to any expense. 4. We have not tested any apparatus, equipment, fixtures or services and it is in the buyers interest to check the working condition of any appliances. 5. Where an EPC, or a Home Report (Scotland only) is held for this property, it is available for inspection at the branch by appointment. If you require a printed version of a Home Report, you will need to pay a reasonable production charge reflecting printing and other costs. 6. We are not able to offer an opinion either written or verbal on the content of these reports and this must be obtained from your legal representative. 7. Whilst we take care in preparing these reports, a buyer should ensure that his/her legal representative confirms as soon as possible all matters relating to title including the extent and boundaries of the property and other important matters before exchange of contracts.

Roger Platt is a trading name of Sequence (UK) Limited which is registered in England and Wales under company number 4268443, Registered Office is Cumbria House, 16-20 Hockliffe Street, Leighton Buzzard, Bedfordshire, LU7 1GN. VAT Registration Number is 500 2481 05.



Please note the marker reflects the postcode not the actual property



01628 773333



Maidenhead@rogerplatt.co.uk



25-29 Queen Street, MAIDENHEAD, Berkshire, SL6 1NB



rogerplatt.co.uk