

LEASEHOLD



Flat - Ground Floor - Council Tax Band A - EPC Rating: C

**7, HEATHER COURT, 48 RUSSELL ROAD,
MOSELEY, BIRMINGHAM, B13 8RF**
Guide Price

£180,000



7, Heather Court, 48 Russell Road, Moseley, Birmingham, B13 8RF

Well-presented 2-bedroom ground floor apartment. Comprising entrance hallway, spacious living room, two double bedrooms, modern fitted kitchen and bathroom with shower over bath. Gas central heating and double-glazing throughout. Off-street parking to rear and single garage included in separate block. Heather Court is superbly situated for access to Moseley Village which boasts several independent bars, restaurants and cafes. The property is also in near locality to many green spaces, outstanding schools, excellent bus links and Moseley and Kings Heath train stations are within a 20 minute walk from the property and will be opening later this year.

Situation

Tenure:

We understand the flat is LEASEHOLD with 900+ years remaining on the lease, though interested parties should obtain verification from their own solicitor. We have been informed there is an annual service charge of £1311 and no ground rent applicable.



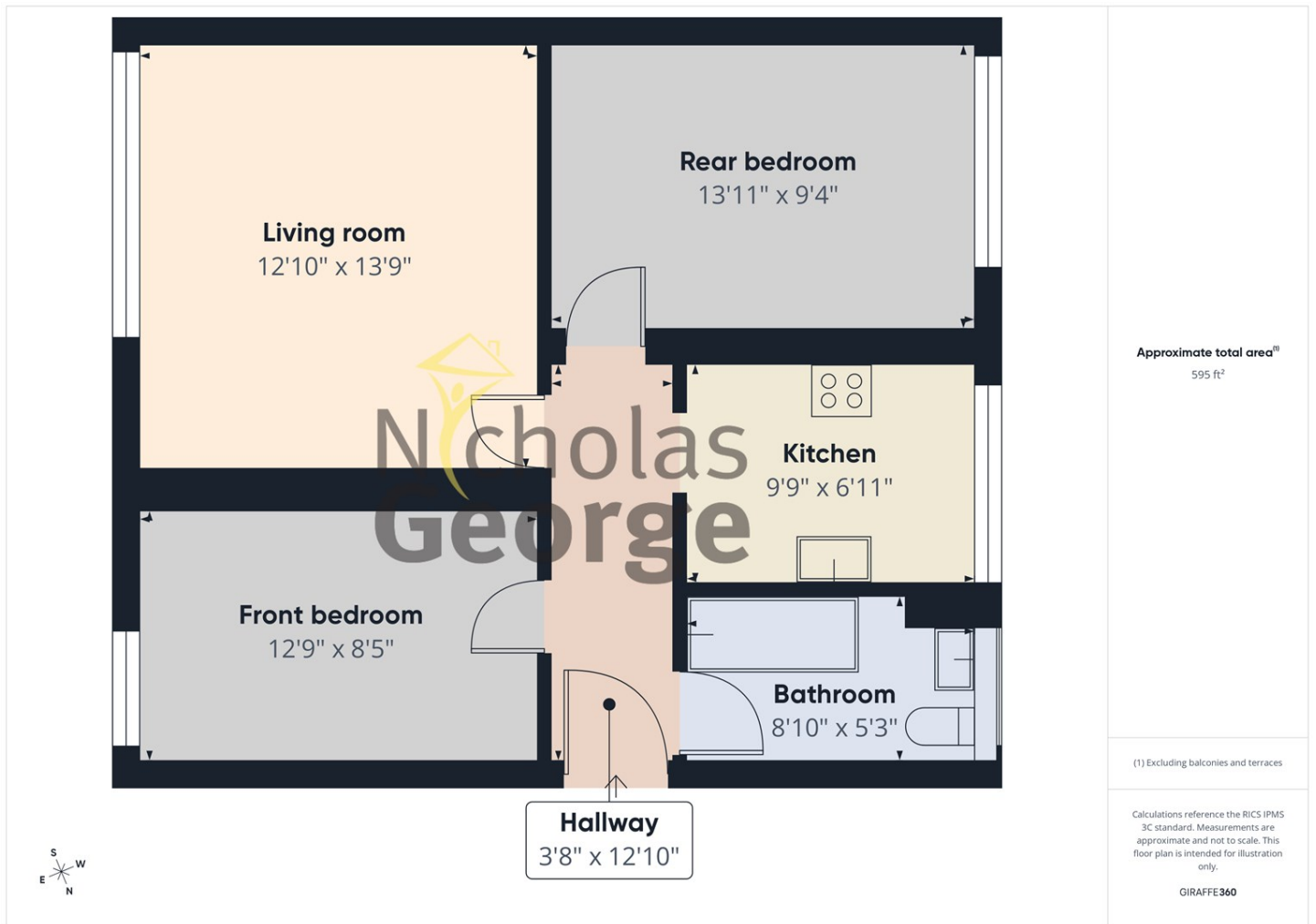

Energy Performance Graph

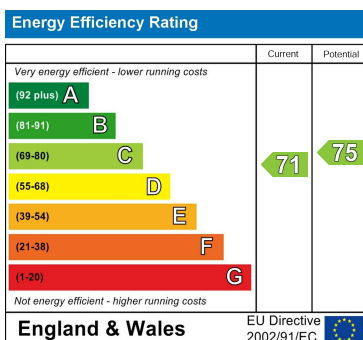

Contact us:

Phone: 0121 442 2049

Email: sales@nicholasgeorge.co.uk

Tenure:

We understand the property is Leasehold with XXX years remaining but interested parties should obtain verification from their own solicitor.

Fees:

We have been informed that annual service charge is £XXX and annual ground rent is £XXX.

Agents Note: Whilst every care has been taken to prepare these particulars, they are for guidance purposes only. All measurements are approximate and are for general guidance purposes only and whilst every care has been taken to ensure their accuracy, they should not be relied upon and potential buyers are advised to recheck the measurements.

