



## HOCKERILL STREET, BISHOP'S STORTFORD

OFFERS OVER – £250,000

- 2 BEDROOM SECOND FLOOR APARTMENT FOR SALE
- NO ONWARD CHAIN
- REDECORATED THROUGHOUT
- OPEN PLAN LIVING, KITCHEN & DINING ROOM
- 2 DOUBLE BEDROOMS
- EN-SUITE TO BEDROOM 1
- THREE PIECE FAMILY BATHROOM
- ALLOCATED PARKING SPACE
- TOWN CENTRE LOCATION
- WITHIN CLOSE PROXIMITY TO THE MAINLINE RAILWAY STATION

We are pleased to offer this well-presented and redecorated 2 bedroom apartment for sale in the popular town of Bishop's Stortford. This property boasts a large open plan kitchen, living and dining room, en-suite to bedroom 1, a second bedroom and a three piece family bathroom. Externally, the property enjoys an allocated parking space and is within close proximity to the mainline railway station.





### **Open Plan Kitchen, Living & Dining Room - 22'9" x 12'9"**

Comprising an array of eye and base level cupboards and drawers with complimentary rolled work surfaces and tiled splash back, single bowl single drainer stainless steel sink unit with mixer tap, integrated oven and electric hob and extractor fan over, under counter fridge freezer and washing machine, inset ceiling downlighting and flooring. The living room-diner comprises of wall mounted lighting, windows to front aspect, fitted carpet, TV, telephone and power points.

### **Bedroom 1 - 11'2" x 10'2"**

With window to front, fitted carpet, wall mounted lighting, wall mounted radiator and power points, door to:

### **En-suite Shower Room**

Comprising a fully tiled and glazed shower cubicle and integrated shower, closed coupled W.C, pedestal wash hand basin with mixer tap, tiled splashback and storage beneath, half tiled surround, ceiling lighting, wall mounted chromium heated towel rail, linoleum flooring.

### **Bedroom 2 - 13'5" x 11'2"**

With window to front, built-in double wardrobe, built-in shelving, fitted carpet, wall mounted lighting, wall mounted radiator and power points.

### **Family Bathroom**

Comprising a three piece suite of panel enclosed bath with mixer tap and shower attachment over, tiled surround with glazed screen, low level WC with integrated flush, pedestal wash hand basin with mixer tap and tiled splashback, electric shaving point, wall mounted chromium heated towel rail, inset ceiling downlighting, linoleum flooring.

# OUTSIDE

## Externals

The property benefits from an allocated parking space to the rear, and is ideally within close proximity to local amenities and the mainline railway station.



# DETAILS

## EPC

Score	Energy rating	Current	Potential
92+	A		
81-91	B		
69-80	C	76 C	77 C
55-68	D		
39-54	E		
21-38	F		
1-20	G		

## FLOOR PLAN

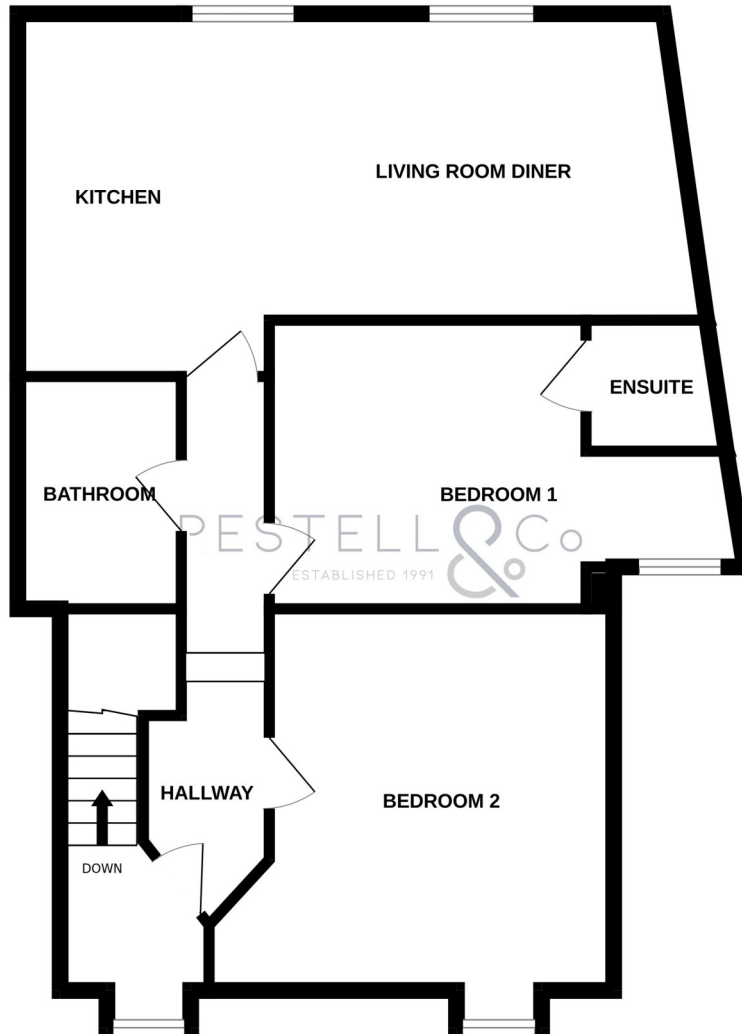

TOTAL FLOOR AREA : 771 sq.ft. (71.6 sq.m.) approx.

Whilst every attempt has been made to ensure the accuracy of the floorplan contained here, measurements of doors, windows, rooms and any other items are approximate and no responsibility is taken for any error, omission or mis-statement. This plan is for illustrative purposes only and should be used as such by any prospective purchaser. The services, systems and appliances shown have not been tested and no guarantee as to their operability or efficiency can be given.

Made with Metropix ©2025

# GENERAL REMARKS & STIPULATIONS

Hockerill Street, Bishop's Stortford is located within a short walk to the popular town centre and the Bishop's Stortford mainline train station which serves London Liverpool Street, Cambridge and Stansted Airport, with also the M11 and M25 motorways being just a short drive, giving easy onward access to London and the north.

## DIRECTIONS

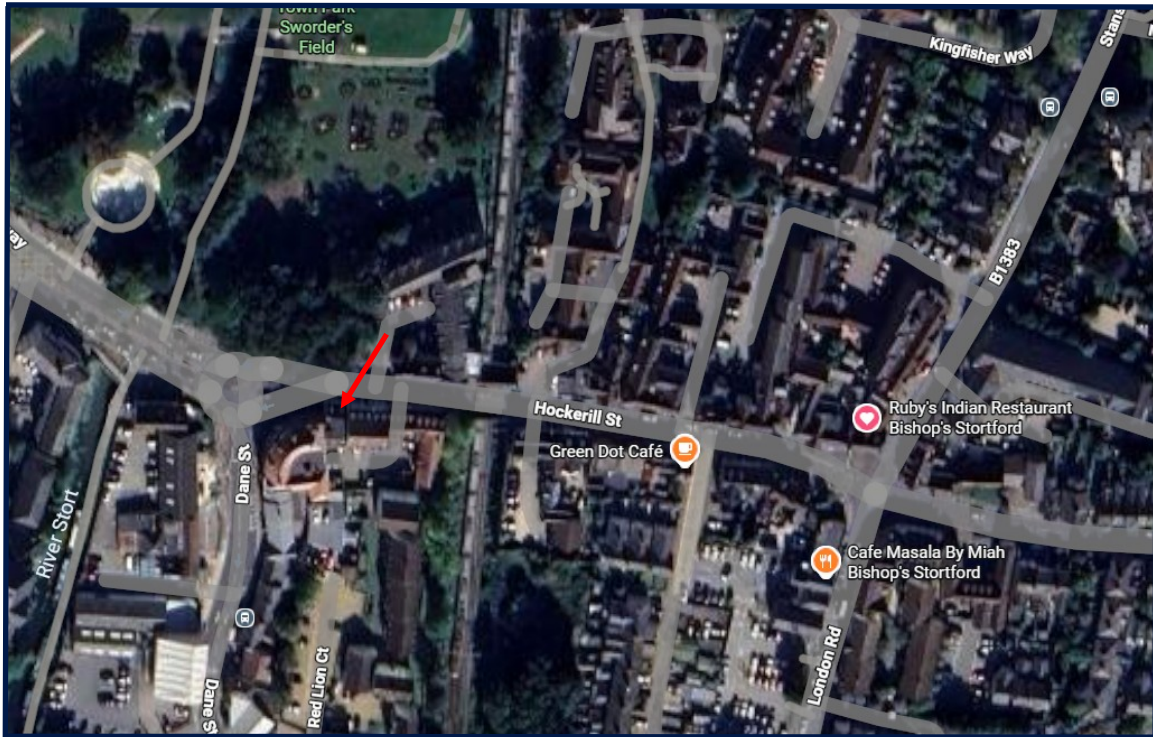

### FULL PROPERTY ADDRESS

14 Hockerill Street, Bishop's Stortford, Hertfordshire,  
CM23 2DW

### COUNCIL TAX BAND

Band B

### SERVICES

Gas fired central heating, mains drainage and water

### LOCAL AUTHORITY

East Hertfordshire District Council, Wallfields, Pegs  
Lane, Hertford, SG13 8EQ

LEASE REMAINING - 999 yrs

SERVICE CHARGE - TBC

GROUND RENT - TBC

**AGENTS NOTE:** We believe the information provided in this brochure is accurate as of the date 18/05/2026. The information given in these particulars is intended to help you decide whether you wish to view this property and to avoid wasting your time in viewing unsuitable properties. We have tried to make sure that these particulars are accurate, but to a large extent we have to rely on what the seller tells us about the property. We do not check every single piece of information ourselves as the cost of doing so would be prohibitive and we do not wish to unnecessarily add to the cost of moving house. In accordance with the misrepresentation act, we are required to inform both potential vendors and purchasers, that from time to time both vendors and or purchasers, may be known by our staff, by way of previous customers, friends, neighbours, relatives, etc. Once you find the property you want to buy, you will need to carry out more investigations into the property than it is practical or reasonable for an estate agent to do when preparing sales particulars. For example, we have not carried out any kind of survey of the property to look for structural defects and would advise any homebuyer to obtain a surveyor's report before exchanging contracts. If you do not have your own surveyor, we would be pleased to recommend one. We have not checked whether any equipment in the property (such as central heating) is in working order and would advise homebuyers to check this. You should also instruct a solicitor to investigate all legal matters relating to the property (e.g. title, planning permission etc.), as these are specialist matters in which estate agents are not qualified. Your solicitor will also agree with the seller what items (e.g. carpets, curtains etc.) will be included in the sale.

# PESTELL & Co

ESTABLISHED 1991

ESTABLISHING OURSELVES AS LEADING LOCAL AGENTS FOR OVER 35 YEARS!



WE HAVE IT COVERED, DON'T HESITATE TO CONTACT ONE OF OUR EXPERIENCED TEAM FOR FURTHER INFORMATION!

Would you like a free home valuation?

Interested in land acquisition?

Want to change agent and get your property sold?

Do you have a commercial property to sell or let?

Do you have a property that you would like to rent but uncertain how to go about it?

Are you a developer looking for an agent to market or value your site?