



**Kingsmead Court, Littleport CB6 1LR**

**welcome to**

## **Kingsmead Court, Littleport**

A much improved and well proportioned end of terrace house situated within a popular residential area of Littleport offering two bedrooms, three reception rooms, garage and low maintenance gardens - Early viewing highly recommended.

### **Entrance Hall**

With radiator, stairs leading to first floor with storage cupboard beneath, doors to:

### **Kitchen/Breakfast Room**

Recently updated with a matching range of base units and drawers, matching wall units, inset stainless steel sink and drainer unit with mixer tap over, built in under oven with hob and extractor over, spaces for fridge/freezer and dishwasher, radiator and double glazed window to front aspect.

### **Lounge/Diner**

With radiator, double doors to conservatory and door to:

### **Study**

With double glazed window to front aspect and door to:

### **Cloakroom/Utility**

Fitted with a suite comprising low level w.c, pedestal wash hand basin, space for washing machine and double glazed window to rear.

### **Conservatory**

Of UPVC construction with windows to three sides, fitted blinds, French doors opening to rear garden.





### **First Floor Landing**

With radiator, loft access, double glazed window to side aspect and doors to:

### **Bedroom One**

With radiator, fitted wardrobes and double glazed window to front aspect.

### **Bedroom Two**

With radiator, fitted wardrobes and double glazed windows to rear aspect.

### **Bathroom**

Recently updated and fitted with a suite comprising panel enclosed bath with mixer tap, shower attachment over and glass shower screen, vanity unit with low level w.c, wash hand basin and storage cupboards, heated towel radiator, extractor and double glazed window to side.

### **Outside**

To the front of the property there is a low maintenance garden predominantly laid to slate with a pathway to the front door and space for parking for one car. The rear garden is presented for ease of maintenance mainly laid to block paving with shrub and plant borders. Gated access leads to the garage and parking.



***view this property online*** [williamhbrown.co.uk/Property/ELY110232](http://williamhbrown.co.uk/Property/ELY110232)



welcome to

## Kingsmead Court, Littleport

- End of Terrace House
- Popular Location
- Well Proportioned Accommodation
- Two Bedrooms
- Three Reception Rooms

Tenure: Freehold

EPC Rating: C

Council Tax Band: B

guide price

**£235,000**

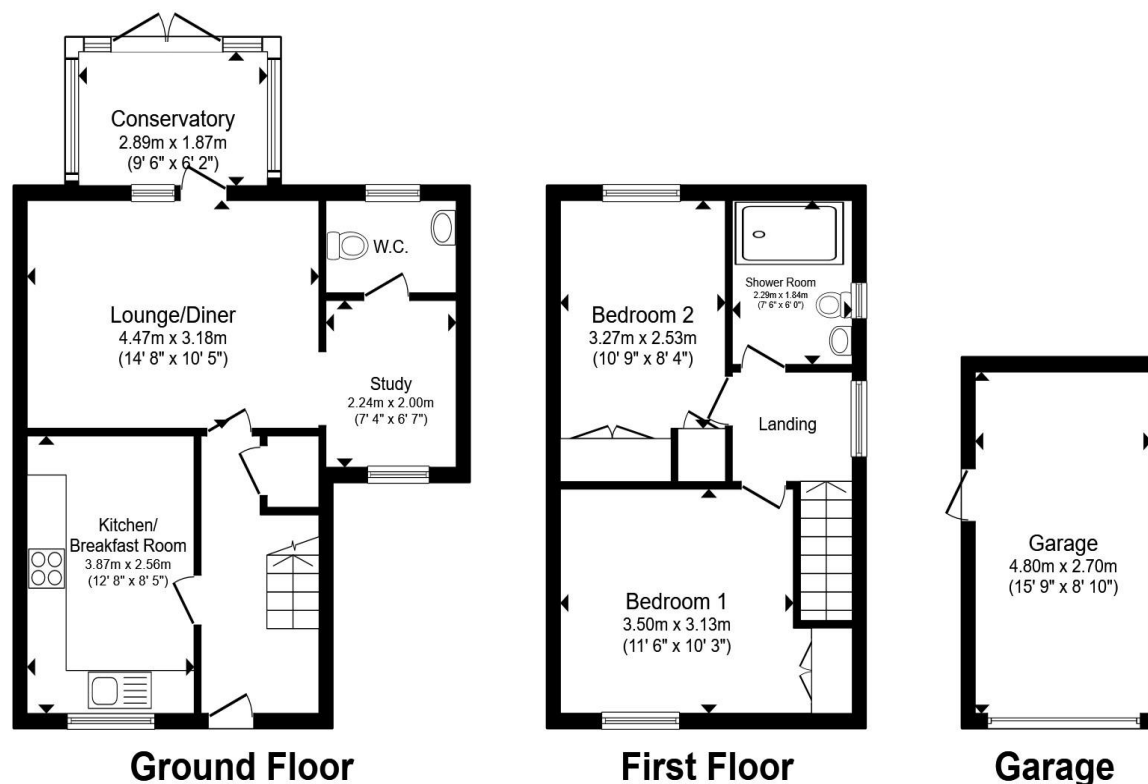

Total floor area 90.6 m<sup>2</sup> (975 sq.ft.) approx

This floor plan is for illustrative purposes only. It is not drawn to scale. Any measurements, floor areas (including any total floor area), openings and orientation are approximate. No details are guaranteed, they cannot be relied upon for any purpose and they do not form part of any agreement. No liability is taken for any error, omission or misstatement. A party must rely upon its own inspection(s). Powered by [www.propertybox.io](http://www.propertybox.io)



view this property online [williamhbrown.co.uk/Property/ELY110232](http://williamhbrown.co.uk/Property/ELY110232)



Property Ref:  
ELY110232 - 0002

1. MONEY LAUNDERING REGULATIONS Intending purchasers will be asked to produce identification documentation at a later stage and we would ask for your co-operation in order that there is no delay in agreeing the sale. 2. These particulars do not constitute part or all of an offer or contract. 3. The measurements indicated are supplied for guidance only and as such must be considered incorrect. Potential buyers are advised to recheck measurements before committing to any expense. 4. We have not tested any apparatus, equipment, fixtures or services and it is in the buyers interest to check the working condition of any appliances. 5. Where an EPC, or a Home Report (Scotland only) is held for this property, it is available for inspection at the branch by appointment. If you require a printed version of a Home Report, you will need to pay a reasonable production charge reflecting printing and other costs. 6. We are not able to offer an opinion either written or verbal on the content of these reports and this must be obtained from your legal representative. 7. Whilst we take care in preparing these reports, a buyer should ensure that his/her legal representative confirms as soon as possible all matters relating to title including the extent and boundaries of the property and other important matters before exchange of contracts.

William H Brown is a trading name of Sequence (UK) Limited which is registered in England and Wales under company number 4268443, Registered Office is Cumbria House, 16-20 Hockliffe Street, Leighton Buzzard, Bedfordshire, LU7 1GN. VAT Registration Number is 500 2481 05.

  
william h brown



**01353 663311**



[ely@williamhbrown.co.uk](mailto:ely@williamhbrown.co.uk)



6 Forehill, ELY, Cambridgeshire, CB7 4AF



[williamhbrown.co.uk](http://williamhbrown.co.uk)