



New Road offers in the region of £270,000

- Ground-floor apartment
- Main bathroom with roll-top bath
- Separate wet room
- Open-plan living accommodation
- Garage and rear lane access
- Popular village location
- EPC Rating: C



 2  2  1



About the property

A rare opportunity to purchase this spacious and stylish two-bedroom ground-floor apartment, which must be viewed to fully appreciate the accommodation on offer.

The property features two well-proportioned bedrooms, a main bathroom complete with an elegant roll-top bath, and a separate wet room for added convenience.

Upon entering, you are welcomed into a bright open-plan living space incorporating a fitted kitchen with a range of base and wall units, providing ample storage. The living area boasts high ceilings, creating a wonderful sense of space and character, while double doors open directly onto the rear garden.

Externally, the property benefits from a low-maintenance private garden, a garage, and rear lane access. Situated in the highly sought-after area of Newton Village, residents can enjoy a range of local amenities, including shops, bus routes, and traditional pubs, all within easy reach.



Accommodation

Kitchen

11' 10" x 10' 8" (3.61m x 3.25m)

Living Room

11' 10" x 10' 8" (3.61m x 3.25m)

Bedroom One

13' 3" x 10' 3" (4.04m x 3.12m)

Bedroom Two

8' 2" x 7' 3" (2.49m x 2.21m)

01656 771600

porthcawl@peteralan.co.uk

Floorplan

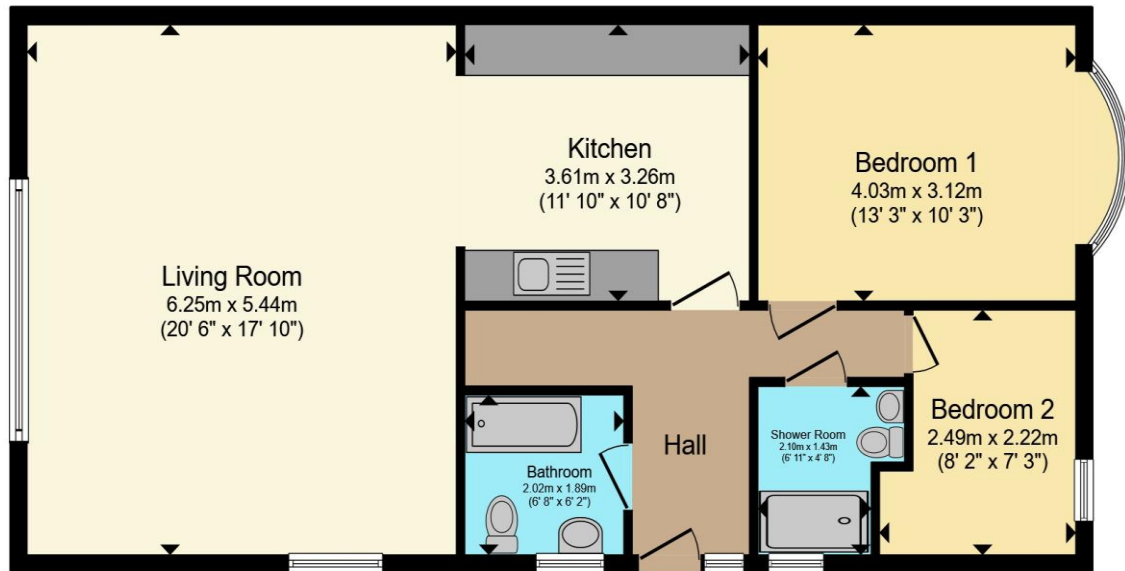

Total floor area 83.9 m² (903 sq.ft.) approx

This floor plan is for illustrative purposes only. It is not drawn to scale. Any measurements, floor areas (including any total floor area), openings and orientation are approximate. No details are guaranteed, they cannot be relied upon for any purpose and they do not form part of any agreement. No liability is taken for any error, omission or misstatement. A party must rely upon its own inspection(s). Powered by www.propertybox.io



Important Information

Note while we endeavour to make our sales details accurate and reliable, if there is any point which is of particular interest to you, please contact the office and we will be pleased to confirm the position for you. We have not personally tested any apparatus, equipment, fixtures, fittings or services and cannot verify they are in working order or fit for their purposes. Nothing in these particulars is intended to indicate that carpets or curtains, furnishings or fittings, electrical goods (whether wired or not). Gas fires or light fittings or any other fixtures not expressly included form part of the property offered for sale. This computer generated Floorplan, if applicable, is intended as a general guide to the layout and design of the property. It is not to scale and should not be relied upon for dimensions. Tenure: We cannot confirm the tenure of the property as we have not had access to the legal documents. The buyer is advised to obtain verification from their solicitor or surveyor.

Peter Alan Limited is registered in England and Wales under company number 2073153. Registered Office is Cumbria House, 16-20 Hockliffe Street, Leighton Buzzard, Bedfordshire, LU7 1GN. VAT Registration Number is 500 2481 05. For activities relating to regulated mortgages and non-investment insurance contracts, Peter Alan Limited is an appointed representative of Connells Limited which is authorised and regulated by the Financial Conduct Authority. Connells Limited's Financial Services Register number is 302221. Most buy-to-let

