



Cosford Close, Bishopstoke, Eastleigh. SO50 8PQ

welcome to

Cosford Close, Bishopstoke, Eastleigh

Situated in a quiet residential cul-de-sac in the heart of Bishopstoke, this well-presented one-bedroom ground-floor maisonette offers comfortable, low-maintenance living with the added benefit of its own private entrance. Ideal for first-time buyers, downsizers or investors, the home provides a practical layout and a welcoming sense of space throughout.

The property features a bright living room with garden outlook, a well-proportioned double bedroom, a fitted kitchen with ample storage, and a neatly presented bathroom completes the internal accommodation. Being on the ground floor, the property is easily accessible and offers a more private, homely feel than typical apartment living.

Externally, the maisonette enjoys a private garden and access to communal gardens and benefits from one allocated parking space, making day-to-day living simple and convenient. There is also a convenient outside storage cupboard with power and lighting.

Cosford Close is a peaceful and well-regarded location within Bishopstoke, positioned close to local shops, riverside walks, bus routes, and excellent transport links into Eastleigh and beyond. The area is known for its friendly community feel and easy access to green spaces, making it an appealing choice for a range of buyers. A great opportunity to secure a well-located ground-floor home in a sought-after village setting. Early viewing is highly recommended.



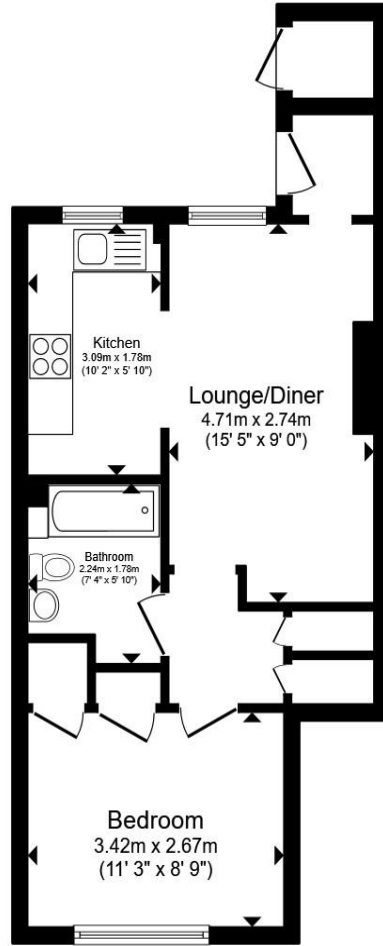

Entrance Hall

Lounge/Diner

15' 5" x 9' (4.70m x 2.74m)

Kitchen

10' 2" x 9' 10" (3.10m x 3.00m)

Bathroom

7' 4" x 5' 10" (2.24m x 1.78m)

Hallway

Bedroom

11' 3" x 8' 9" (3.43m x 2.67m)

Outside Store Cupboard

Parking

Garden

Total floor area 39.8 m² (429 sq.ft.) approx

This floor plan is for illustrative purposes only. It is not drawn to scale. Any measurements, floor areas (including any total floor area), openings and orientation are approximate. No details are guaranteed, they cannot be relied upon for any purpose and they do not form part of any agreement. No liability is taken for any error, omission or misstatement. A party must rely upon its own inspection(s). Powered by www.propertybox.io



welcome to

Cosford Close, Bishopstoke, Eastleigh

- GUIDE PRICE OF £140,000 - £150,000
- GROUND FLOOR
- OWN FRONT ENTRANCE
- ONE ALLOCATED PARKING SPACE
- PRIVATE GARDEN AND COMMUNAL GARDENS

Tenure: Leasehold EPC Rating: D

Council Tax Band: A Service Charge: 992.96

Ground Rent: 60.00

This is a Leasehold property with details as follows; Term of Lease 215 years from 24 Jun 1980. Should you require further information please contact the branch. Please Note additional fees could be incurred for items such as Leasehold packs.

Directions to this property:

Fox and Sons Estate Agents Eastleigh

44 Market St, Eastleigh SO50 5RA

Head towards Regal Walk

Turn left onto Wells PI

At the roundabout, take the 1st exit onto Southampton Rd/A335

Continue to follow A335

At the roundabout, take the 4th exit onto Bishopstoke Rd/B3037

Turn left onto Olympic Way

Turn right onto Cosford Cl

Your destination will be on the left

Awaiting Photograph



Please note the marker reflects the postcode not the actual property

view this property online fox-and-sons.co.uk/Property/ELH106952



Property Ref:
ELH106952 - 0008

1. MONEY LAUNDERING REGULATIONS Intending purchasers will be asked to produce identification documentation at a later stage and we would ask for your co-operation in order that there is no delay in agreeing the sale. 2. These particulars do not constitute part or all of an offer or contract. 3. The measurements indicated are supplied for guidance only and as such must be considered incorrect. Potential buyers are advised to recheck measurements before committing to any expense. 4. We have not tested any apparatus, equipment, fixtures or services and it is in the buyers interest to check the working condition of any appliances. 5. Where an EPC, or a Home Report (Scotland only) is held for this property, it is available for inspection at the branch by appointment. If you require a printed version of a Home Report, you will need to pay a reasonable production charge reflecting printing and other costs. 6. We are not able to offer an opinion either written or verbal on the content of these reports and this must be obtained from your legal representative. 7. Whilst we take care in preparing these reports, a buyer should ensure that his/her legal representative confirms as soon as possible all matters relating to title including the extent and boundaries of the property and other important matters before exchange of contracts.

fox & sons



023 8061 8522



Eastleigh@fox-and-sons.co.uk



44 Market Street, EASTLEIGH, Hampshire, SO50 5RA



fox-and-sons.co.uk