



Waring Crescent, Aston Clinton Aylesbury HP22 0AB



This lovely three bedroom home is offered in excellent presentation and, being built only eight years ago benefits from modern fittings and is still under warranty, meaning peace of mind and low maintenance living. A very appealing energy rating B suggests you should expect very good efficiency and heating economy. The house is available to purchase 60% (or more) on the shared ownership scheme. The property is also available to purchase 100%.

The accommodation briefly comprises: entrance hall, w/c, fitted kitchen, living/dining room, three good size bedrooms and a family bathroom. There is a front garden and driveway and gated access to the rear garden which is mainly lawn with a storage shed and a paved patio.

Location

The house is located in a peaceful setting close to the centre of the village and just a stone's throw from play parks and countryside walks. Just a short stroll away, is The Oak; a traditional thatched family pub/restaurant, and within easy walking distance you will find the village store and post office, The Bell Inn, primary school, church, cricket club, Aston Park (excellent for dog walks) with play area, café, five a side football pitch and allotments. There is a petrol station, doctors surgery, dentist and pharmacy. There are several excellent golf courses a short drive away including Chiltern Forest a little over a mile away. There is a regular bus service through the village linking Aylesbury to Watford and the A41 dual carriageway is easily accessible giving convenient access to the M25 (jtn 20) in 15 mins or so making the journey to Heathrow and other London airports quite simple. There are train stations at Tring (serving London Euston) and nearby Wendover and Aylesbury (Marylebone). The property also falls within the catchment area for the highly sought after Grammar Schools in Aylesbury.

Agent's Note:

This property is currently under shared ownership in conjunction with Bromford Housing Association who have criteria for any purchase, the advertised price is for the sellers 60% share. £467.72 per month is paid to the Housing Association as rent for the retained share. Service Charge is £47.60. Please contact with Bromford Housing Association for guidance on purchase requirements. In addition, Bromford Housing Association have advised that they would be prepared to staircase a transaction to 100% Freehold ownership. This would mean that any potential purchaser would buy the vendor's 60% share and the remaining 40% share from Bromford Housing Association providing a Freehold purchase on completion. Your conveyancer will advise with regard to the timescales involved and you should satisfy yourself in regard to lending affordability





welcome to Waring Crescent, Aston Clinton Aylesbury

- 60% shared ownership (up to 100% available to buy)
- Sought after Buckinghamshire village close to amenities
- Remainder of New Build warranty
- Driveway for two cars
- Three bedrooms

Tenure: Leasehold EPC Rating: B

Council Tax Band: D Service Charge: 47.60

Ground Rent: Ask Agent

This is a Leasehold property with details as follows; Term of Lease 125 years from 16 Dec 2019. Should you require further information please contact the branch. Please Note additional fees could be incurred for items such as Leasehold packs.

£274,200

A rare opportunity to purchase a superb, modern three bedroom semi-detached home on the 'shared ownership' scheme. The property is beautifully presented and still under warranty. Up to 100% available to purchase.

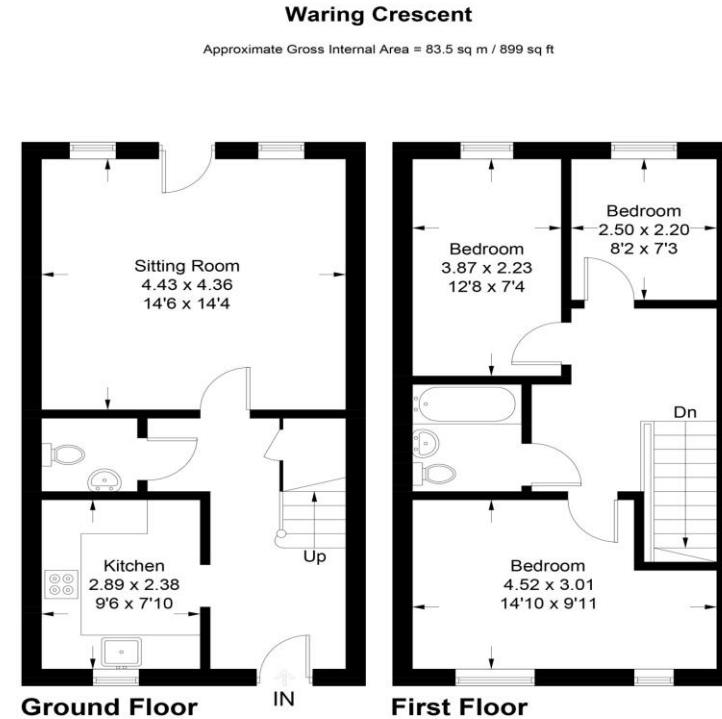

This plan is for layout guidance only. Not drawn to scale unless stated. Windows and door openings are approximate. Whilst every care is taken in the preparation of this plan, please check all dimensions, shapes and compass bearings before making any decisions reliant upon them. (ID1308166)

check out more properties at brownandmerry.co.uk
see all our properties on zoopla.co.uk | rightmove.co.uk | sequencehome.co.uk



Property Reference:
TRG109017 - 0002

1. MONEY LAUNDERING REGULATIONS Intending purchasers will be asked to produce identification documentation at a later stage and we would ask for your co-operation in order that there is no delay in agreeing the sale. 2. These particulars do not constitute part or all of an offer or contract. 3. The measurements indicated are supplied for guidance only and as such must be considered incorrect. Potential buyers are advised to recheck measurements before committing to any expense. 4. We have not tested any apparatus, equipment, fixtures or services and it is in the buyers interest to check the working condition of any appliances. 5. Where an EPC, or a Home Report (Scotland only) is held for this property, it is available for inspection at the branch by appointment. If you require a printed version of a Home Report, you will need to pay a reasonable production charge reflecting printing and other costs. 6. We are not able to offer an opinion either written or verbal on the content of these reports and this must be obtained from your legal representative. 7. Whilst we take care in preparing these reports, a buyer should ensure that his/her legal representative confirms as soon as possible all matters relating to title including the extent and boundaries of the property and other important matters before exchange of contracts.



01442 824133



Tring@brownandmerry.co.uk



41 High Street, TRING,
Hertfordshire, HP23 5AA



brownandmerry.co.uk