



ROSSITER ROAD, SW12

£650,000

- Two double bedrooms
- Large private garden
- Central balham
- Potential to extend
- Period conversion
- Energy rating: C





ABOUT THE HOME

A two bedroom apartment located in central Balham. The property includes two double bedrooms, one bathroom, separate kitchen and living room that leads out onto a large private garden.

Rossiter Road is a popular residential road and is within close proximity to Balham Station and the vast array of shops, bars and restaurants local to the area. Tooting Bec common is also within easy reach.





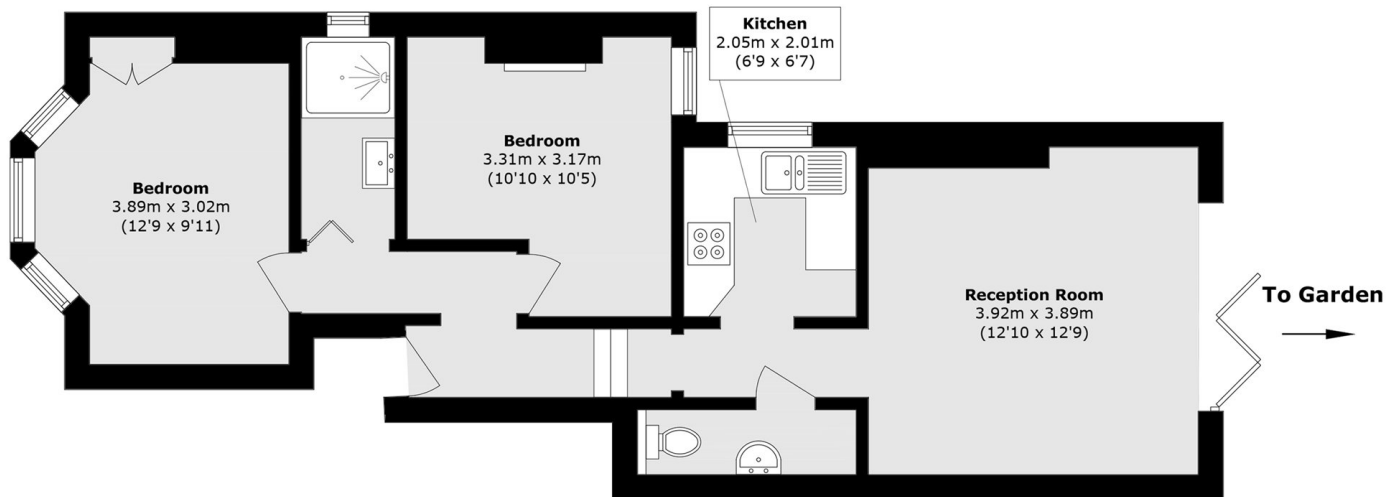

Total area (approx.): 53.2 sq. m (572.6 sq. ft)

JACKSONS BALHAM

8-11 Balham Station Road,
London, SW12 9SG
Sales: 020 8675 6555
Lettings: 020 8675 6565

Energy Rating: We aim to make our particulars both accurate and reliable. However they are not guaranteed; nor do they form part of an offer or contract. If you require clarification on any points then please contact us, especially if you're traveling some distance to view. Please note that appliances and heating systems have not been tested and therefore no warranties can be given as to their good working order.