

Colin Dean Residential

in partnership with Dexters



Sudbury Heights Avenue, UB6

£2,100 pcm

This beautifully presented three-bedroom mid-terrace home offers spacious and practical accommodation, making it an ideal choice for families. The property features a generous reception room and a stylish open-plan kitchen that flows seamlessly into a bright dining area with direct access to a private, well-maintained garden, perfect for everyday family living and entertaining guests. Energy Rating: C.

Situated on a quiet residential road, the property is conveniently located close to a range of local shops, bus routes, and well-regarded schools. Sudbury Town Station is approximately 0.3 miles away, providing excellent transport links via the Piccadilly line, while nearby rail services offer additional connections into Central London and beyond.

- Mid-Terrace House • Three Bedrooms • Large Reception •
- Modern Open-Plan Kitchen • Unfurnished • Private Garden •

Colin Dean Residential

in partnership with Dexters

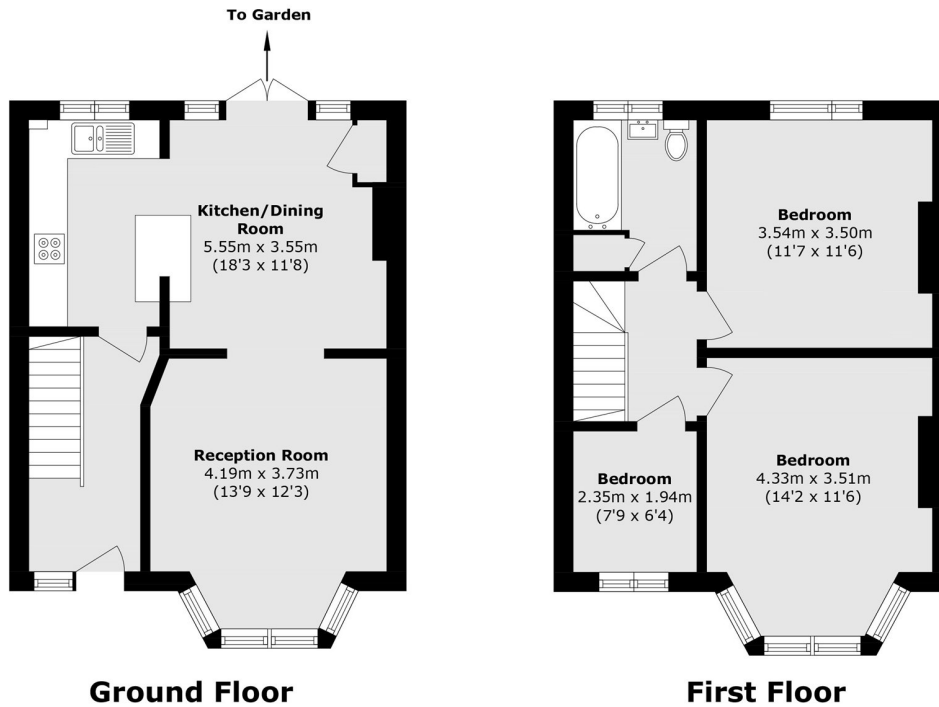

Total area (approx.): 81.8 sq. m (880.4 sq. ft)

Colin Dean Residential

350 Pinner Road,
Harrow, HA1 4LB

020 8515 7929

daniel.murray@colindean.com

Energy Rating: C We aim to make our particulars both accurate and reliable. However they are not guaranteed; nor do they form part of an offer or contract. If you require clarification on any points then please contact us, especially if you're travelling some distance to view. Please note that appliances and heating systems have not been tested and therefore no warranties can be given as to their good working order.