



10 Jacobs Close, Sheffield, South Yorkshire, S5 6EA

Offers In The Region Of £124,950

- Semi-Detached Home
- NO CHAIN
- Gas Central Heating
- Requires Modernisation Throughout
- Close To Local Amenities
- Two Bedrooms
- uPVC Double Glazing
- Standing In A Good Sized Plot
- Convenient Location
- Great Access to Northern General Hospital, Meadowhall and M1

10 Jacobs Close, Sheffield S5 6EA

Andersons are delighted to offer to the market this 2 bedroom semi detached house. The property is ideally located being close to Meadowhall Shopping Centre, M1 and Northern General Hospital and there are also a host of amenities and transport links close by. It is in need of full refurbishment and offers two bedrooms, one reception room, a driveway and a good sized rear garden. The property benefits from no chain and immediate vacant possession and would suit First Time Buyers, families or investors/developers.

The accommodation briefly comprises: Ground Floor; Entrance Porch, Living Room and kitchen. First Floor Landing, Two Bedrooms and Bathroom.

Outside the property has a lawned garden to the front, a driveway to the side which has access to the rear lawned garden



Council Tax Band: A



Accommodation

Ground Floor

Living Room

16'7" (max) x 11'6"

With a front facing uPVC double glazed window, a central heating radiator, wall mounted gas fire, feature beams to ceiling and delph shelf. Staircase with useful storage cupboard below.

Kitchen

11'6" x 6'5"

Fitted with a basic range of units above and below rolltop worksurfaces. Incorporated within is a stainless steel sink, there is space for a free standing cooker and space for a washing machine and fridge. There is a uPVC double glazed window, a uPVC door and the central heating boiler is housed here.

Landing

With loft access.

Bedroom One

11'6" x 8'10"

With a front facing uPVC double glazed window and a central heating radiator.

Bedroom Two

11'6" x 6'3"

With a rear facing uPVC double glazed window and a central heating radiator.

Bathroom

8'4" x 4'1"

Fitted with a three piece suite comprising of a panelled bath with electric shower over, pedestal wash hand basin and low flush w/c. Tiled splashback, a central heating radiator, a uPVC double glazed window and airing cupboard housing the hot water cylinder.

Outside

To the front of the property sees an area of lawn. There is car hard standing to the side and a gate leads to the large rear lawned garden, which is enclosed and has a timber shed.

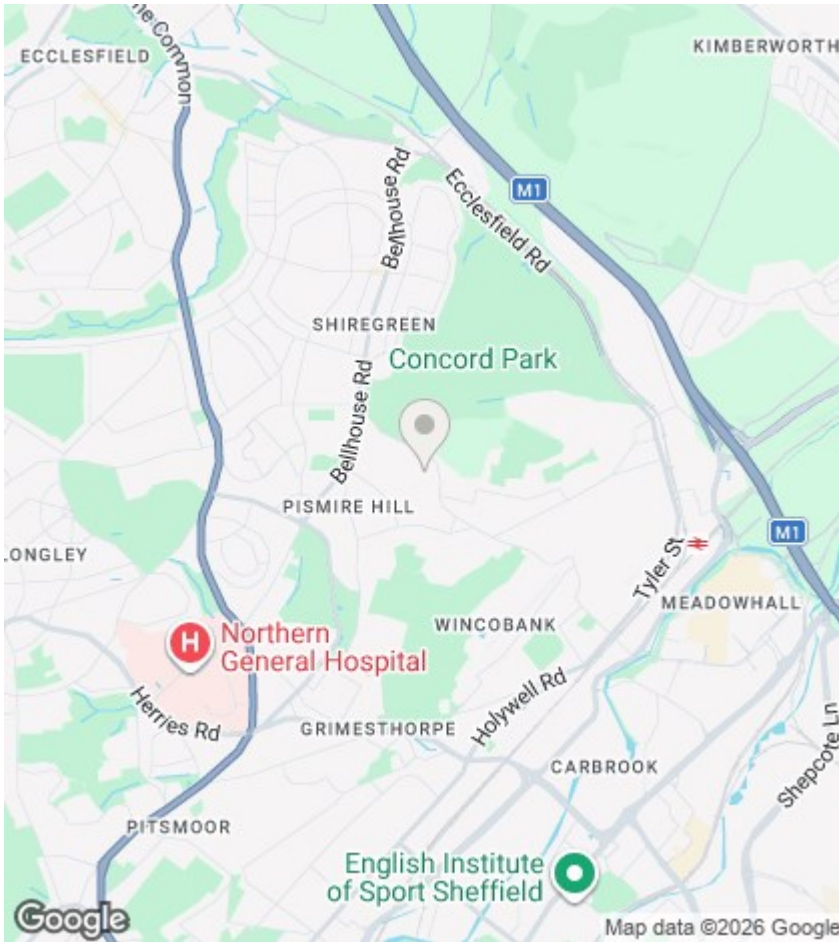

Directions

Viewings

Viewings by arrangement only. Call 0114 283 4050 to make an appointment.

EPC Rating:

C

Energy Efficiency Rating		Current	Potential
Very energy efficient - lower running costs			
(92 plus) A			
(81-91) B			86
(69-80) C		69	
(55-68) D			
(39-54) E			
(21-38) F			
(1-20) G			
Not energy efficient - higher running costs			
England & Wales		EU Directive 2002/91/EC	

Ground Floor

Approx. 26.3 sq. metres (283.3 sq. feet)

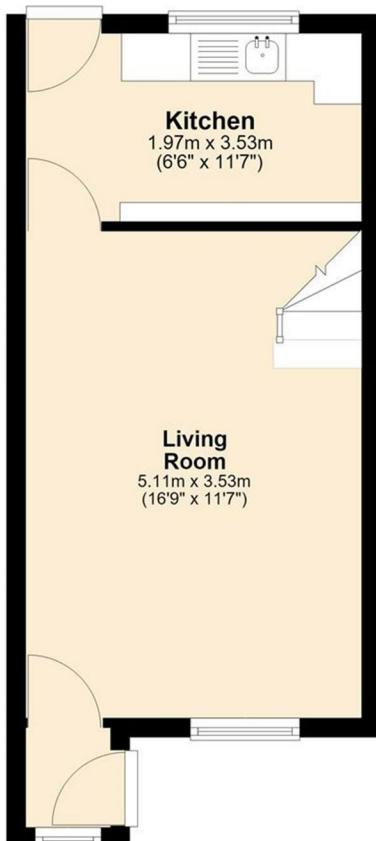

First Floor

Approx. 24.9 sq. metres (267.8 sq. feet)

