

Roper Crescent, TW16

£2,350 PCM

A luxury two double bedroom apartment, with two bathrooms and private balcony overlooking stunning landscape gardens. The apartment is finished to the highest standard and is located in a sought after development.

Roper Crescent is situated in the heart of Lower Sunbury. Perfectly positioned with Nuffield Health Club on your doorstep as well as Sunbury Station and the River Thames close by.

- Two Double Bedrooms • Two Bathrooms • Modern Development •
- Allocated Parking • Private Balcony • Landscaped Gardens •

SNELLERS

ESTATE AGENTS

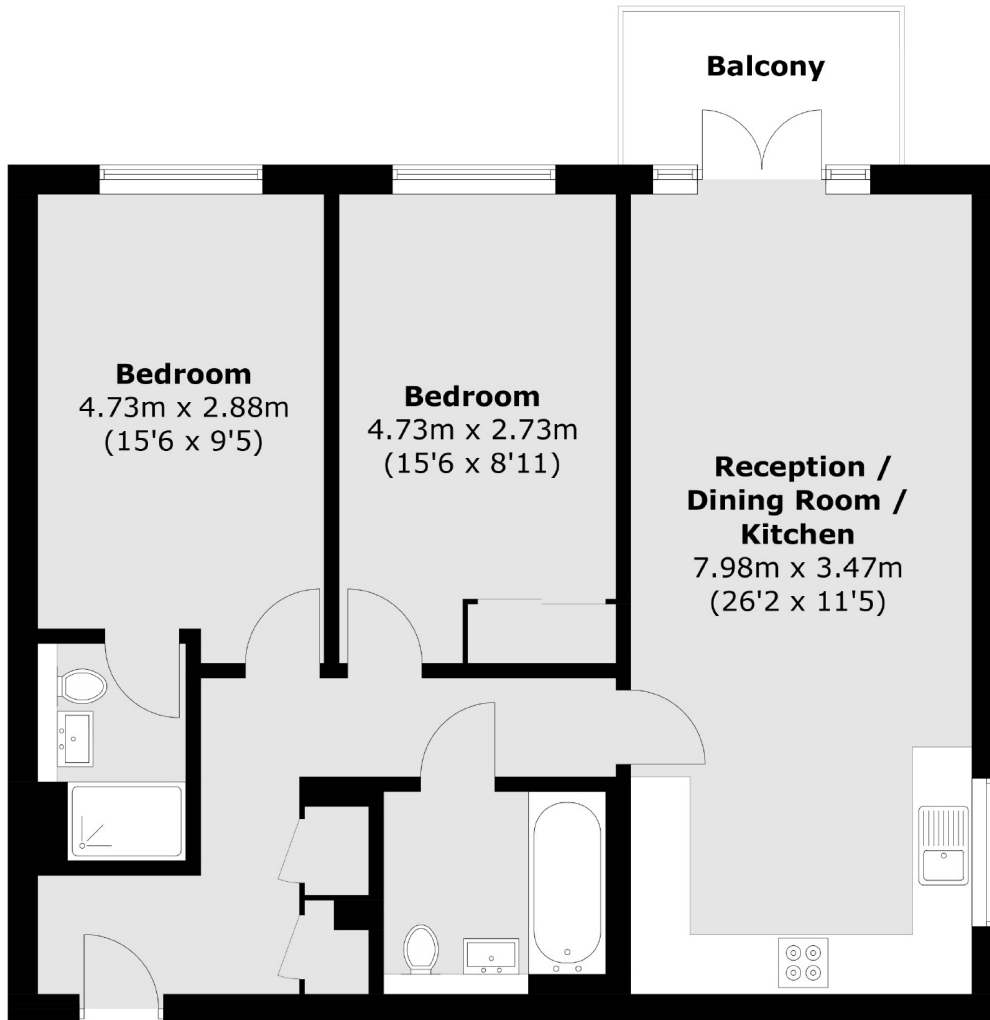

Total area (approx.): 76.9 sq. m (827.7 sq. ft)
Balcony Area: 4.3 sq. m (46.2 sq. ft)

Snellers Hampton Hill Lettings
197-201 High Street
Hampton Hill
TW12 1NL
020 8783 3633
hamptonlettings@snellers.co.uk

Energy Rating: B We aim to make our particulars both accurate and reliable. However they are not guaranteed; nor do they form part of an offer or contract. If you require clarification on any points then please contact us, especially if you're traveling some distance to view. Please note that appliances and heating systems have not been tested and therefore no warranties can be given as to their good working order