

FLETCHERS

ESTATE AGENTS



Southfield Road, W4

£370,000

A charming one bedroom Victorian garden flat with high ceilings, separate eat in kitchen, long lease and access to a well kept shared South facing garden.

A convenient location with immediate access to the local E3 bus route and with Turnham Green, Chiswick Park and South Acton tube stations all within walking distance. Chiswick High Road offers a wonderful selection of shops, bars, cafés and restaurants.

- Victorian Conversion • One Bedroom • Reception Room • Eat in Kitchen • Shared Garden • Built in Storage •

FLETCHERS

ESTATE AGENTS

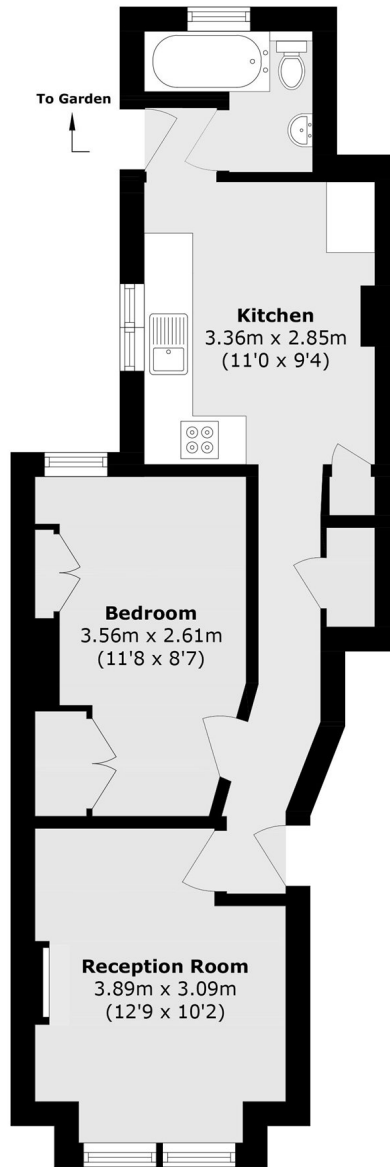

Total (approx.): 42.0 sq. m (452.0 sq. ft)

Fletchers Chiswick Turnham Green Sales
58 Turnham Green Terrace, London, W4 1QP
020 8987 3000
chiswicksales@fletcherestates.com

Energy Rating: D. We aim to make our particulars both accurate and reliable. However they are not guaranteed; nor do they form part of an offer or contract. If you require clarification on any points then please contact us, especially if you're traveling some distance to view. Please note that appliances and heating systems have not been tested and therefore no warranties can be given as to their good working order.