



## 48 Coniston Drive Balby, Doncaster, DN4 9GA Offers Around £180,000

Occupying an enviable cul de sac position on a sought after roadway is this charming end townhouse offering a perfect blend of modern living and comfort. The property boasts three well-proportioned bedrooms, making it an ideal home for families or those seeking extra space.

Upon entering, you are welcomed into a spacious reception room that provides a warm and inviting atmosphere, perfect for both relaxation and entertaining. The recently fitted contemporary shower room adds a touch of luxury, ensuring that your daily routines are both stylish and convenient.

The exterior of the home is equally appealing, with a driveway along with a garage for additional storage or parking needs.

With NO ONWARD CHAIN, this property is ready for you to move in and make it your own. Whether you are a first-time buyer or looking to downsize, this townhouse presents an excellent opportunity to secure a lovely home in a desirable area. Early viewing is highly recommended.

- End townhouse
- Three bedrooms
- Spacious lounge/dining room
- Recently fitted contemporary shower room
- Master suite with dressing area and en suite shower room
- Driveway and garage
- Quiet cul de sac location
- Close to local amenities and transport links
- No onward chain
- Early viewing is highly recommended

### Viewing

Please contact our Office on 01302 751616 if you wish to arrange a viewing appointment for this property or require further information.



# Floor Plan

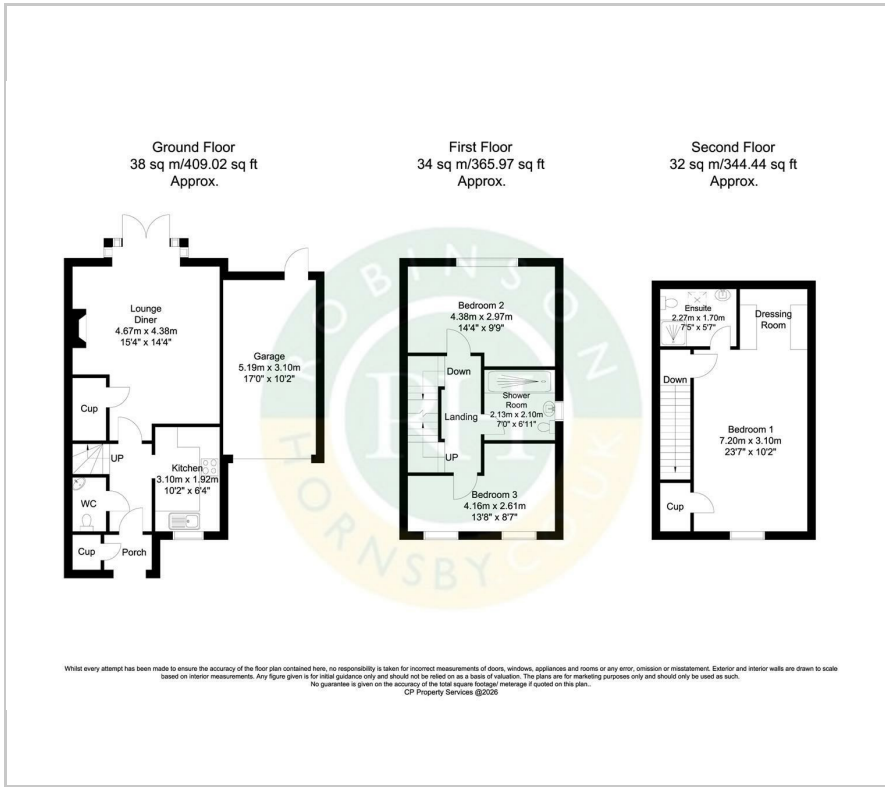

# Area Map



# Energy Efficiency Graph



These particulars, whilst believed to be accurate are set out as a general outline only for guidance and do not constitute any part of an offer or contract. Intending purchasers should not rely on them as statements of representation of fact, but must satisfy themselves by inspection or otherwise as to their accuracy. No person in this firm's employment has the authority to make or give any representation or warranty in respect of the property.