



Bibury Close, Witney, OX28 5GB

Welcome to Bibury Close, Witney

Welcome to this delightful two-bedroom house located in the heart of Witney, perfect for first-time buyers or small families seeking a comfortable and inviting home offered with no onward chain.

As you enter, you are greeted by a spacious and light-filled living area, ideal for both relaxation and entertaining guests. The separate kitchen offers ample space for meal preparation and dining, complete with appliances and plenty of storage.

The property features two well-proportioned bedrooms, providing comfortable accommodation. The family bathroom is well appointed, ensuring a relaxing space for daily routines.

Step outside to discover your own private garden, a perfect retreat for outdoor relaxation. This space offers potential for al fresco dining and is a lovely area for children to play.

Located just a short distance from local amenities, schools, and parks, this house offers the ideal blend of tranquillity and convenience. Don't miss out on the opportunity to make this charming property your new home!



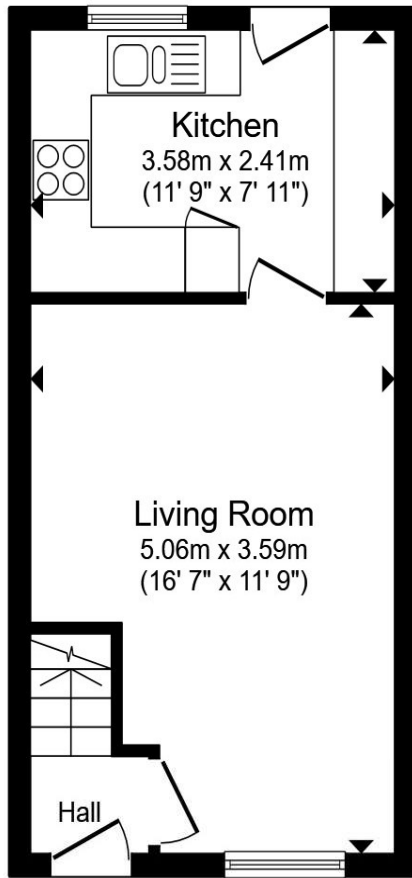

Ground Floor

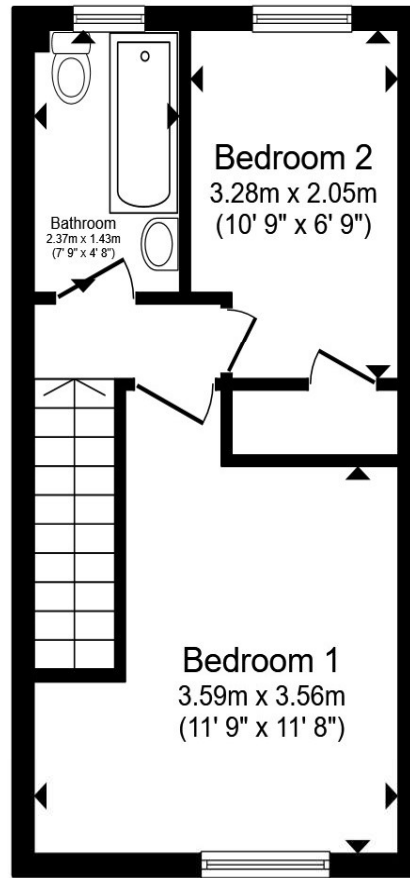

First Floor

Total floor area 54.4 m² (585 sq.ft.) approx

This floor plan is for illustrative purposes only. It is not drawn to scale. Any measurements, floor areas (including any total floor area), openings and orientation are approximate. No details are guaranteed, they cannot be relied upon for any purpose and they do not form part of any agreement. No liability is taken for any error, omission or misstatement. A party must rely upon its own inspection(s). Powered by www.propertybox.io

Welcome to

Bibury Close, Witney

- Two-bedroom end-terrace home
- Spacious living room
- Separate fitted kitchen
- First-floor family bathroom
- Well-proportioned main bedroom

Tenure: Freehold EPC Rating: C
Council Tax Band: C

offers in excess of

£300,000

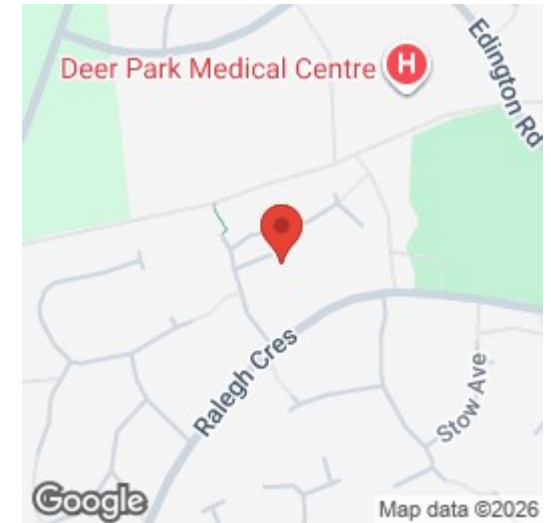

view this property online [allenandharris.co.uk/Property/WIT106244](https://www.allenandharris.co.uk/Property/WIT106244)



Property Ref:
WIT106244 - 0010

1. MONEY LAUNDERING REGULATIONS Intending purchasers will be asked to produce identification documentation at a later stage and we would ask for your co-operation in order that there is no delay in agreeing the sale. 2. These particulars do not constitute part or all of an offer or contract. 3. The measurements indicated are supplied for guidance only and as such must be considered incorrect. Potential buyers are advised to recheck measurements before committing to any expense. 4. We have not tested any apparatus, equipment, fixtures or services and it is in the buyers interest to check the working condition of any appliances. 5. Where an EPC, or a Home Report (Scotland only) is held for this property, it is available for inspection at the branch by appointment. If you require a printed version of a Home Report, you will need to pay a reasonable production charge reflecting printing and other costs. 6. We are not able to offer an opinion either written or verbal on the content of these reports and this must be obtained from your legal representative. 7. Whilst we take care in preparing these reports, a buyer should ensure that his/her legal representative confirms as soon as possible all matters relating to title including the extent and boundaries of the property and other important matters before exchange of contracts.

Allen & Harris is a trading name of Sequence (UK) Limited which is registered in England and Wales under company number 4268443, Registered Office is Cumbria House, 16-20 Hockliffe Street, Leighton Buzzard, Bedfordshire, LU7 1GN. VAT Registration Number is 500 2481 05.

Please note the marker reflects the
postcode not the actual property

allen & harris



01993 705915



witney@allenandharris.co.uk



54 Market Square, WITNEY, Oxfordshire, OX28
6AF



allenandharris.co.uk