



Corbins Lane, HA2

£225,000

This one bedroom flat firstly benefits a lift and entryphone system. With an open plan reception/kitchen which has a dual full height window and glazed door opening onto the balcony. Completing the flat is the kitchen, double bedroom and a family bathroom.

Clearview Court is ideally located in the centre of South Harrow, just a couple of minutes to Aldi Supermarket, local shops, restaurants and transport links, South Harrow Piccadilly Line Station is within 500 meters.

- One Double Bedroom • Open Plan Reception/Kitchen • Balcony •
- Lift • Entryphone System • Great Location •

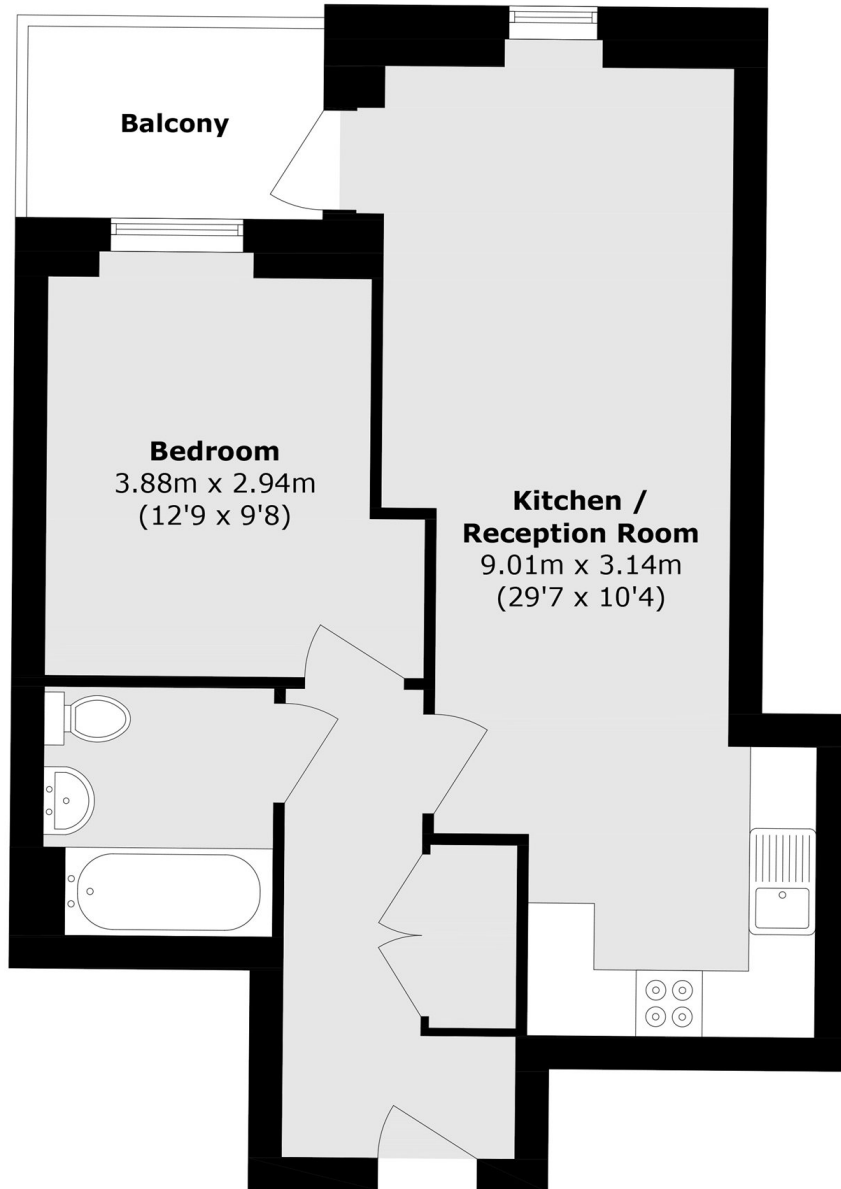

Total area (approx.): 52.9 sq. m (569.4 sq. ft)
Balcony area (approx.): 5.1 sq. m (54.8 sq. ft)

David Conway
020 8422 5222

Energy Rating: We aim to make our particulars both accurate and reliable. However they are not guaranteed; nor do they form part of an offer or contract. If you require clarification on any points then please contact us, especially if you're travelling some distance to view. Please note that appliances and heating systems have not been tested and therefore no warranties can be given as to their good working order.