



## Stanley Road, HA2

**£255,000**

A two double bedroom flat in a modern lift-serviced development in central South Harrow, featuring an open-plan lounge/diner with a fitted kitchen and access to a balcony, plus a family bathroom.

Bridge Court is on Stanley Road off Northolt Road, just 420 yards from South Harrow Piccadilly Line and bus station, close to shops, cafés and restaurants as well as Grange Primary and Whitmore High just over 600 yards away.

- Two Bedrooms • Open Plan Living • Balcony •
- Lift Access • Entry Phone System • Central Location •

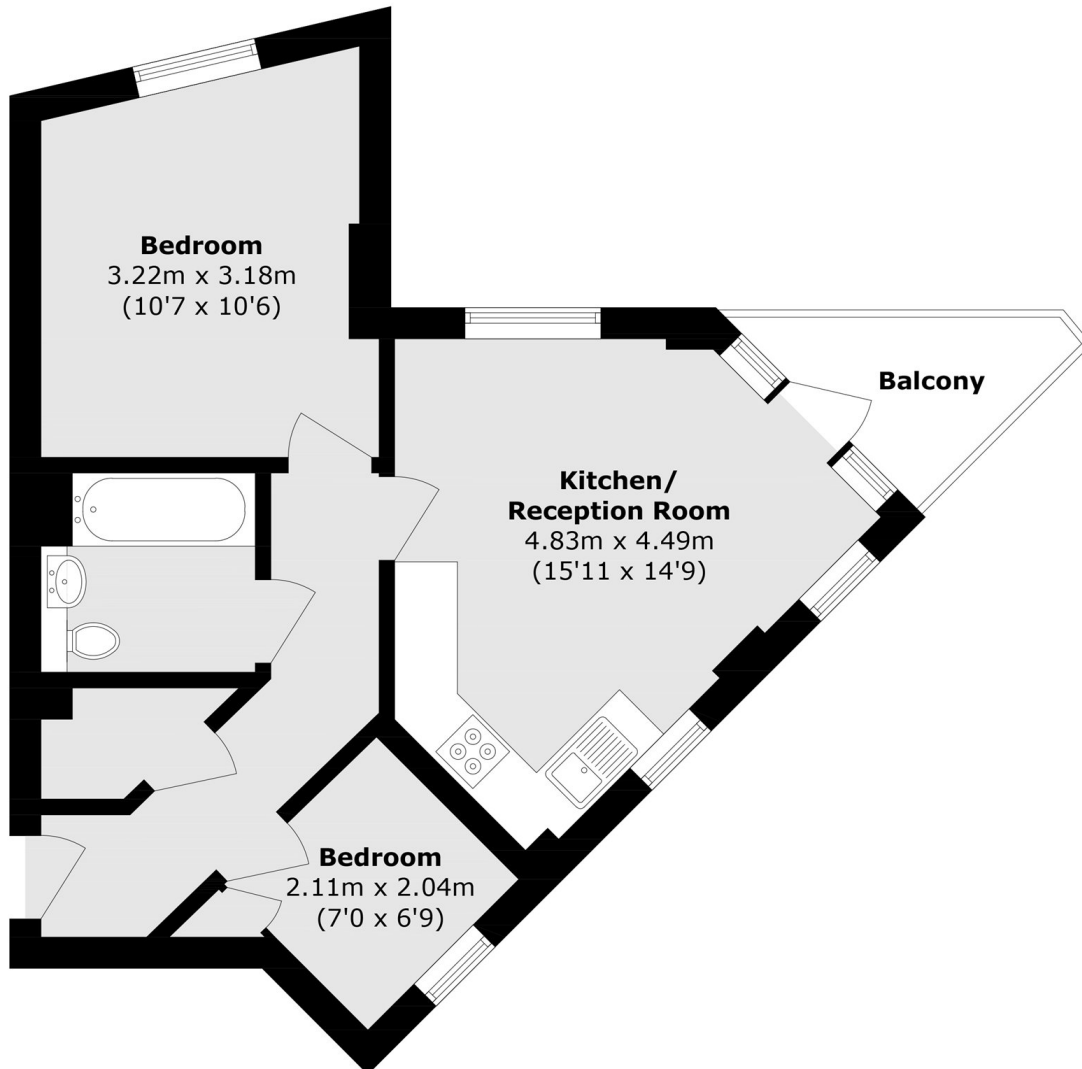

Total area (approx.): 44.7 sq. m (481.1 sq. ft)

Balcony (approx.): 3.3 sq. m (35.5 sq. ft)

David Conway  
020 8422 5222

Energy Rating: B We aim to make our particulars both accurate and reliable. However they are not guaranteed; nor do they form part of an offer or contract. If you require clarification on any points then please contact us, especially if you're travelling some distance to view. Please note that appliances and heating systems have not been tested and therefore no warranties can be given as to their good working order.