



**Parsonage Gardens, Enfield, EN2 6JR**

**welcome to**

## **Parsonage Gardens, Enfield**

Barnfields are delighted to offer for sale this spacious and extended, three bedroom mid terraced family house in a picturesque location with views over the New River and within a short walk of Enfield Town with its multiple shopping centre, Town Park and both Enfield Chase (Moorgate Line) and Enfield Town (Liverpool Street Line) Stations.

The property is offered on a chain free basis and must be viewed to be fully appreciated!



### **Elegant Hallway**

With double doors, wood flooring, radiator, understairs cupboard.

### **Front Reception Room**

14' 10" x 12' 7" ( 4.52m x 3.84m )

Wood flooring, double glazed windows to front, radiator, stone fireplace and hearth with inset electric fire.

### **Downstairs WC**

Low level WC, tiled floor, wall mounted hand basin.

### **Rear Reception Room**

13' 11" x 13' ( 4.24m x 3.96m )

Wood flooring, original built-in corner cupboard, tiled fireplace and hearth, picture rails, two large original cupboards, double glazed windows and French doors to garden.

### **Kitchen**

10' 8" x 8' 7" ( 3.25m x 2.62m )

Range of fitted wall and base units with toning worktops, sink and drainer, gas hob with extractor above and oven beneath, built-in dishwasher and washing machine, space for a fridge/freezer, double glazed window to side and rear, tiled floor, double glazed door to garden.

### **First Floor**

#### **Landing**

Fitted carpet, loft hatch opening to loft storage space, picture rails.

### **Bedroom One**

14' 10" x 10' 7" ( 4.52m x 3.23m )

Laminate flooring, double glazed windows to front with views over the New River, radiator, built-in wardrobes.

### **Bedroom Two**

11' 9" x 11' 2" ( 3.58m x 3.40m )

Laminate flooring, double glazed windows to rear, picture rails, built-in wardrobes.

### **Bedroom Three**

11' 7" x 6' 4" ( 3.53m x 1.93m )

Laminate flooring, double glazed windows to front with views over the New River, radiator.

### **Shower Room**

Step in shower unit, WC with concealed cistern, sink with range of built-in cupboards and drawers, double glazed window to rear, tiled floor, tiled walls.

### **Outside**

#### **Rear Garden**

An approx. 50ft South Westerly Facing rear garden with patio to front and mature shrub borders, rear access gate.

#### **Garage**

Brick built garage with windows and up and over door accessed via rear access road.

#### **Off-Street Parking**

Off-street parking to the front of the property for one car.



**view this property online** [barnfields.co.uk/Property/ENF104658](http://barnfields.co.uk/Property/ENF104658)







welcome to

## Parsonage Gardens, Enfield

- Two Reception Rooms
- Extended Modern Fitted Kitchen
- Downstairs WC
- Three Bedrooms And First Floor Shower Room
- Close To Stations And Shopping Centre

Tenure: Freehold EPC Rating: C

Council Tax Band: E

# £700,000



Please note the marker reflects the postcode not the actual property

check out more properties at [barnfields.co.uk](https://www.barnfields.co.uk)



Property Ref:  
ENF104658 - 0003

1. MONEY LAUNDERING REGULATIONS Intending purchasers will be asked to produce identification documentation at a later stage and we would ask for your co-operation in order that there is no delay in agreeing the sale. 2. These particulars do not constitute part or all of an offer or contract. 3. The measurements indicated are supplied for guidance only and as such must be considered incorrect. Potential buyers are advised to recheck measurements before committing to any expense. 4. We have not tested any apparatus, equipment, fixtures or services and it is in the buyers interest to check the working condition of any appliances. 5. Where an EPC, or a Home Report (Scotland only) is held for this property, it is available for inspection at the branch by appointment. If you require a printed version of a Home Report, you will need to pay a reasonable production charge reflecting printing and other costs. 6. We are not able to offer an opinion either written or verbal on the content of these reports and this must be obtained from your legal representative. 7. Whilst we take care in preparing these reports, a buyer should ensure that his/her legal representative confirms as soon as possible all matters relating to title including the extent and boundaries of the property and other important matters before exchange of contracts.

Barnfields is a trading name of Sequence (UK) Limited which is registered in England and Wales under company number 4268443, Registered Office is Cumbria House, 16-20 Hockliffe Street, Leighton Buzzard, Bedfordshire, LU7 1GN. VAT Registration Number is 500 2481 05.

## Parsonage Gardens, Enfield, EN2

Approximate Area = 1150 sq ft / 106.8 sq m  
Garage = 135 sq ft / 12.5 sq m  
Total = 1285 sq ft / 119.3 sq m  
For identification only - Not to scale

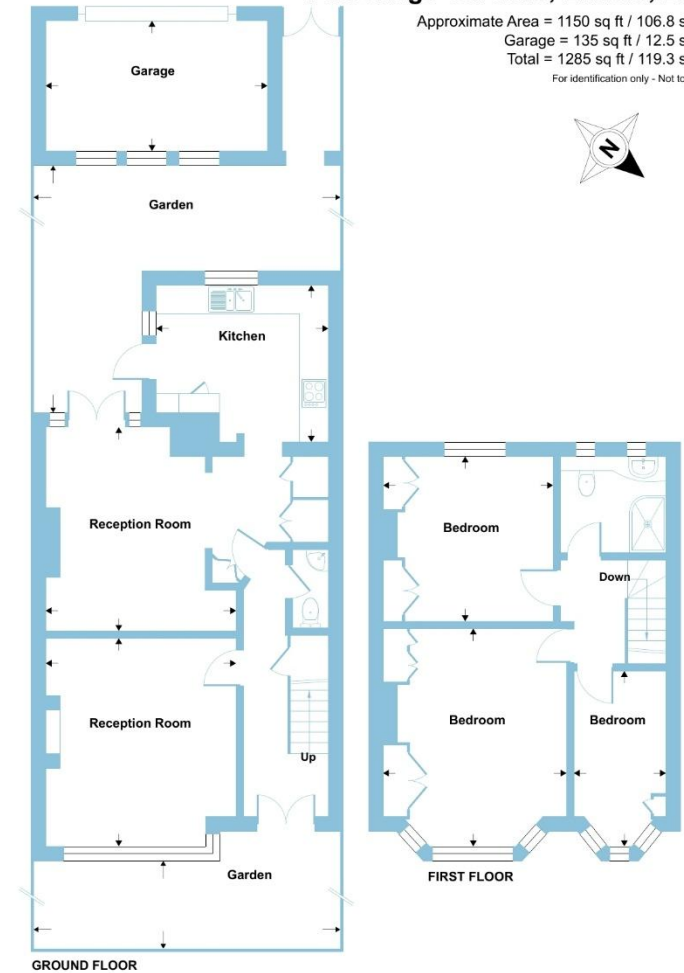

Floor plan produced in accordance with RICS Property Measurement 2nd Edition, incorporating International Property Measurement Standards (IPMS2 Residential). © richcom 2025. Produced for Barnard Marcus. REF: 1418938



020 8363 3394



info@barnfields.com



1a Windmill Hill, Enfield, Middlesex, EN2 6SE



[barnfields.co.uk](https://www.barnfields.co.uk)