



The Meeting House, 9 Meetinghouse Lane

Sheffield, S13 7PJ

Entrance Porch/Utility Room

With side facing windows, room and plumbing for a washing machine, room for a tumble dryer, roll-top work surface, entrance door, wall mounted boiler and access through to the open plan Kitchen/Diner.

Kitchen/Diner

19'2" x 10'5"

Kitchen/Diner: 5.86m (19' 3") x 3.18m (10' 5") max. A stunning traditional oak fitted kitchen with built in dish washer, a full bowl and drainer sink with mixer taps. The kitchen also has a oven and 5 ring gas hob with over-head extractor fan and light, the kitchen is finished off with a slate tile splash back and tile effect floor. There is a tall front facing double glazed solid hardwood frames with subtle spot lighting and heating provided by wall mounted radiator.

Sitting Room

18'10" x 12'3"

An impressive room beautifully decorated with a feature chimney breast, and coal effect electric fire set within a solid limestone fireplace. The room is carpeted with traditional style radiators and bespoke arched double glazed solid hardwood front facing windows with double doors towards the back of the room which lead to the conservatory.

Conservatory

12'9" x 12'1"

With tiled underfloor heating and double doors leading to the outside.

Ground Floor W.C

With white suite vanity wash basin and WC.

Inner Hallway

With built in storage cupboards underneath the stairs. Stairs rise to the first floor landing.

First Floor Landing

With side facing solid double glazed hardwood frame and access into three bedrooms and the family bathroom. Further ample built-in storage cupboards.



- Four double bedrooms including a fabulous master suite on the 2nd floor that commands fine, far reaching views.
- Conservatory with under floor heating making it useable throughout the year.
- Inner hallway with access to a ground floor W.C.

- Modern breakfast kitchen with integrated appliances and contemporary downlighters.
- Two bathrooms including a superb family bathroom with oversized bath inset to Travertine tiling.
- Block paved off road parking for two cars leading to gates protecting an additional parking area.

- Large living room with gorgeous arched windows featuring stone mullions.
- Welcoming entrance lobby/utility area with plumbing for the usual appliances.
- Pretty garden to the rear with Belfast sink for washing and a large timber shed/workshop with power for bike and garden tool storage.



Bedroom 2

12'10" x 8'6"

Double bedroom with 3 front facing single and solid double glazed hardwood frames this room is carpeted with wall mounted radiator.

Bedroom 3

11'9" x 9'2"

Double bedroom with side facing double glazed solid hardwood window frames with wall mounted radiator and carpeted floor.

Bedroom 4

7'11" x 6'5"

A single bedroom with side facing window double glazed solid hardwood window frames with wall mounted radiator and carpeted floor.

Family Bathroom

11'7" x 11'2"

Luxury large bathroom with a modern bath and shower they are both controlled from mixer taps on the bath side. The bath is encased in mosaic style stone and finished with a tiled splash back. You also have a separate fully tiled thermostatic shower cubical. The bathroom benefits from built in cupboard units and two single sinks, both with individual mixer taps. The room has double glazed solid hardwood window frames with tile effect flooring and spot lighting.

Second Floor Landing

With built in storage cupboard and access through to the Master Bedroom and Shower Room. There is also a Velux style window above the stairs.

Shower Room

This luxury shower room has a shower cubicle with overhead thermostatic rain shower, low flush W/C, mixer tap controlled sink with a tiled splash back. The Velux style window faces to the side of the house.

Master Bedroom

17'9" x 10'9"

This spectacular room really is the icing on the cake and enjoys triple aspect views from the array of windows. Far reaching views can be enjoyed from the side of the property and there is a bespoke built in wardrobe. The arched window is a beautiful feature and looks onto the willow tree. All windows are double glazed solid hardwood window frames and there is a traditional style radiator and carpeted floor. There is also the benefit of extra storage with the eaves. This really is a fabulous space.







GROUND FLOOR

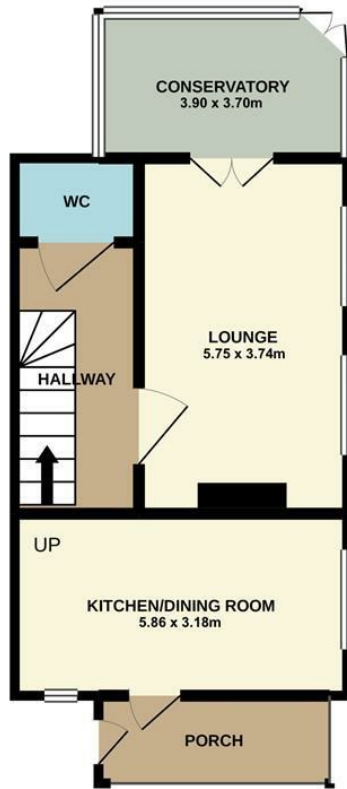

1ST FLOOR

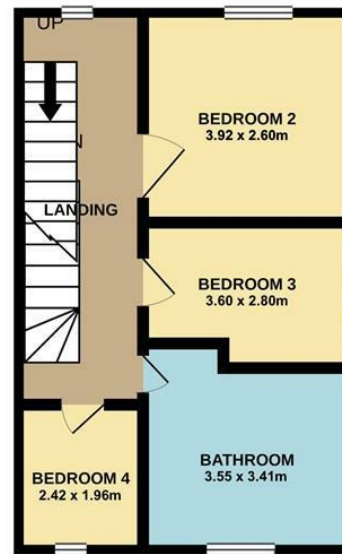

2ND FLOOR



Whilst every attempt has been made to ensure the accuracy of the floorplan contained here, measurements of doors, windows, rooms and any other items are approximate and no responsibility is taken for any error, omission or mis-statement. This plan is for illustrative purposes only and should be used as such by any prospective purchaser. The services, systems and appliances shown have not been tested and no guarantee as to their operability or efficiency can be given.
Made with Metropix ©2021

Whilst every effort has been made to ensure the accuracy of the floorplan this plan is for reference only to location of rooms and property layout for detailed measurements please refer to the brochure or advice from the marketing Agent. UK Energy Assessors Ltd accept no responsibility for measurements and Gross areas of a property they have not visited. Plan produced using PlanUp.



Bakewell
 3 Royal Oak Place
 Matlock Street
 Bakewell DE45 1HD
 T: 01629 700699
 E: bakewell@elr.co.uk

Banner Cross
 888 Ecclesall Road
 Banner Cross
 Sheffield S11 8TP
 T: 01142 683388
 E: bannercross@elr.co.uk

Dore
 33 Townhead Road
 Sheffield
 S17 3GD
 T: 0114 2362420
 E: dore@elr.co.uk

Hathersage
 Main Road, Hathersage
 Hope Valley
 Derbyshire S32 1BB
 T: 01433 651888
 E: peakdistrict@elr.co.uk

Rotherham
 149 Bawtry Road
 Wickersley
 Rotherham S66 2BW
 T: 01709 917676
 E: wickersley@elr.co.uk

**EADON
 LOCKWOOD
 & RIDDLE**
 ESTD 1840