



St. Gabriels Road, NW2

TO LET - £1,798 Per Month

TO LET Set on the Second Floor of this attractive period building, we are pleased to offer this meticulously refurbished one bedroom flat, spanning 590 sq ft of living space and located in the popular Mapesbury Conversation Area.

The property has undergone full refurbishment within the last two years to include a large open plan kitchen/ reception room with a contemporary design, integrated appliances, and a lovely breakfast bar, a modern shower room and a double bedroom with access to large storage space.

Other benefits include a newly extended lease and access to the eaves storage. St. Gabriels Road is located within easy reach of both Willesden Green and Kilburn with a wide array of local delis, independent eateries and the open space of Gladstone Park.



- 1 bedroom, reception/kitchen & shower room
- Modern Second Floor Flat 590 Sq ft
- Close to Mapesbury Dell & Gladstone Park
- Transport: Willesden Green (Jubilee) Station
- COUNCIL: BRENT (B) Deposit: £2074

020 8450 9377

rentals@cameronsstiff.co.uk

cameronsstiff.co.uk

St. Gabriels Road, London, NW2

Approximate Area = 570 sq ft / 52.9 sq m

Limited Use Area(s) = 201 sq ft / 18.6 sq m

Total = 771 sq ft / 71.6 sq m

For identification only - Not to scale

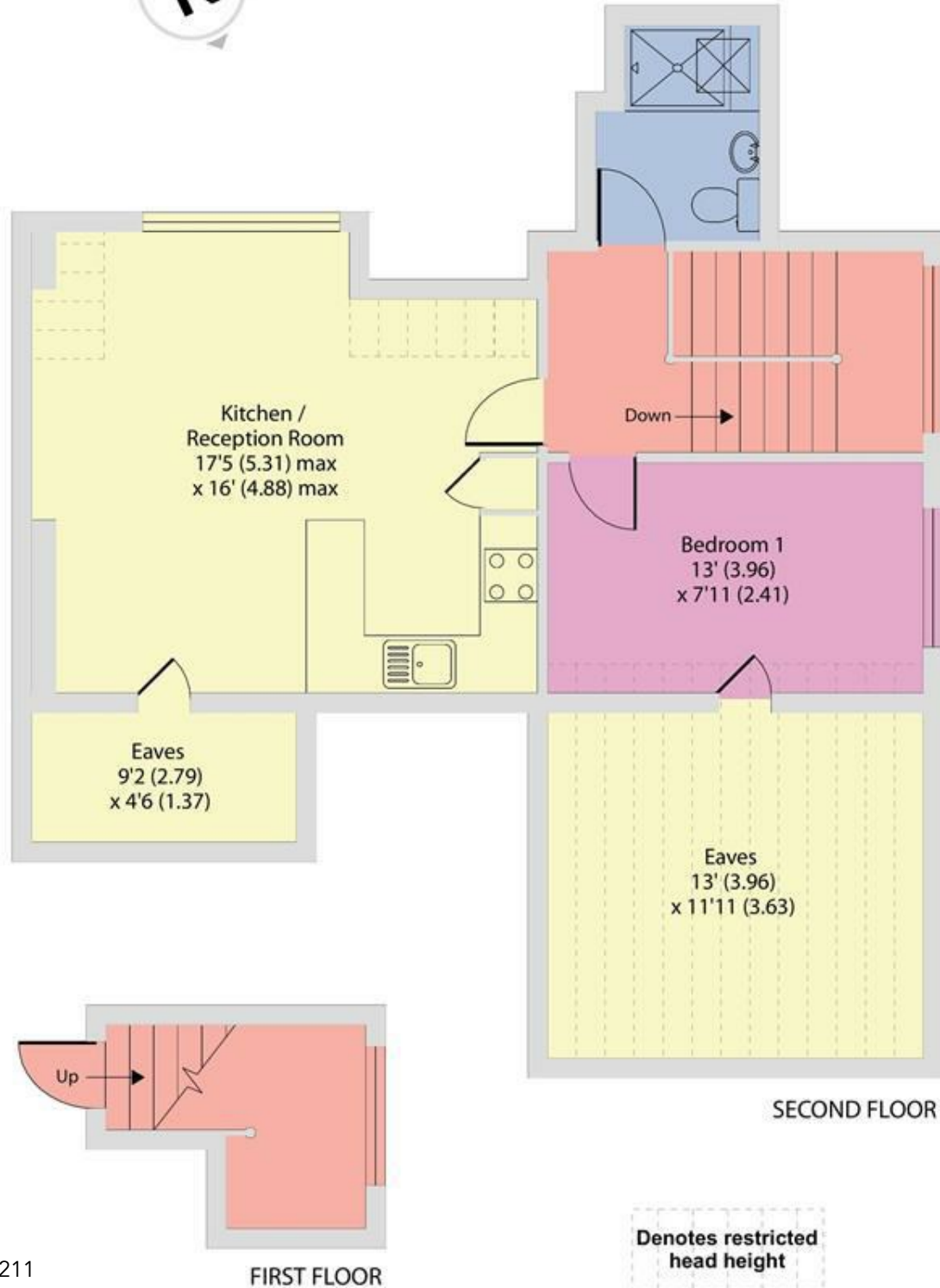

EPC: E

Ref: 18195211

