

# SNELLERS

ESTATE AGENTS



**Springfield Road, KT1**

**£1,895 PCM**

This ground floor apartment is neutrally decorated throughout and has a bright reception room, large master bedroom, smaller second bedroom, modern kitchen and gated parking.



This ground floor apartment is neutrally decorated throughout and has a bright reception room, large master bedroom, smaller second bedroom, modern kitchen and gated parking.

Ideally located between Kingston and Surbiton Town Centres, Springfield Road allows easy access to everything you could need, and all within walking distance.

- Two Bedrooms • Large Reception Room • Gated Parking •
- Modern Kitchen • Family Bathroom • Neutrally Decorated •



# SNELLERS

ESTATE AGENTS

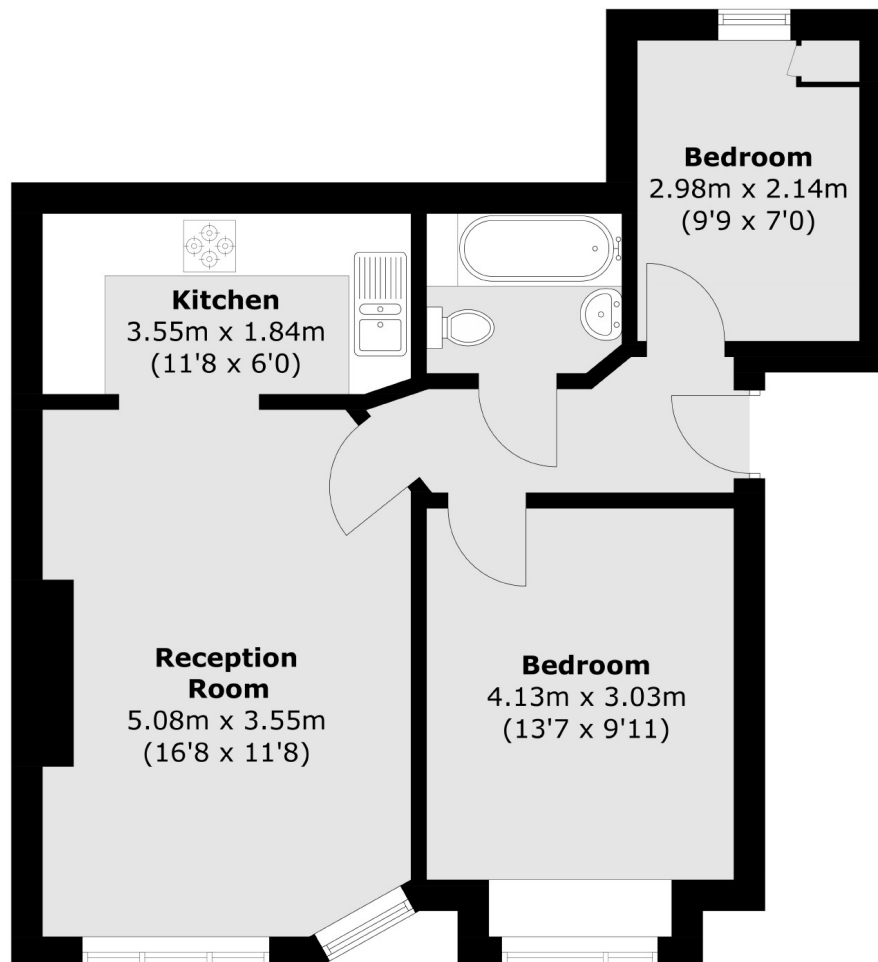

Total area (approx.): 50.6 sq. m (544.6 sq. ft)

Snellers Kingston Lettings  
17-21 Richmond Road  
Kingston  
KT2 5BW  
020 8546 0505  
[kingstonlettings@snellers.co.uk](mailto:kingstonlettings@snellers.co.uk)

Energy Rating: We aim to make our particulars both accurate and reliable. However they are not guaranteed; nor do they form part of an offer or contract. If you require clarification on any points then please contact us, especially if you're traveling some distance to view. Please note that appliances and heating systems have not been tested and therefore no warranties can be given as to their good working order