

Gatehouse Rise, Dawlish, EX7 0EH



A deceptively spacious and extended 4 bedroom semi-detached house situated in a popular location with the benefit of front and rear gardens, 2 bathrooms and a garage. freehold, council tax band - C, EPC - D.

OIEO £240,000

01626 862379

www.fraserandwheeler.co.uk

FRASER & WHEELER

FRONT DOOR TO:

FAMILY ROOM

Window to the front and side of the property, electric wall heater and double doors to:

SECOND KITCHEN/UTILITY ROOM

Window to the side, base and eye level units, stainless steel sink unit, space for a cooker and appliance. Door to:

GROUND FLOOR BATHROOM

Suite comprising panelled bath, WC and wash hand basin and part tiled walls.

BEDROOM 4

Window and door leading to the rear garden and electric wall heater.

SITTING ROOM

A spacious room with tiled floor, window to the front, stairs leading to the first floor, fire place surround and door to:

KITCHEN/DINING ROOM

Base and eye level units, stainless steel sink with drainer, cooker point, plumbing for a washing machine, wall mounted gas boiler, 2 windows and door leading to the rear garden.

FIRST FLOOR LANDING

Doors to:

BEDROOM 1

Window to the front of the property with open aspect.

BEDROOM 2

Window to the rear and radiator.

BEDROOM 3

Window to the front of the property.

BATHROOM

Suite comprising panelled bath, pedestal wash hand basin, WC, tiled walls and window to the rear.

OUTSIDE

To the front and side of the property is a good size corner plot garden mainly laid to lawn with established shrubs whilst to the rear is an enclosed garden with paving and decorative gravel for ease of maintenance. Accessed via the rear of the property is also a SINGLE GARAGE.

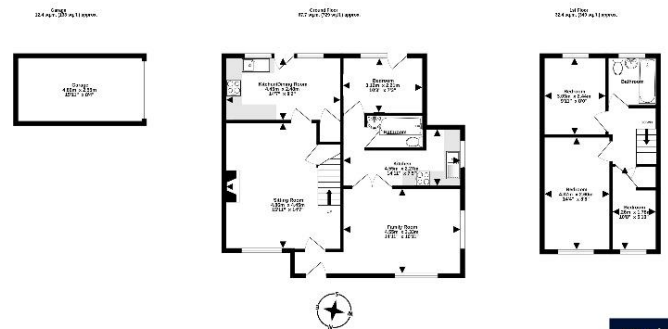

TOTAL FLOOR AREA: 112.5 sq.m. (1211 sq.ft.) approx.
All the areas shown on this floor plan are approximate and are not intended to be used as a basis for any legal proceedings. The plan is for general information only and does not constitute a contract. It is not intended to be used as a basis for any legal proceedings. It is not intended to be used as a basis for any legal proceedings.

FRASER
WHEELER

19 Queen Street, Dawlish, Devon, EX7 9HB
Telephone: 01 626 862379
Email: info@fraserandwheeler.co.uk
www.fraserandwheeler.co.uk



Fraser & Wheeler has not tested any apparatus, equipment fixtures and fittings or any services and cannot verify that they are in working order or fit for purpose. Prospective purchasers are advised to obtain their own independent reports from relevant professionals such as a surveyor or solicitor. Fraser & Wheeler advises buyers to make their own enquiries as to the tenure. All measurements and room descriptions are for general guide purposes only and buyers should verify information provided before purchasing furniture, fittings, carpets or appliances.