



Helmsdale Close, Hayes, UB4 9QS  
£160,000







Helmsdale Close, Hayes, UB4 9QS

**£160,000**

- Allocated Parking
- Purpose Built Studio Flat
- Security Entryphone
- Living/Bedroom
- Chain Free
- Excellent Investment Opportunity
- Entrance Lobby
- Kitchen

## Description

This property is not only a perfect starter home but also a canvas for personalisation. The property features a versatile reception room that also serve as a bedroom, providing flexibility to suit your lifestyle needs, the well-appointed bathroom offers modern amenities, ensuring convenience and comfort. The fitted kitchen is designed for practicality, making it an ideal space for preparing meals and entertaining guests.

## Situation

Helmsdale Close within a sought after residential development. This popular residential area is close to Tesco Superstore, Starbucks and the admired Yeading Marina. Transport links on the doorstep for the A40/London, Northolt, Ealing, Heathrow airport, Uxbridge & Hayes Town (Hayes & Harlington station with the Elizabeth Line). Also within easy reach the M4/M25 Motorways. A number of highly regarded schools in the local area including Barnhill Community High School and Lady Margert primary school.





Floor Plans

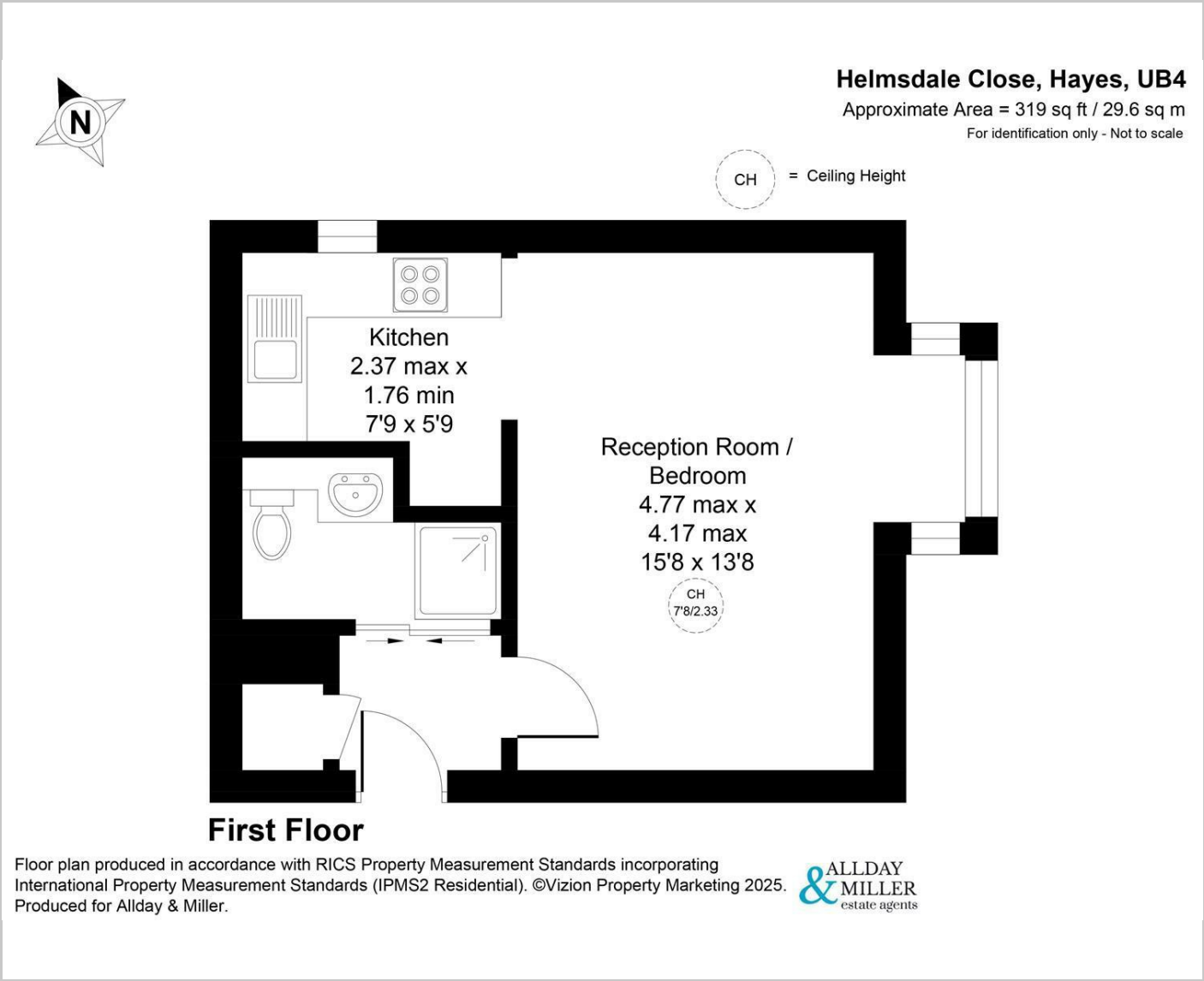

Area Map



Energy Performance Graph

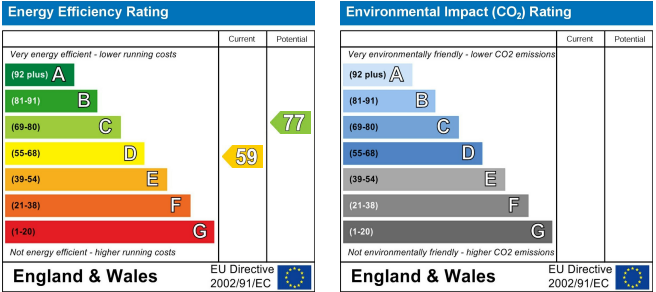

These particulars, whilst believed to be accurate are set out as a general outline only for guidance and do not constitute any part of an offer or contract. Intending purchasers should not rely on them as statements of representation of fact, but must satisfy themselves by inspection or otherwise as to their accuracy. No person in this firms employment has the authority to make or give any representation or warranty in respect of the property.