

ALLDAY  
& MILLER

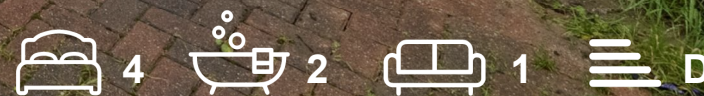

Richmond Avenue, Uxbridge, UB10 9BQ  
£525,000







Richmond Avenue, Uxbridge, UB10 9BQ

**£525,000**

- Four Bedrooms
- Extended
- Driveway Parking
- Good Size Rear Garden
- Within Easy Reach of The A40
- Hillingdon Oak Farm
- Within Easy Reach Of Well Regarded Schools
- Walking Distance To Hillingdon Station
- Two Bathrooms
- Loft Room



## Description

This spacious property brought to the market comprises of an inviting entrance porch, reception room, fitted kitchen/dining room with patio doors giving access to the rear garden.

The first floor features three bedrooms and a family bathroom.

Rising to the second floor enjoys a double bedroom and en suite.

A paved front driveway creating space for off street parking. To the rear is a private garden mainly laid to lawn with a decking area, perfect for outside dining and entertainment.

## Situation

Richmond Avenue is a sought after residential road within the Oak Farm development just off Long Lane, offering easy access to a number of highly regarded local schools including Oak Farm, Ryefield and St Bernadettes. Hillingdon station just a short drive away with the Metropolitan and Piccadilly line giving easy links into central London. For the commuters the A40/M25 & M40 are close by with its easy access into London and the Home Counties. Uxbridge Town Centre with its vast array of local shops, restaurants, coffee shops, bars, gyms and a cinema is approximately just over a mile away.





## Floor Plans

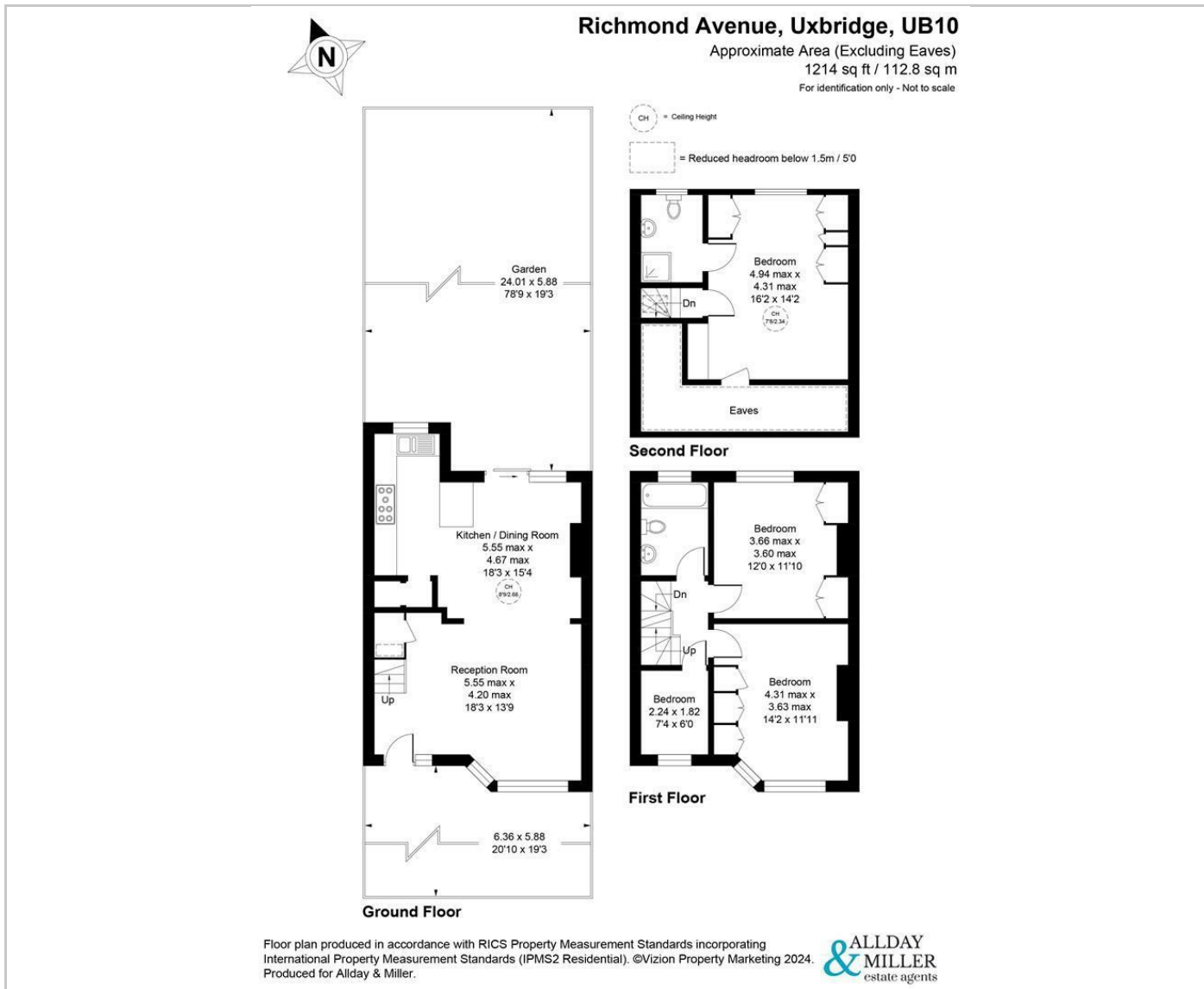

## Area Map

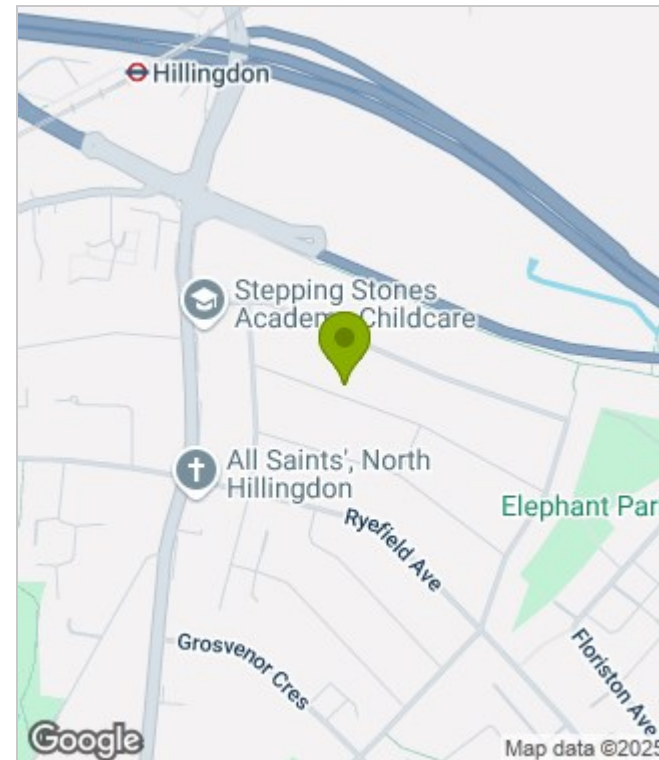

## Energy Performance Graph

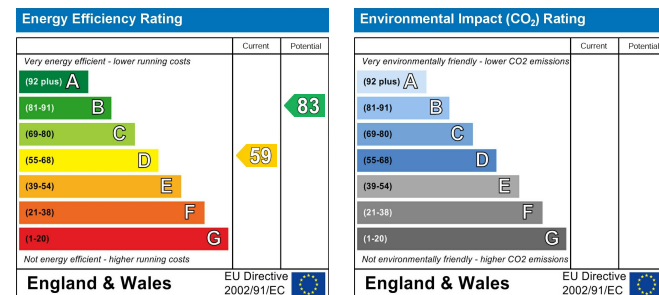

These particulars, whilst believed to be accurate are set out as a general outline only for guidance and do not constitute any part of an offer or contract. Intending purchasers should not rely on them as statements of representation of fact, but must satisfy themselves by inspection or otherwise as to their accuracy. No person in this firm's employment has the authority to make or give any representation or warranty in respect of the property.