



## Chatsworth Road, NW2

Leasehold - £565,000

For Sale is this exceptionally bright & spacious First Floor apartment providing 649 sq ft of luxurious, contemporary style living space in this sought after street within the Mapesbury Conservation Area.

Stylishly designed with a spacious and contemporary style open plan kitchen/reception room creating a stylish entertaining space with a large bay window. Two large double bedrooms both beautifully decorated with fitted wardrobes and a modern three piece bathroom suite complete this home. Attention to detail throughout this lovely home includes the stunning herringbone flooring, high ceilings, elegant lighting and the fully tiled bathroom suite. Close to Jubilee Line - Zone 2 and Brondesbury Park Overground.

- Stylish 2 bedroom apartment offering 649 sq ft
- Situated within Mapesbury Conservation Area
- Contemporary style kitchen/open living area
- Elegant bathroom suite
- Close to Mapesbury Dell, Gladstone Park & Queen's Park
- COUNCIL: Brent (D)

020 8459 1133

[enquiries@cameronsstiff.co.uk](mailto:enquiries@cameronsstiff.co.uk)

[cameronsstiff.co.uk](http://cameronsstiff.co.uk)







## Chatsworth Road, Willesden Green, London, NW2

Approximate Area = 649 sq ft / 60.3 sq m

For identification only - Not to scale

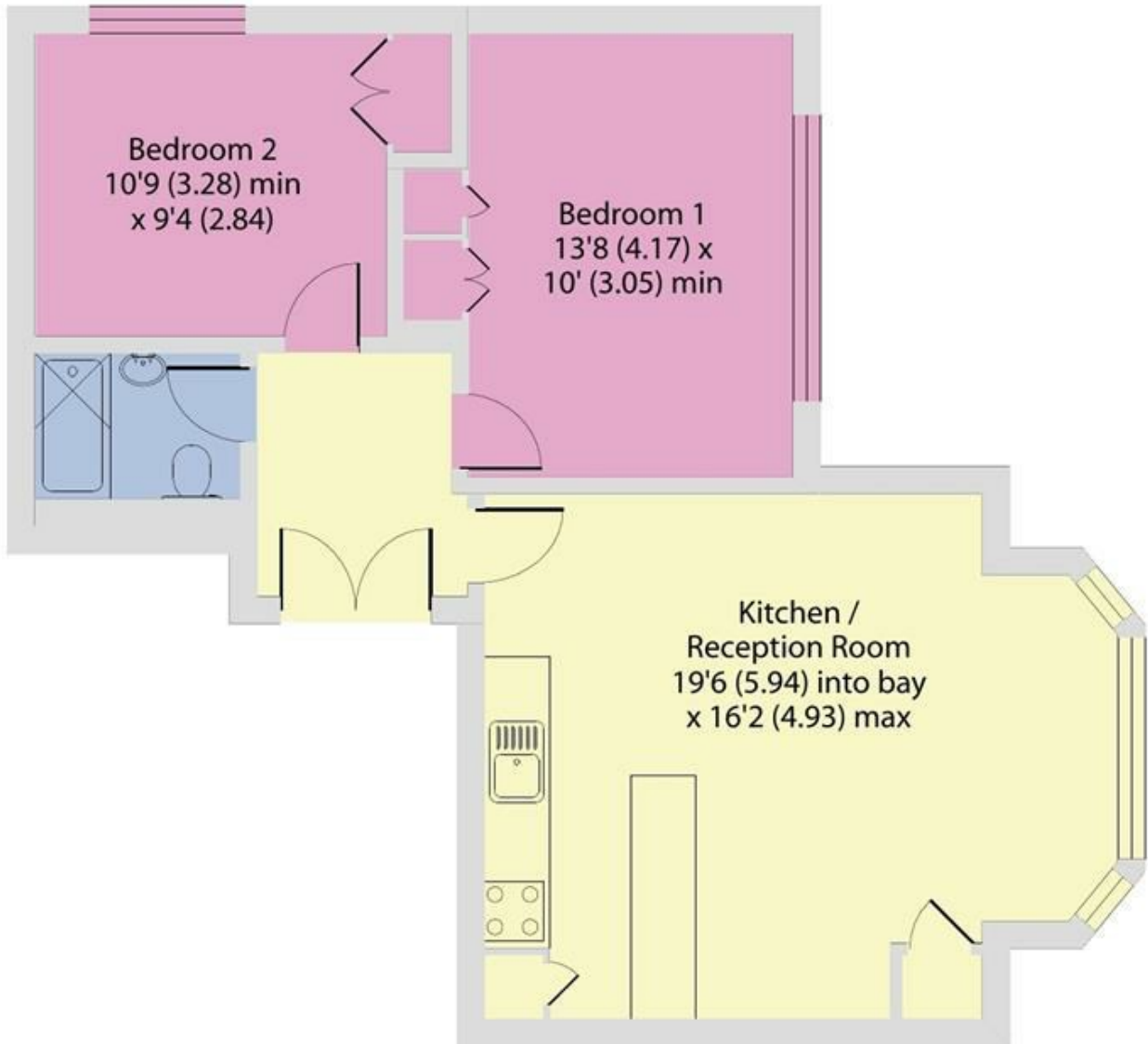

FIRST FLOOR

EPC: C

Ref: 15063453



Floor plan produced in accordance with RICS Property Measurement 2nd Edition, Incorporating International Property Measurement Standards (IPMS2 Residential). © nitchecom 2025. Produced for Camerons Stiff & Co. REF: 158416

