

2 Parliament Mews, Mortlake, SW14 7QP

£4000pcm Fully inclusive of bills

Furnished



VP

- A unique 1st floor apartment with the most fabulous views of the River Thames and Chiswick Bridge
- Two double bedrooms
- Two bathrooms (one en-suite)
- Large reception room with open plan kitchen
- Fantastic built-in storage throughout
- Prestigious riverside development
- Secure gated parking for one car
- Private garden
- Short walk to Mortlake Station and East Sheen
- Available for a short let of between 1 and 3 months.

2 Parliament Mews, Mortlake, SW14 7QP

SUMMARY

- Master Bedroom with en-suite shower room
- Further double bedroom
- Prestigious riverside development
- Private garden with river views
- 2 bathrooms
- Large reception room with fabulous river views from all windows
- Open plan kitchen
- Secure gated parking for one car
- Newly decorated
- Huge amount of built-in storage
- Short walk to Mortlake Station

£4000pcm Fully Furnished
Inclusive of all bills and broadband

THE PROPERTY

This superb apartment is tucked away in this beautiful development on the banks of the River Thames, right opposite the finish line of the Oxford and Cambridge Boat Race. Every room has the most fabulous river views, which can also be enjoyed from the garden.

The apartment is situated on the 1st floor and has 2 double bedrooms, 2 bathrooms, a large open plan kitchen/living room with unbroken views of the river and Chiswick Bridge. The flat has stacks of built-in storage too which is extremely useful. All things to make you very happy indeed.

There is an allocated parking space with the property and the development is situated behind security gates.

THE AREA

It doesn't get much better than this, the perfect spot to dissolve the stresses and strains of day-to-day grind and rejuvenate the soul with the tranquillity of the River Thames. Once a year, you will be the host with the most as the Oxford and Cambridge crews race past the winning post right outside your living room window!

A gem of a property situated in a convenient spot which is literally a 5 minute walk to Mortlake Station. This property also has the benefit of being close to the A316 and M3 and M4 motorway networks.

Mortlake Station is 25 minutes from Waterloo (Zone 3)

FLOORPLAN

Parliament Mews, London, SW14

Approximate Gross Internal Area = 77.7 sq m / 836 sq ft

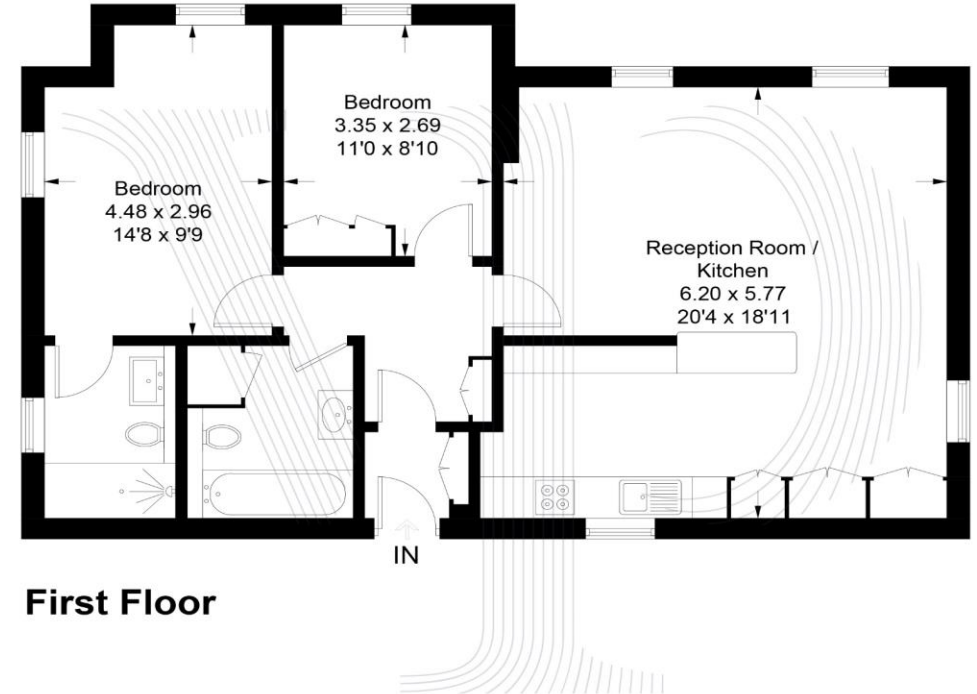

First Floor













