

# FLETCHERS

ESTATE AGENTS

---



**Cleveland Avenue, W4**

**£1,699,950**

A fantastic opportunity to purchase this spacious family home (c. 2,225 sq ft) on a centrally located residential road. The house offers superb width and plenty of entertaining space downstairs, with five bedrooms and three bathrooms on the upper levels.





The ground floor features a cosy 20 ft reception room at the front, complete with large sash windows, an open fireplace and high ceilings with coving. There is a separate open-plan kitchen/family room to the rear, which has been extended with skylights and bi-folding doors to the garden.

Upstairs, the first floor includes three good sized double bedrooms, one of which is being used currently as a home office. There is a large family bathroom, and a walk-in wardrobe. The second floor has flexible living space with two further bedrooms and two bathrooms.

The house has been well looked after with many original features still in good condition. Further benefits such as a ground floor WC, cellar and plenty of built in storage complete this family home.

Cleveland Avenue is ideally located off the Chiswick High Road, which offers plenty of amenities within walking distance, and sits between Turnham Green and Stamford Brook tube stations.

- Five Bedrooms • Three Bathrooms • In Excess Of 2,200 Sq Ft •
- 20 ft Reception Room • Kitchen/Family Room • Period Features •







# FLETCHERS

## ESTATE AGENTS

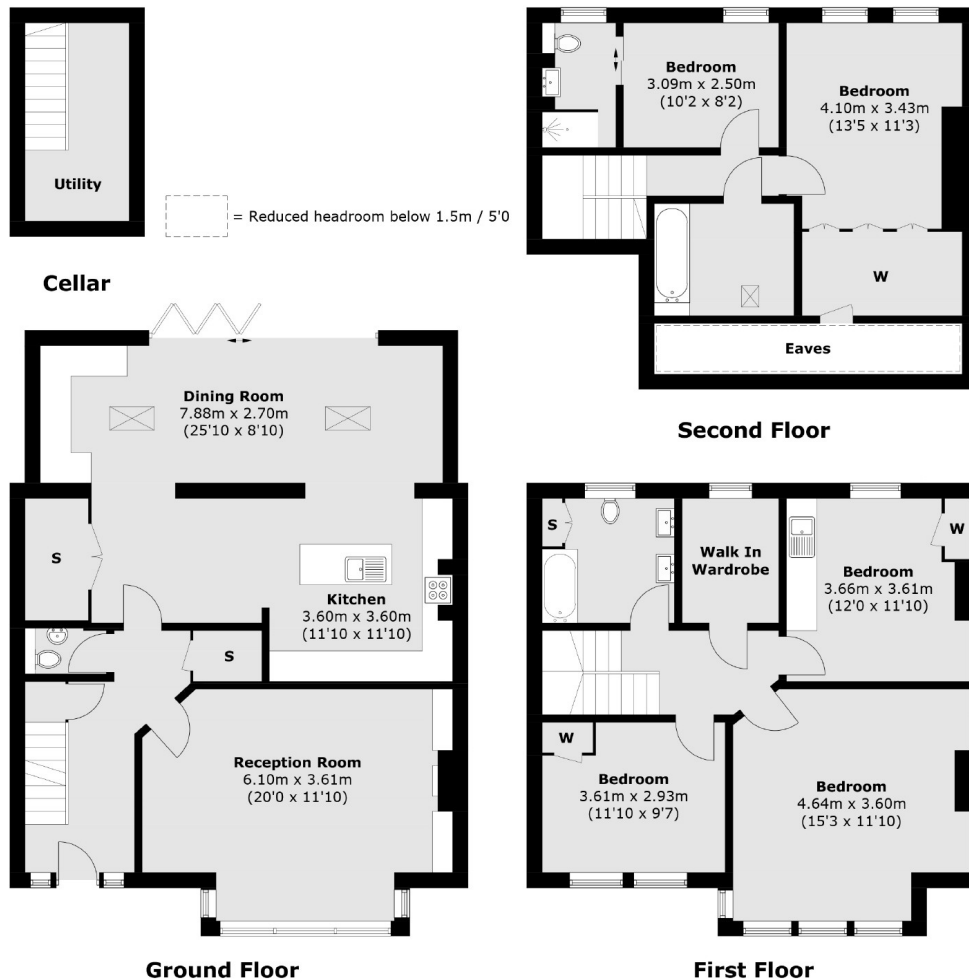

Total area (approx.): 206.8 sq. m (2,225.8 sq. ft)  
(Excluding Eaves)

Fletchers Chiswick Turnham Green Sales  
58 Turnham Green Terrace  
London  
W4 1QP  
020 8987 3000  
[chiswicksales@fletcherestates.com](mailto:chiswicksales@fletcherestates.com)

Energy Rating: C We aim to make our particulars both accurate and reliable. However they are not guaranteed; nor do they form part of an offer or contract. If you require clarification on any points then please contact us, especially if you're traveling some distance to view. Please note that appliances and heating systems have not been tested and therefore no warranties can be given as to their good working order