



24 Regent Street
, Coventry



24 Regent Street , Coventry CV1 3EP

ACADEMIC YEAR 2023/2024 - AVERAGE £575 PER MONTH PER ROOM INCLUDING BILLS - 6 bedrooms - Recently completely renovated - High standards throughout - Ultra modern kitchen and bathrooms - Very close to university and city centre - Very close to train station and Central Six



Finished to a really high standard throughout, this six bedroom property is an ideal base for students. Close to the city centre and the train station. On the ground floor there are two large double rooms and a shower room. To the rear is a snug, leading through into a dining kitchen and the garden beyond. On the first floor there are three further double rooms and another good sized shower room. On the top floor is a lovely double loft room. Everything is very modern throughout and available from August/September 2023.

- Six bedrooms
- Averaging £575 per room
- Large kitchen diner
- Separate snug
- Rear garden
- Very close to the university
- Renovated throughout
- Available academic year 23/24

PCM

£3,300 PCM



Room



Room



Room



Room



Room



Room



Room

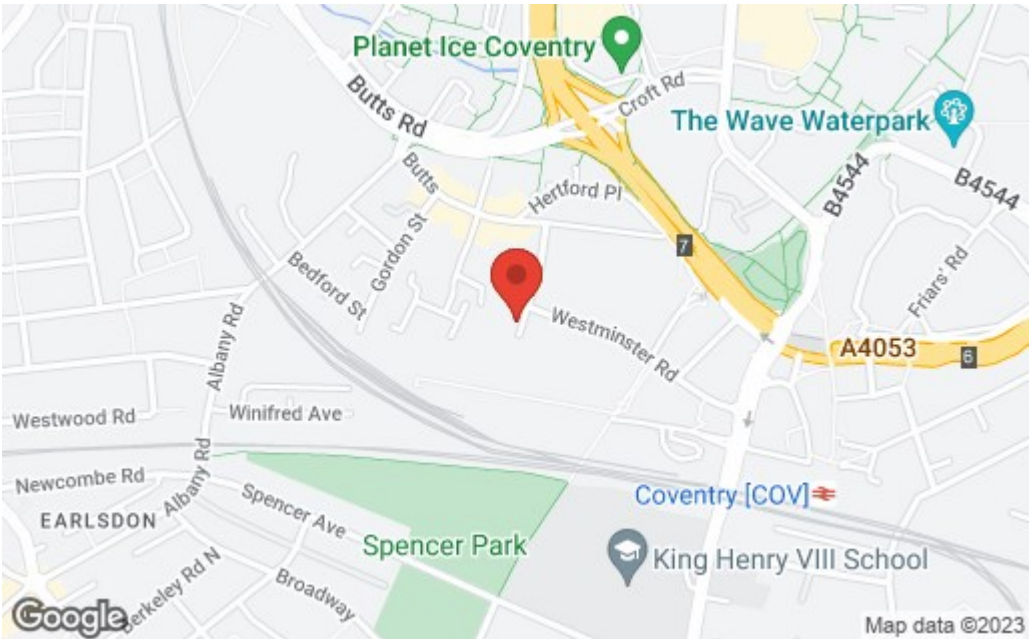

Room



Room

Tenure

We are verbally told that this property is . This will be checked through Solicitors.

Fittings & Fixtures

Only the fittings and fixtures mentioned herein are included within the proposed sale of this property. All others are specifically excluded unless otherwise agreed in writing.

Council tax

According to valuation Office Website enquiries this property is in Band D

Energy Efficiency Rating		
	Current	Potential
Very energy efficient - lower running costs		
(92 plus) A		
(81-91) B		
(69-80) C		
(55-68) D		
(39-54) E		
(21-38) F		
(1-20) G		
Not energy efficient - higher running costs		
England & Wales		EU Directive 2002/91/EC

THESE PARTICULARS DO NOT CONSTITUTE ANY PART OF A CONTRACT OR OFFER. COOPERS give notice to prospective purchasers that they must not rely upon any statement herein as representation of fact but they should make their own inspection or commission a survey. The owners do not make or give and neither COOPERS nor their employees have any authority to make or give any representation or warranty whatsoever in relation to this property. All reasonable efforts have been made to ensure the accuracy of these Sales Particulars including the approximate measurements stated. These are for general guidance only. COOPERS have not tested any apparatus, equipment, fittings and fixtures or services & so cannot verify that they are in working order or fit for purpose. Any purchaser is advised to obtain verification from their Surveyor or Solicitor.

Ground Floor



First Floor

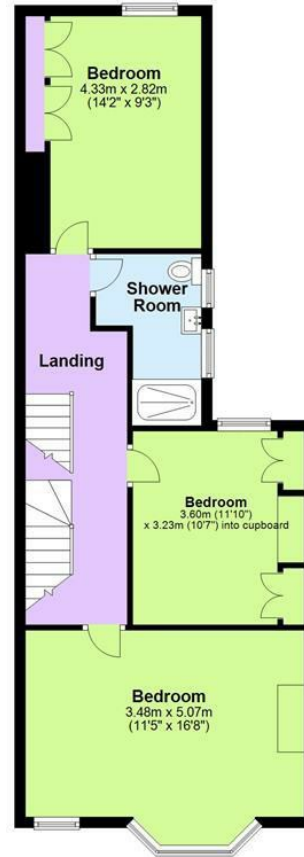

Second Floor



Total area: approx. 163.8 sq. metres (1763.5 sq. feet)

This floor plan is for illustrative purposes only and should be used as such by any prospective purchaser. Whilst every attempt has been made to ensure the accuracy of this plan, measurements of doors, windows, rooms and other items are approximate and no responsibility is taken for any error, omission or mis-statement.
Plan produced using PlanUp.

22 New Union Street, Coventry, CV1 2HN

024 7655 2841

www.coopersestateagents.com

sales@coopersestateagents.com

rightmove 
Zoopla

Coopers