



JORDAN CLOSE
LITTLE BOWDEN, MARKET HARBOROUGH

JAMES
SELICKS

Sales • Lettings • Surveys • Mortgages



Jordan Close,
Little Bowden, Market Harborough
Leicestershire

Whether you are a first-time buyer, downsizer or seeking an investment property, this modern two bedroom semi-detached home could be just what you have been looking for. Tucked away close to the heart of Little Bowden, within walking distance from Market Harborough town centre and rail station, with a re-fitted kitchen, re-fitted bathroom and timber framed summer house it's a little gem.

Modern semi-detached home | Two double bedrooms | Sitting room and conservatory | Refitted kitchen | Refitted bathroom | Landscaped garden to rear | Timber-framed summer house | Off-road parking | Walking distance to railway station | Sought after location |

ACCOMMODATION

A handy porch greets you as you step inside, allowing space for you to kick off your shoes before entering the hall. A glazed door leads into the sitting room which feels spacious and bright.

The kitchen has been re-fitted with a range of contemporary wall and base units by Howdens and offers plenty of handy storage and space for preparing your favourite dishes. Integrated appliances include dishwasher, fridge/freezer, oven and electric hob. Natural light spills into the room through the window and door which lead on to the conservatory, where you can enjoy views of the garden.

Upstairs you will find two double bedrooms both with fitted wardrobes and a re-fitted bathroom featuring a fresh, contemporary white suite comprising bath with shower over, WC and wash hand basin.

OUTSIDE

The front has been landscaped to provide a low-maintenance space largely for off-road parking. To the side is a handy timber-framed shed providing secure storage and also access into the garden beyond.

The rear garden is enclosed with timber fencing and has been landscaped to provide a paved patio seating terrace, lawn with path to the side leading to a timber-framed summer house, which offers scope for use as a home office, garden room or gym.

TENURE: Freehold

LOCAL AUTHORITY: Harborough District Council

TAX BAND: B

SERVICES: The property is offered to the market with all mains services and gas-fired central heating.

LOCATION

Little Bowden is an attractive and highly sought after village which forms part of Market Harborough, a thriving market town receiving regular national accolade in the press in various quality of life surveys. The town offers a mainline railway station to London St Pancras in under an hour and a wide range of niche shopping, restaurants and a wide range of leisure and sporting amenities. Market Harborough is situated in some of the county's most attractive countryside.

DIRECTIONAL NOTE

From Market Harborough town centre proceed along St Marys Road, (A4304). At the traffic lights turn right into Kettering Road and proceed straight at the roundabout into Kettering Road and turn left before the railway bridge, into Jordan Close. Follow the road round and the property can be found in the left hand corner.





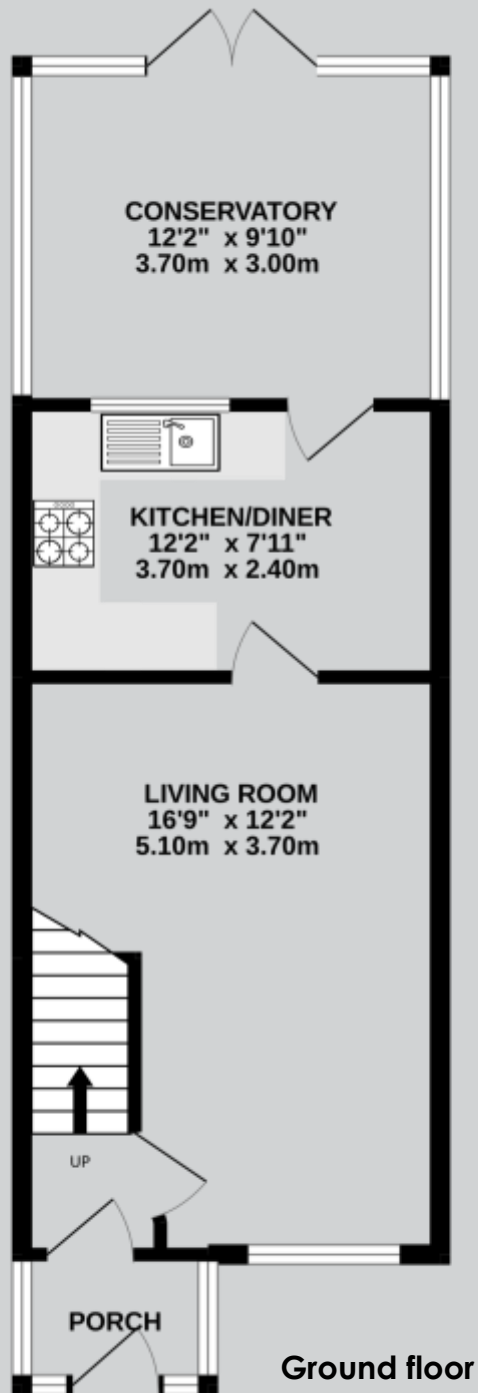

Ground floor

Total Approx Gross Floor Area = 68.5 Sq. M (737 Sq. Ft)

Measurements are approximate. Not to scale.
For illustrative purposes only.

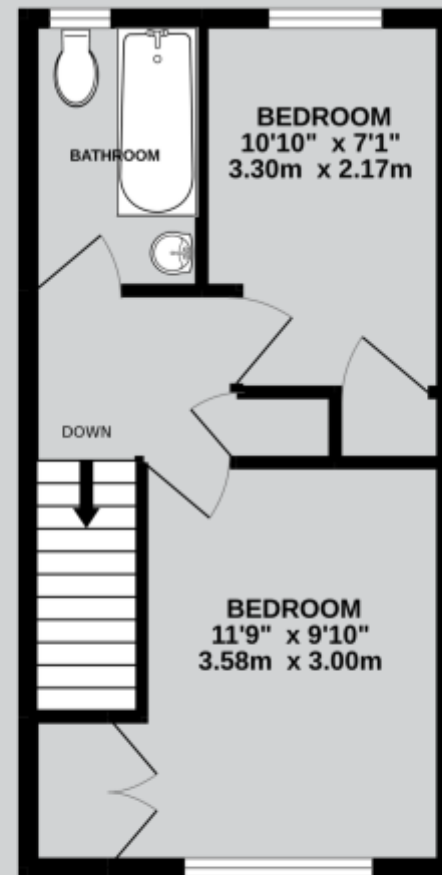

First floor

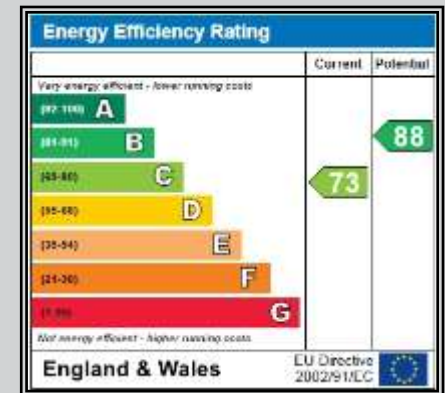



Summer House

JAMES SELICKS

www.jamesselicks.com



Market Harborough Office
13 Church Street,
Market Harborough LE16 7AA
01858 410008
mh@jamesselicks.com

Leicester Office
0116 285 4554

Oakham Office
01572 724437

London Office
0207 839 0888



- James Sellicks for themselves and for the Vendors whose agent they are, give notice that:
- 1) The particulars are intended to give a fair and substantially correct overall description for the guidance of intending purchasers and do not constitute part of, an offer or contract. Prospective purchaser(s) and lessees ought to seek their own professional advice.
 - 2) All descriptions, dimensions, areas, reference to condition and if necessary permissions for use and occupation and their details are given in good faith and believed to be correct. Any intending purchaser(s) should not rely on them as statements or representations of fact but must satisfy themselves by inspection or otherwise as to the correctness of each other.
 - 3) No person in the employment of James Sellicks has any authority to make or give any representation or warranty, whether in relation to this property or these particulars, nor to enter into any contract relating to the property on behalf of the Vendors.
 - 4) No responsibility can be accepted for any expenses incurred by any intending purchaser(s) in inspecting properties that have been sold, let or withdrawn.

Measurements and Other Information

All measurements are approximate. Whilst we endeavour to make our sales particulars accurate and reliable, if there is any point which is of particular importance to you, please contact this office and we will be pleased to check the information for you, particularly if contemplating travelling some distance to view the property.

Important Notice

Sales • Lettings • Surveys • Mortgages