

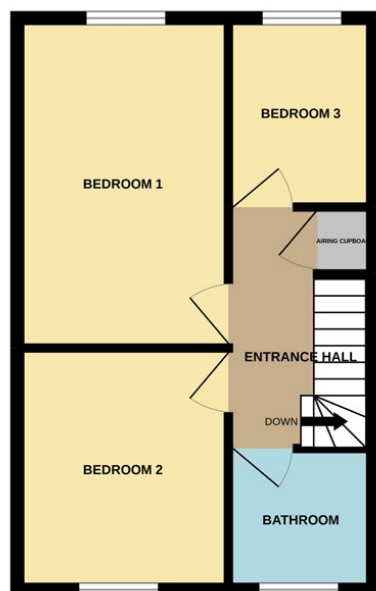

BILLINGBOROUGH

£180,000

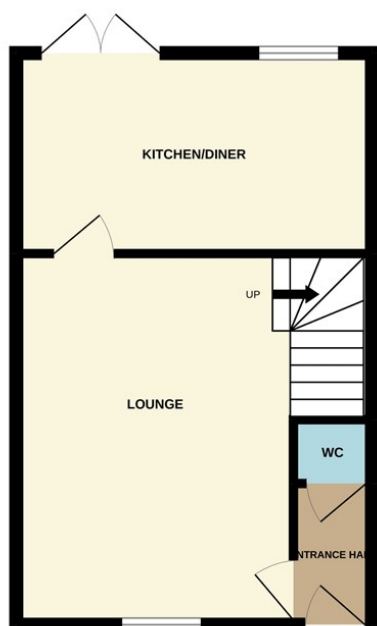

MODERN SEMI DETACHED HOME WITH NO ONWARD CHAIN This property is back on the market due to chain falling through. Offers are invited in excess of £180,000 for this Parker built semi detached home which benefits from lounge, kitchen/diner, downstairs cloakroom, three bedrooms and family bathroom. Outside there is a driveway leading to a single garage and an enclosed rear garden with paved patio area. Viewing recommended. EPC Rating C.