

for sale

offers in the region of **£190,000** Freehold



Shrewsbury Place Dudley DY1 4FG

Modern Family Home in a Good Location whilst offering the benefit of Upvc Double Glazing and Gas Central Heating.

Shrewsbury Place Dudley DY1 4FG

Reception Hall

stairs off to first floor,

Guest Cloakroom

low level w.c. wash hand basin, radiator,

Lounge

14' 7" x 11' 6" (4.45m x 3.51m)

upvc double glazed French doors to rear garden, radiator, store cupboard

Fitted Kitchen / Dining Room

13' 7" x 11' 6" (4.14m x 3.51m)

inset sink unit, fitted base and drawer cupboards, roll top working surfaces, tiled surrounds, built in oven, fitted hob, extractor hood, wall cupboards, appliance space, radiator, central heating boiler



On The First Floor

Landing

Bedroom One

14' 8" x 9' 7" (4.47m x 2.92m)

2 upvc double glazed windows, radiator

Bedroom Two

9' 9" x 8' (2.97m x 2.44m)

upvc double glazed window, radiator

Bedroom Three

6' 7" x 6' 5" (2.01m x 1.96m)

upvc double glazed window, radiator

Family Bathroom

panelled bath, wash hand basin, low level w.c. radiator, upvc double glazed window, tiled surrounds

Outside

To The Rear: patio, Lawn



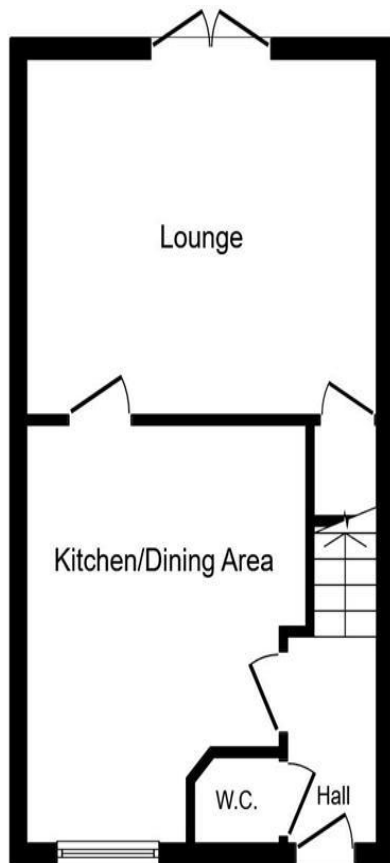

Ground Floor

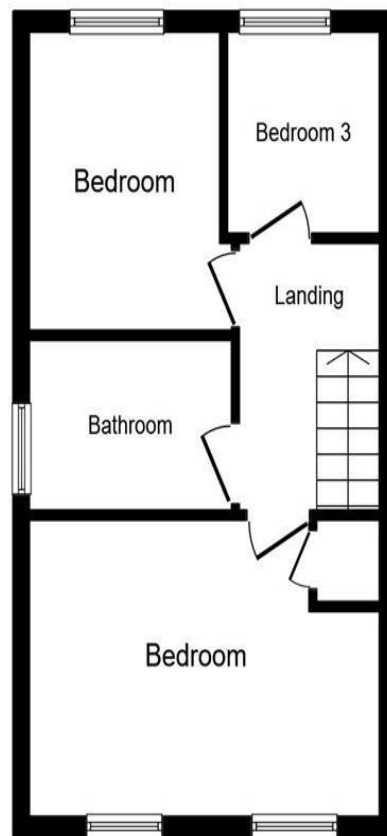

First Floor

Total floor area 70.0 sq. m. (753 sq. ft.) approx

This floor plan is for illustrative purposes only. It is not drawn to scale. Any measurements, floor areas (including any total floor area), openings and orientation are approximate. No details are guaranteed, they cannot be relied upon for any purpose and they do not form part of any agreement. No liability is taken for any error, omission or misstatement. A party must rely upon its own inspection(s).
Plan produced for Your Move. Powered by www.focalagent.com

To view this property please contact Paul Dubberley on

T 0121 522 3733
E greatbridge@pauldubberley.co.uk

73 Great Bridge
TIPTON DY4 7HF

Property Ref: PTI102516 - 0002

Tenure: Freehold

EPC Rating: B

check out more properties at PaulDubberley.co.uk



1. MONEY LAUNDERING REGULATIONS Intending purchasers will be asked to produce identification documentation at a later stage and we would ask for your co-operation in order that there will be no delay in agreeing the sale. 2. These particulars do not constitute part or all of an offer or contract. 3. The measurements indicated are supplied for guidance only and as such must be considered incorrect. Potential buyers are advised to recheck measurements before committing to any expense. 4. We have not tested any apparatus, equipment, fixtures, fittings or services and it is in the buyers interest to check the working condition of any appliances.

see all our properties at www.pauldubberley.co.uk | www.rightmove.co.uk | www.zoopla.co.uk