



Connells

Barrosa Way
Whitehouse Milton Keynes

Barrosa Way Whitehouse Milton Keynes MK8 1DS

for sale offers over
£430,000



Property Description

Situated in the sought after development of Whitehouse this modern four bedroom end of terrace is the perfect family home. The property briefly comprises of entrance hall, cloakroom and a spacious Kitchen/Diner for entertaining. On the first floor you have the living room, bedroom three and family bathroom. On the second floor there are three bedrooms with an en-suite to master bedroom. Outside there is an enclosed rear garden and allocated parking for two vehicles. Whitehouse offers a local primary school, great road links and nearby to central Milton Keynes and Stony Stratford. Viewing is highly recommended to appreciate the size and condition of this property.

Ground Floor

Entrance Hall

Double glazed door to front aspect. Storage cupboard. Wall mounted radiator.

Cloakroom/utility

Double glazed window to front aspect, W.C and wash hand basin. Integrated washing machine. Central heating boiler. Wall mounted radiator.

Kitchen/diner

17' x 21' 7" (5.18m x 6.58m)

Double glazed french doors leading onto rear garden. Fitted kitchen with a range of wall and base units with work surface over. Gas hob and oven with cooker hood over. Integrated dishwasher and fridge/freezer. Wall mounted radiator.

First Floor

Landing

Stairs raising from ground. Double glazed window to front aspect.

Living Room

17' x 12' 9" Max (5.18m x 3.89m Max)

Double glazed Juliet balcony to rear aspect. Wall mounted radiator.

Bedroom Three

10' 2" x 9' 3" (3.10m x 2.82m)

Double glazed window to front aspect. Wall mounted radiator.

Bathroom

Fitted part tiled suite comprise of bath with mixer taps, W.C and wash hand basin. Heated towel rail.

Second Floor

Landing

Loft access. Storage cupboard.

Bedroom One

14' 9" Max x 9' 9" Max (4.50m Max x 2.97m Max)

Two double glazed windows to front aspect. Built in wardrobes. Wall mounted radiator.

En Suite

Fitted to comprise of double shower cubicle, W.C, wash hand basin and shaver point. Radiator. Partly tiled to walls. Extractor fan.

Bedroom Two

9' 11" x 12' 9" Max (3.02m x 3.89m Max)

Double glazed rear window. Wall mounted radiator.

Bedroom Four

6' 10" x 8' 11" (2.08m x 2.72m)

Double glazed window to rear aspect. Wall mounted radiator.

Outside

Rear Garden

Laid to lawn and patio garden. Wooden fencing with side access.







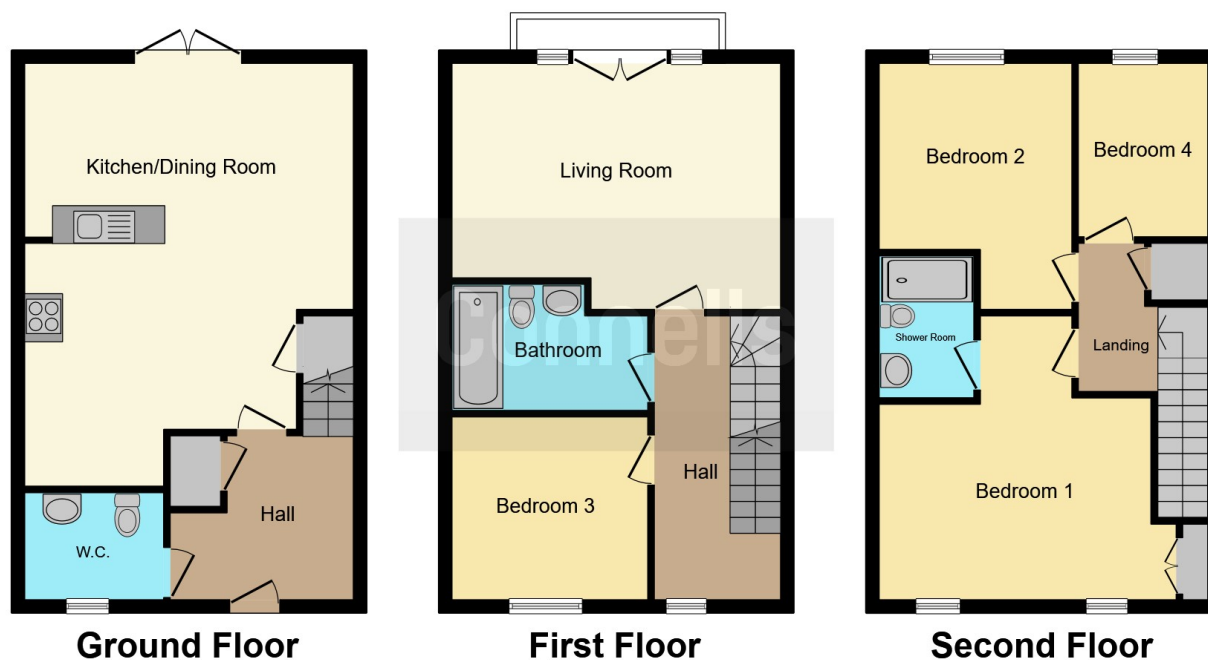

Total floor area 132.6 sq.m. (1,427 sq.ft.) approx

This floorplan is for illustrative purposes only and is not drawn to scale. Measurements, floor-areas, openings and orientations are approximate. They should not be relied upon for any purpose and do not form any part of an agreement. No liability is taken for any error or mis-statement. All parties must rely on their own inspections.

To view this property please contact Connells on

T 01908 330751
E oxleypark@connells.co.uk

Unit 10 64 Redgrave Drive Oxley park
 MILTON KEYNES MK4 4TB

EPC Rating: B

view this property online connells.co.uk/Property/OXP104118

Tenure: Freehold



1. MONEY LAUNDERING REGULATIONS Intending purchasers will be asked to produce identification documentation at a later stage and we would ask for your co-operation in order that there will be no delay in agreeing the sale. 2. These particulars do not constitute part or all of an offer or contract. 3. The measurements indicated are supplied for guidance only and as such must be considered incorrect. Potential buyers are advised to recheck measurements before committing to any expense. 4. We have not tested any apparatus, equipment, fixtures, fittings or services and it is in the buyers interest to check the working condition of any appliances.

See all our properties at www.connells.co.uk | www.rightmove.co.uk | www.zoopla.co.uk

Property Ref: OXP104118 - 0004