



Thorgills

MARKET LEADING AGENCY



Thorgills 

Gibsons Place, Brentford, TW8 8FA

£3,000



Floor Plan

Gibsons Place

Approximate Gross Internal Area = 148.5 sq m / 1598 sq ft



First Floor

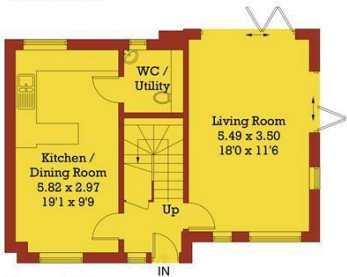

Ground Floor

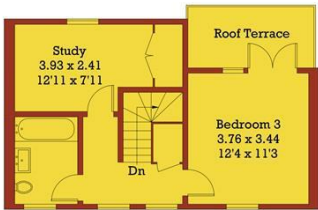

Second Floor

Illustration for identification purposes only, measurements are approximate, not to scale. FloorplansUsketch.com © 2018 (ID490869)

These particulars, whilst believed to be accurate are set out as a general outline only for guidance and do not constitute any part of an offer or contract. Intending purchasers should not rely on them as statements of representation of fact, but must satisfy themselves by inspection or otherwise as to their accuracy. No person in this firms employment has the authority to make or give any representation or warranty in respect of the property.

Accommodation

- Gated Development
- Luxurious Finish
- Private Driveway
- Garden
- Terrace
- Fully Fitted Kitchen
- Separate Reception Room
- Three Modern Bathrooms
- Downstairs WC
- Fitted Storage

Viewing

Please contact our Brentford branch on 020 8994 9886 if you wish to arrange a viewing appointment for this property or require further information.

Energy Efficiency Graph

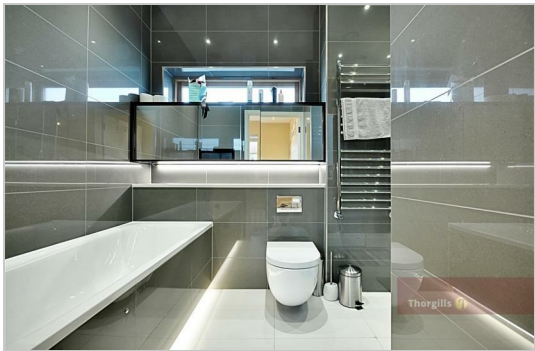
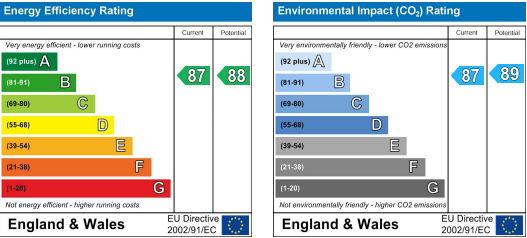

SALES & LETTINGS
020 8994 9886

CLIENT SUPPORT
020 8560 9555

PROPERTY MANAGEMENT
020 8994 9945

ACCOUNTS
020 8758 2888

