



Hart Grove, W5

£1,450,000

A five bedroom detached house on a quiet residential street, only moments from Ealing Common. The house has just under 1900 square feet of internal space, two garages and off-street parking for several vehicles. Offered to market with no onward chain.

Within a quarter of a mile from Ealing Common station (Piccadilly and District lines) along with several bus routes. The local amenities of the Uxbridge Road are within 200 yards.

- Detached House • No Onward Chain • Off-Street Parking •
- Two Garages • Two Bathrooms • Circa 1900 Sq. Ft. •

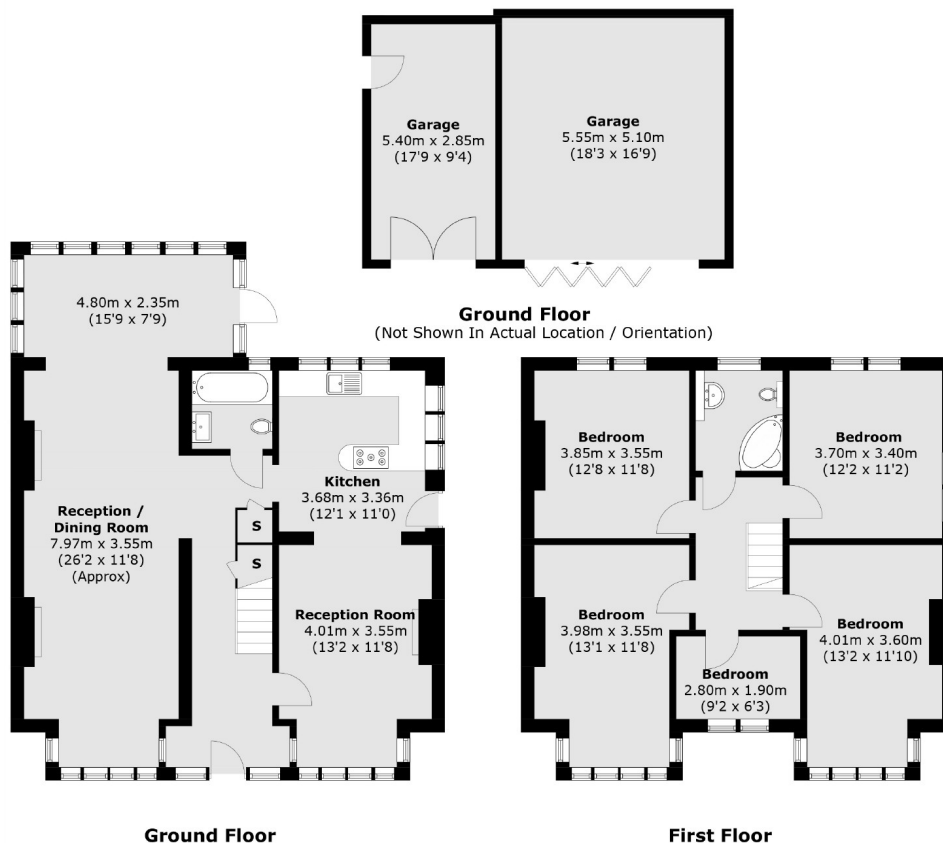

Total area (approx.): 175.8 sq. m (1,892.2 sq. ft)
Garage : 44.5 sq. m (478.9 sq. ft)

Robertson Smith & Kempson Ealing Sales
1 The Broadway, London,
W5 2NT
020 8840 7677
ealingsales@robertsonsmithandkempson.co.uk

Energy Rating: D. We aim to make our particulars both accurate and reliable. However they are not guaranteed; nor do they form part of an offer or contract. If you require clarification on any points then please contact us, especially if you're traveling some distance to view. Please note that appliances and heating systems have not been tested and therefore no warranties can be given as to their good working order.