



Limetree Close, SW2

£500,000

3 bedroom terrace house located within a quite close, with front and rear garden, open plan kitchen/dining room and separate reception.

- Freehold House
- 3 bedrooms
- Private Garden
- Chain Free



Limetree Close benefits from being within very short proximity of an array of amenities, including coffee shops, restaurants and bars. The local commuting links are more than convenient with frequent buses routes to Brixton and beyond as well as train services at Streatham Hill providing swift connection with Victoria and Clapham Junction.



Ground Floor

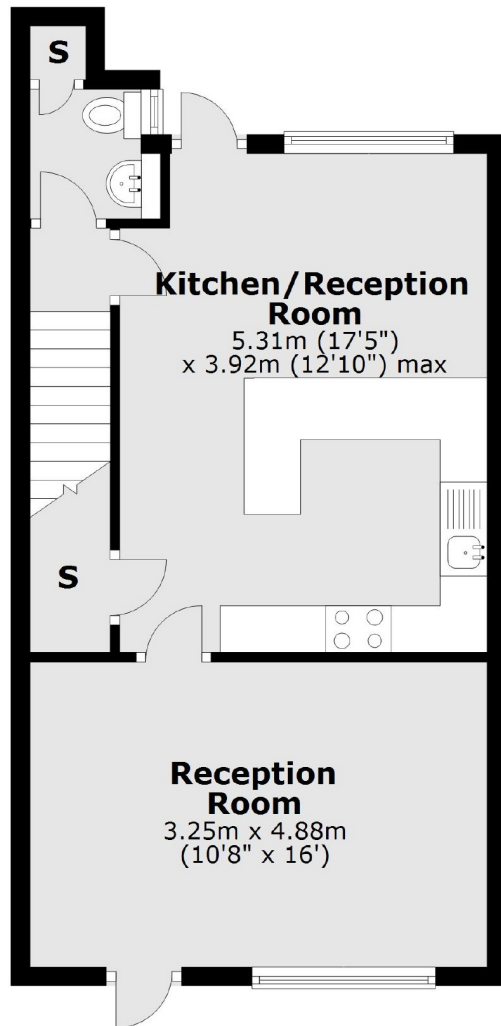

First Floor

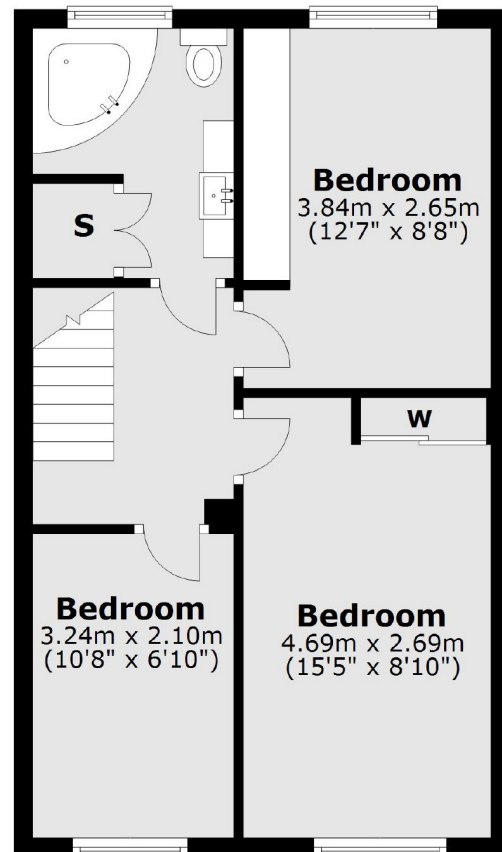

Total area: approx. 85.8 sq. metres (923.5 sq. feet)

Jacksons Streatham
1-3 De Montfort Parade
Streatham High Road
Streatham
London
SW16 1BU

Energy Rating: D We aim to make our particulars both accurate and reliable. However they are not guaranteed; nor do they form part of an offer or contract. If you require clarification on any points then please contact us, especially if you're traveling some distance to view. Please note that appliances and heating systems have not been tested and therefore no warranties can be given as to their good working order.