



Kingsley Avenue, W13

£995,000

A five bedroom semi-detached and double-fronted home on a quiet residential street. The property is arranged over three floors to provide a spacious family home, has front and rear gardens and is offered to market with no onward chain.

Just over half a mile from West Ealing station (forthcoming Crossrail line) and has multiple bus routes available. There is a good range of schools nearby.

- No Onward Chain • Double-Fronted • Circa 1700 Sq Ft •
- Two Bathrooms • Three Receptions • Double Glazing •

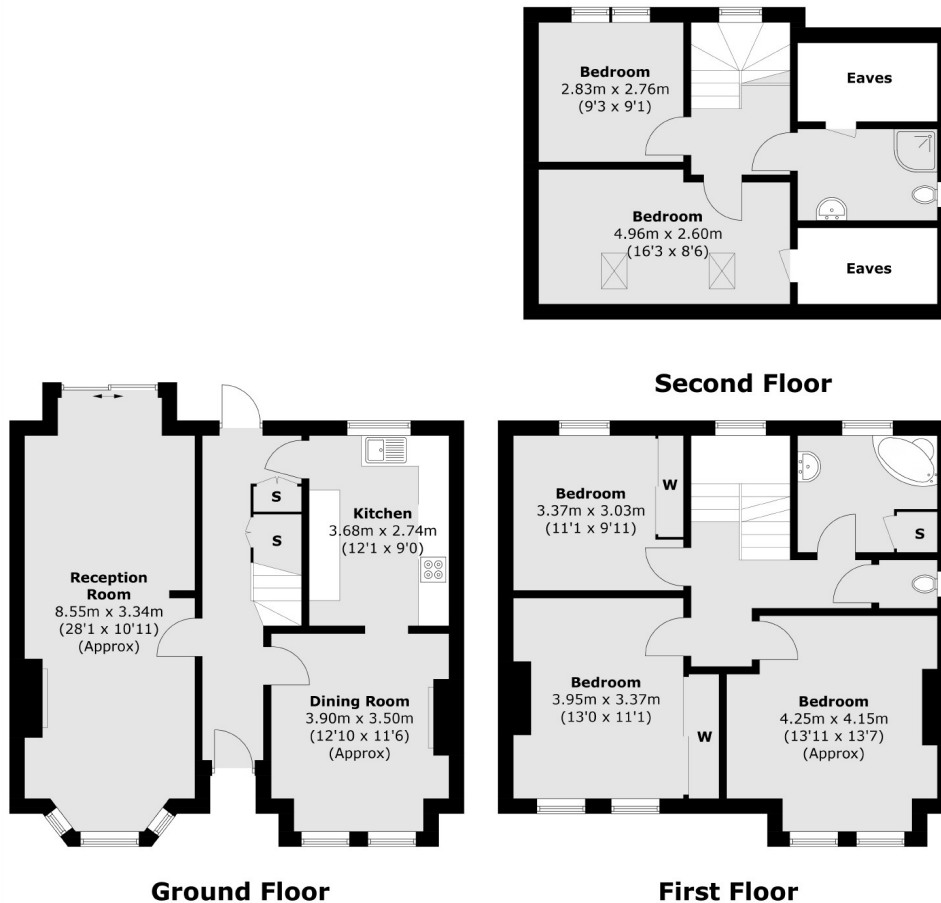

Total area (approx.): 157.6 sq. m (1,696.3 sq. ft) (Excluding Eaves)

Robertson Smith & Kempson Ealing Sales
 1 The Broadway, London,
 W5 2NT
 020 8840 7677
ealingsales@robertsonsmithandkempson.co.uk

Energy Rating: E. We aim to make our particulars both accurate and reliable. However they are not guaranteed; nor do they form part of an offer or contract. If you require clarification on any points then please contact us, especially if you're traveling some distance to view. Please note that appliances and heating systems have not been tested and therefore no warranties can be given as to their good working order.