

Is this the one?



£149,950

**Mansfield Close
Newcastle Under
Lyme ST5 4HA**



2



1



1

- Detached Bungalow
- Two Bedrooms
- Open Plan Lounge/Diner
- Fitted Kitchen
- Family Bathroom
- Upvc Double Glazing & Combi-Boiler

heywoods | 88 |

It's all in the detail.

Heywood's are delighted to welcome to the sales market with the benefit of no upward chain, this two bedroom detached bungalow located in the popular residential area of Clayton. The property is handily placed close to local amenities, within easy reach of Royal Stoke Hospital and has commuting links to A500 & M6. Well maintained throughout the accommodation comprises; entrance hall, lounge/diner, fitted kitchen, two bedrooms and a family bathroom. Externally there is a private enclosed rear garden with lawn, patio area, useful wooden storage shed, gated driveway providing off road parking with additional garden to the front. Viewing is recommended!

****Video viewing available on request****

ENTRANCE HALL With composite front door, Honeywell heating control, loft access

LOUNGE/DINER 15' 8" x 11' 9" (4.8m x 3.6m) (measurement reduces to 3.3)

With Upvc double glazed window to the front,

coving, feature coal effect electric fire, TV aerial point

FITTED KITCHEN 9' 6" x 6' 6" (2.9m x 2.0m) Fully tiled with a range of base and wall units, space for oven, extractor, space and plumbing for washer machine, space for freestanding fridge/freezer, one and a half sink with mixer tap, wall mounted Worcester combi-boiler (installed 2018), tiled floor covering, Upvc double glazed window to the front

BATHROOM 5' 6" x 5' 2" (1.7m x 1.6m) Fully tiled with bath with hand held shower attachment over, WC, wash hand basin, Upvc double glazed frosted window to the side

BEDROOM 11' 5" x 8' 10" (3.5m x 2.7m) With Upvc double glazed window to the rear, coving

BEDROOM 8' 6" x 8' 2" (2.6m x 2.5m) With Upvc double glazed window to the rear, coving

EXTERNALLY Private enclosed rear garden with patio area, lawn (split into two separate levels), useful wooden storage shed, gated driveway providing off road parking for several vehicles, additional garden to front with lawn



Can you
picture
yourself
here?



GROUND FLOOR

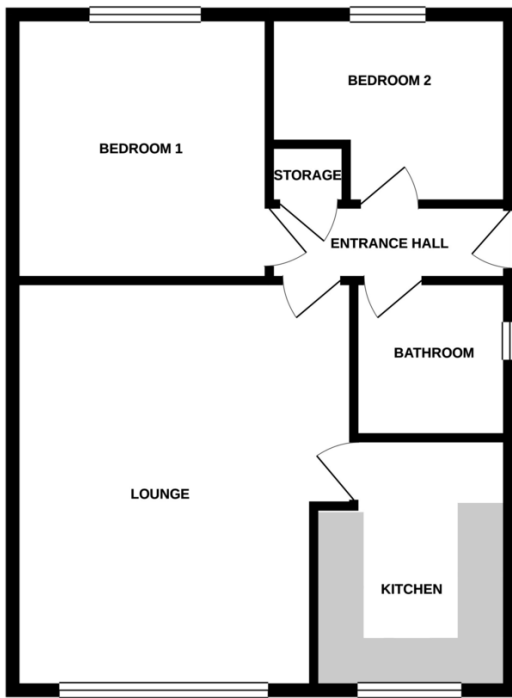

Whilst every attempt has been made to ensure the accuracy of the floorplan contained here, measurements of doors, windows, rooms and any other items are approximate and no responsibility is taken for any error, omission or mis-statement. This plan is for illustration purposes only and should be used as such by any prospective purchaser. The services, systems and appliances shown have not been tested and no guarantee as to their operability or efficiency can be given.
Made with Metropix ©2021

Selling & letting
homes throughout
Staffordshire &
Cheshire.



How much would
I get to rent this
property?

hey let's talk to our
lettings guru and find
out...

%epcGraph_c_1_130
_rZ%

The Estate Offices Blackfriars
Road Newcastle-under-Lyme
ST5 2EB

01782 617343
[heywoodsproperty.co.uk](https://www.heywoodsproperty.co.uk)



DISCLAIMER: All measurements are taken electronically and whilst every care is taken with their accuracy they must be considered approximate and should not be relied upon when purchasing carpets or furniture. No responsibility is taken for any error, omission or misunderstanding in these particulars which do not constitute an offer or contract. Services and appliances have not been tested and therefore no warranty is offered on their operational condition.

