

# FLETCHERS

ESTATE AGENTS



## Chiswick Road, W4

£315,000

In this prime position and moments from the High Street, a bright well planned 4th floor one bedroom apartment. The apartment is available chain free and would make an ideal first time buy or pied-a-terre.

Dewsbury Court is perfectly placed for immediate access to the large Sainsburys supermarket, the great selection of bars and restaurants on the high street, and both Chiswick Park and Gunnersbury stations.

- One Double Bedroom • Open-Plan Kitchen • Chain Free • Fourth Floor • Close To Amenities • Close To Transport •

## Fourth Floor

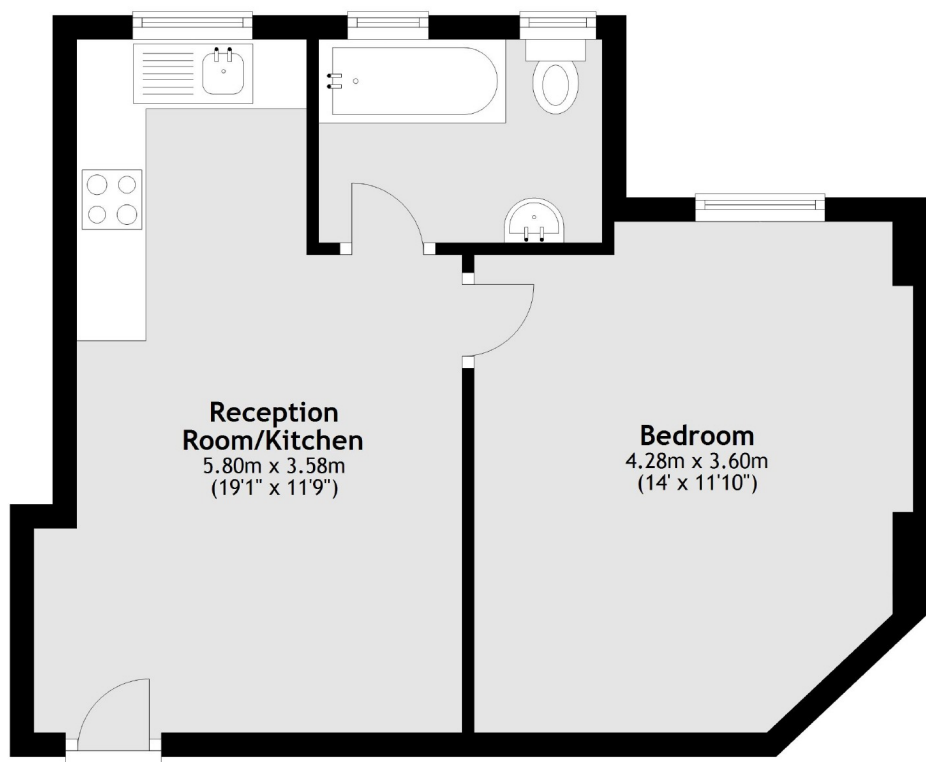

Total area: approx. 36.6 sq. metres (393.6 sq. feet)

Fletchers Chiswick Turnham Green Sales  
58 Turnham Green Terrace, London, W4 1QP  
020 8987 3000  
[chiswicksales@fletcherestates.com](mailto:chiswicksales@fletcherestates.com)

Energy Rating: C. We aim to make our particulars both accurate and reliable. However they are not guaranteed; nor do they form part of an offer or contract. If you require clarification on any points then please contact us, especially if you're traveling some distance to view. Please note that appliances and heating systems have not been tested and therefore no warranties can be given as to their good working order.