

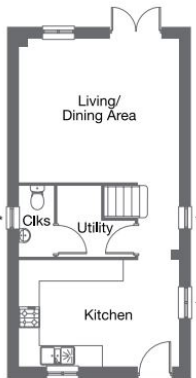

The Chester, Abbey Park, Thorney, Peterborough PE6 0SS

£109,998



* Windows to specific plots only

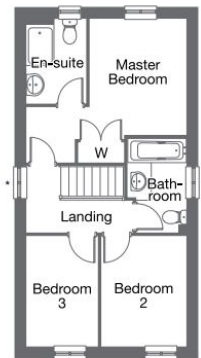

* Windows to specific plots only



***PRICES FROM £109,998 FOR 50% SHARE *** This three bedroom mid terraced house has a large kitchen, made even more spacious by the separate utility room. A sizable living/dining area can be utilised however you wish to suit your lifestyle and requirements. Bedroom one benefits from both an en-suite and a fitted wardrobe, while bedrooms two and three are good sizes and share use of the house bathroom

KITCHEN

15' 0" x 10' 0" (4.57m x 3.05m) To be fitted with a range of eye level, base and drawer units with worktop. Sink with mixer tap over, hob, oven, boiler. UPVC double glazed window to the front.

INNER LOBBY/ UTILITY AREA

Under stair utility area with space and plumbing for washing machine. Door to:

CLOAKROOM

To be fitted with a two piece suite comprising of WC and wash hand basin.

LOUNGE/DINING ROOM

15' 0" x 13' 6" (4.57m x 4.11m) UPVC double glazed French doors to the rear, UPVC double glazed window to the rear. Stairs to first floor landing.

BEDROOM ONE

10' 11" x 9' 1" (3.33m x 2.77m) (excluding fitted wardrobe) UPVC double glazed window to the rear

EN SUITE

To be fitted with a three piece suite comprising shower cubicle, WC and wash hand basin. UPVC double glazed window to the rear.

BEDROOM TWO

10' 4" x 8' 0" (3.15m x 2.44m) UPVC double glazed window to the front

BEDROOM THREE

10' 4" x 6' 8" (3.15m x 2.03m) UPVC double glazed window to the front

BATHROOM

To be fitted with a three piece suite comprising bath, wash hand basin and WC

AGENTS NOTE

Sizes provided are taken from Larkfleets' sales brochure for this specific house type - 'The Chester'

The property is to be sold on a shared ownership scheme with Home Reach. Please contact Rosedale Property Agents to discuss the shared ownership application process. Successful applicants will be agreed based on individual circumstances and affordability.

Upon successful application and acceptance, there will be a reservation fee to secure the property.

Our experienced team will be on hand where more information is required.

ADDITIONAL INFORMATION

The lease will be granted for 125 years. Affordability examples are as follows:

Property value £250,000

50% shared ownership £125,000

Home Reach monthly Rent £ 286

Figures are based on a 25 year repayment mortgage and a Home Reach lease with an initial rent of 2.75% on the unpurchased property value increasing by RPI + 0.75% each year. Your home may be repossessed if you do not keep up with repayments on your mortgage or shared ownership lease. Additional service charges may be payable on properties with communal facilities. You will also need to consider the responsibilities and associated costs involved with owning a home (such as insurance and maintenance)

Viewings are by appointment only. Please contact a member of the Rosedale Team on 01733 574969 to book.

