

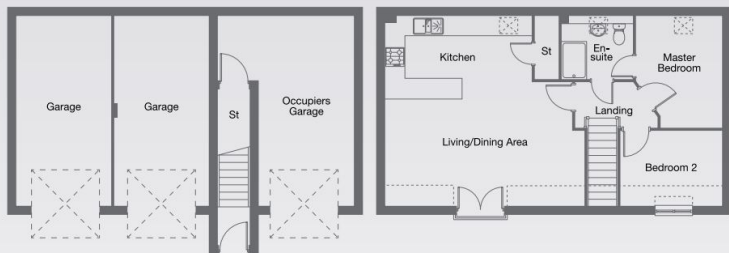

The Upton, Sandpit Road, Thorney, Peterborough, Cambridgeshire PE6 1BS, £188,995



*** Brand New Two Bedroom Coach House *** Deceptively spacious, the entrance to The Upton sits between four garages, one of which is allocated to the coach house. The living areas and bedrooms are on one floor. A large living/dining area leads through to the kitchen, which is fitted with high quality integrated appliances. Bedroom one, at the rear of the house, benefits from an en suite and substantial fitted wardrobe, and there is also a good sized house bathroom and second bedroom at the front. Help To Buy Available

LIVING ROOM

20' 8" x 11' 0" (6.30m x 3.35m)

KITCHEN/DINING AREA

15' 1" x 8' 7" (4.60m x 2.62m)

BEDROOM ONE

11' 6" x 8' 10" (3.51m x 2.69m)

EN-SUITE

7' 5" x 7' 6" (2.26m x 2.29m)

BEDROOM TWO

10' 6" x 7' 9" (3.20m x 2.36m)

AGENTS NOTE

The details in this brochure are intended to give a general indication of the proposed development and floor plan layout and are not to scale. The illustrations of the development and interiors are artist impression only. The developer reserves the right to alter any part of the development, specification or floor layout at any time.

The contents herein shall not form any part of any contract nor is a representation inducing any such contract. Please confirm all details are correct before proceeding to purchase, incurring financial costs. All measurements are approximate and have been provided by the developer.

HELP TO BUY

Help to Buy: Equity Loan price represents 20% of the full asking price. The Government lends you up to 20% of the cost of your newly built home, so you'll only need a 5% cash deposit and a 75% mortgage to make up the rest. You won't be charged loan fees on the 20% loan for the first five years of owning your home.