

## Harwood Road, SW6

£530 pw (£2,297 pcm)

This two double bedroom top floor flat is ideally located in the heart of Fulham Broadway. The property has a private roof terrace with stunning views across the capital, a spacious reception room with space for dining and a separate integrated kitchen.

Harwood Road is located off Fulham Road and New Kings Road with a variety of bus routes leading into the city. Fulham Broadway station is moments away with local amenities, bars, restaurants and large superstores all on your doorstep.

# Chard

Lettings

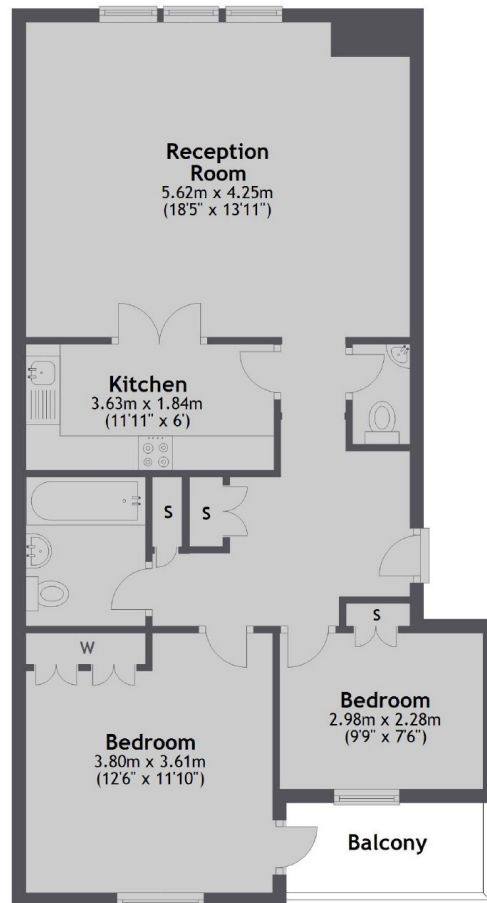

Main area: Approx. 70.9 sq. metres (762.8 sq. feet)  
Plus balconies, approx. 4.6 sq. metres (49.5 sq. feet)

Chard Fulham  
5 Harwood Road,  
London, SW6 4QP  
020 7384 1400  
fulhamlettings@chard.co.uk

Energy Rating: C. We aim to make our particulars both accurate and reliable. However they are not guaranteed; nor do they form part of an offer or contract. If you require clarification on any points then please contact us, especially if you're traveling some distance to view. Please note that appliances and heating systems have not been tested and therefore no warranties can be given as to their good working order.