

heywoods

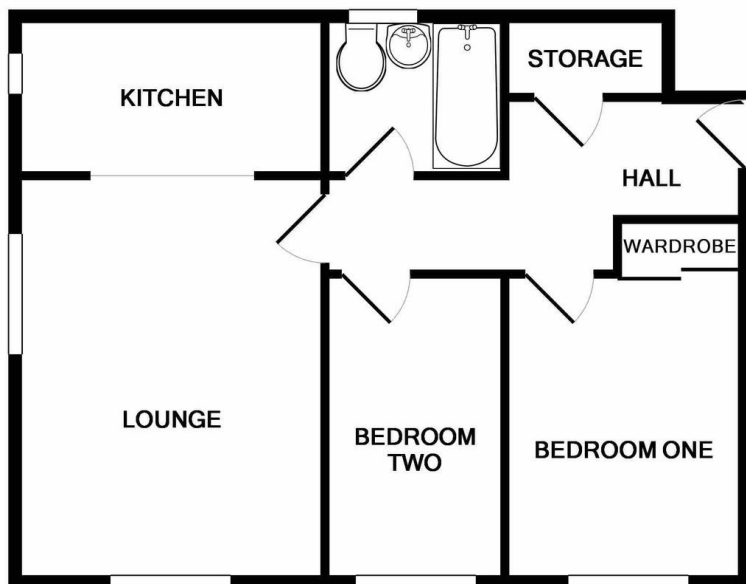

Galingale View
Newcastle, ST5 2GR

Offers In Excess Of £95,000



THE ACCOMODATION

ENTRANCE HALL Storage cupboard, single radiator, doors to;

LOUNGE/DINER 14' 8" x 11' 2" (4.49m x 3.42m) Double radiator, two double glazed windows.

KITCHEN 5' 9" x 11' 1" (1.77m x 3.40m) Fitted wall and base units, built in electric hob and oven with extractor fan over, one and a half bowl stainless steel sink drainer unit, plumbing for automatic washing machine, space for appliances, double glazed window.

BEDROOM 11' 10" x 8' 7" (3.63m x 2.63m) Fitted wardrobe, single radiator, double glazed window.

BEDROOM 11' 1" x 6' 5" (3.40m x 1.97m) Single radiator, double glazed window to side.

BATHROOM 6' 5" x 5' 7" (1.98m x 1.71m) Close coupled WC, pedestal wash hand basin, panelled bath with wall mounted shower over, heated towel rail, part tiled surround.

PARKING The property has an allocated parking space.

Whilst every attempt has been made to ensure the accuracy of the floor plan contained here, measurements of doors, windows, rooms and any other items are approximate and no responsibility is taken for any error, omission, or mis-statement. This plan is for illustrative purposes only and should be used as such by any prospective purchaser. The services, systems and appliances shown have not been tested and no guarantee as to their operability or efficiency can be given
Made with Metropix ©2020

- Modern Apartment
- Convenient Location
- Lounge/Diner
- Kitchen
- Two Bedrooms
- Bathroom
- Allocated Parking
- Viewing Recommended

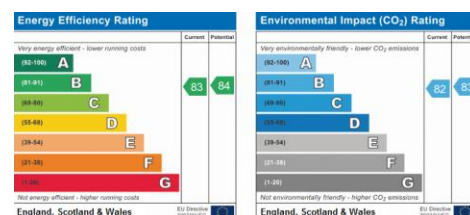

The Estate Offices
Blackfriars Road
New castle-under-Lyme
ST5 2EB

www.heywoodsproperty.co.uk
u2us@heywoodsproperty.co.uk
01782 617343

Agents Note: Whilst every care has been taken to prepare these sales particulars, they are for guidance purposes only. All measurements are approximate are for general guidance purposes only and whilst every care has been taken to ensure their accuracy, they should not be relied upon and potential buyers are advised to recheck the measurements