

8A Sun Street
Waltham Abbey
Essex
EN9 1EE

T: 01992 652006
www.kings-group.net



Willow Path, EN9 3EX



Offers In The Region Of £275,000



2 BEDROOM FAMILY HOME!!! Kings of Waltham Abbey are delighted to offer to the market this chain free two bedroom property. Upon entering the property via the porch you are greeted by a bright and airy open plan living room/diner. The ground floor provides a good size kitchen, finished with white base and eye level units, tiled splash backs and roll top work surfaces. To the first floor you have two double bedrooms, with bedroom two benefiting from built in storage. To the rear of the property you have a private laid to lawn garden with the potential for rear access. Situated in a peaceful part of Waltham Abbey, just a 5 min drive to the quaint market town centre and all the amenities its picturesque, pedestrianised high street has to offer. Also just a 5 min drive to J26 of the M25 and 10 mins to Waltham Cross British Rail station you are well positioned for commuting. This property also offers the potential to extend STPP. This property is sold as seen sold as seen (excluding chattels). Please call 01992 652 006 to arrange your viewing and avoid disappointment.

PORCH 4'95 x 3'94

LIVING ROOM/DINER 19'49 x 11'96

KITCHEN 11'95 x 8'83

MASTER BEDROOM 12'02 x 10'80

BEDROOM TWO 11'99 x 8'23

BATHROOM 6'99 x 5'13

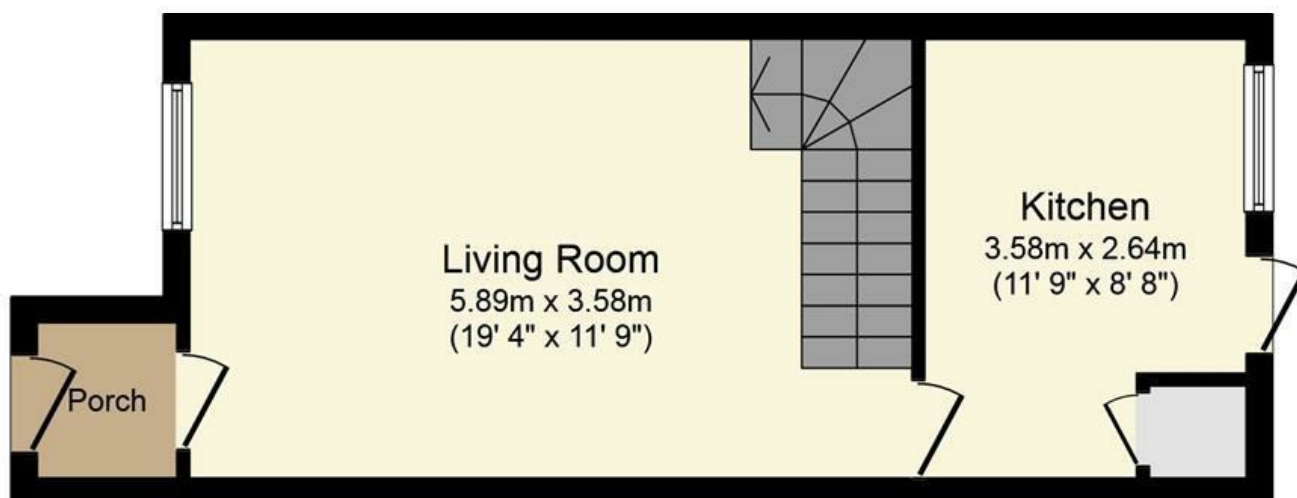

Ground Floor

Floor area 32.4 sq. m. (349 sq. ft.) approx

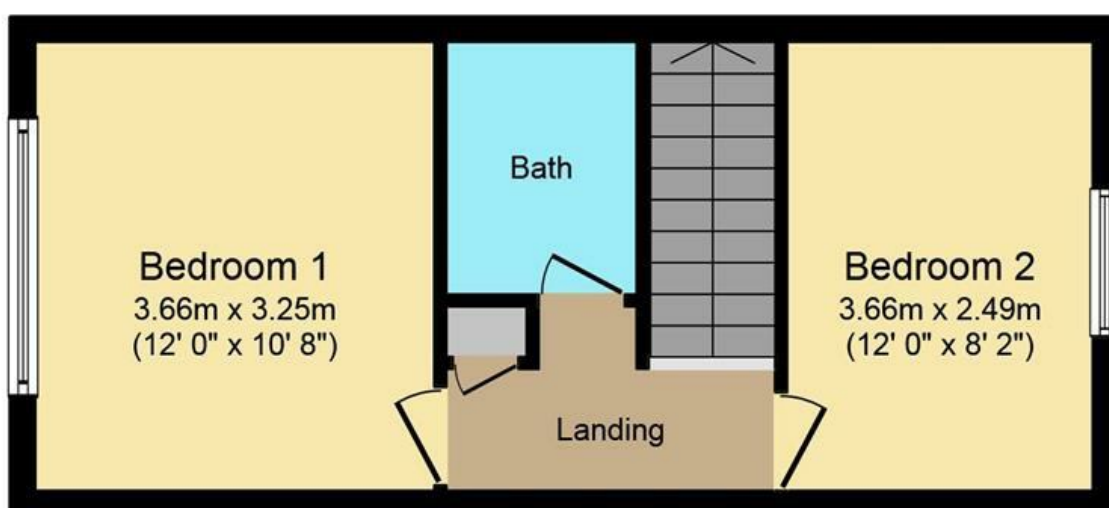

First Floor

Floor area 31.5 sq. m. (339 sq. ft.) approx

Total floor area 63.9 sq. m. (688 sq. ft.) approx

This plan is for illustration purposes only and may not be representative of the property. Plan not to scale.

Powered by audioagent.com

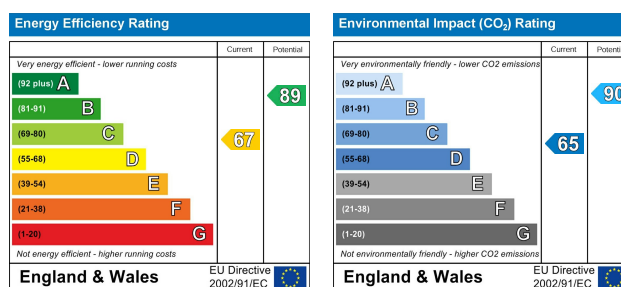
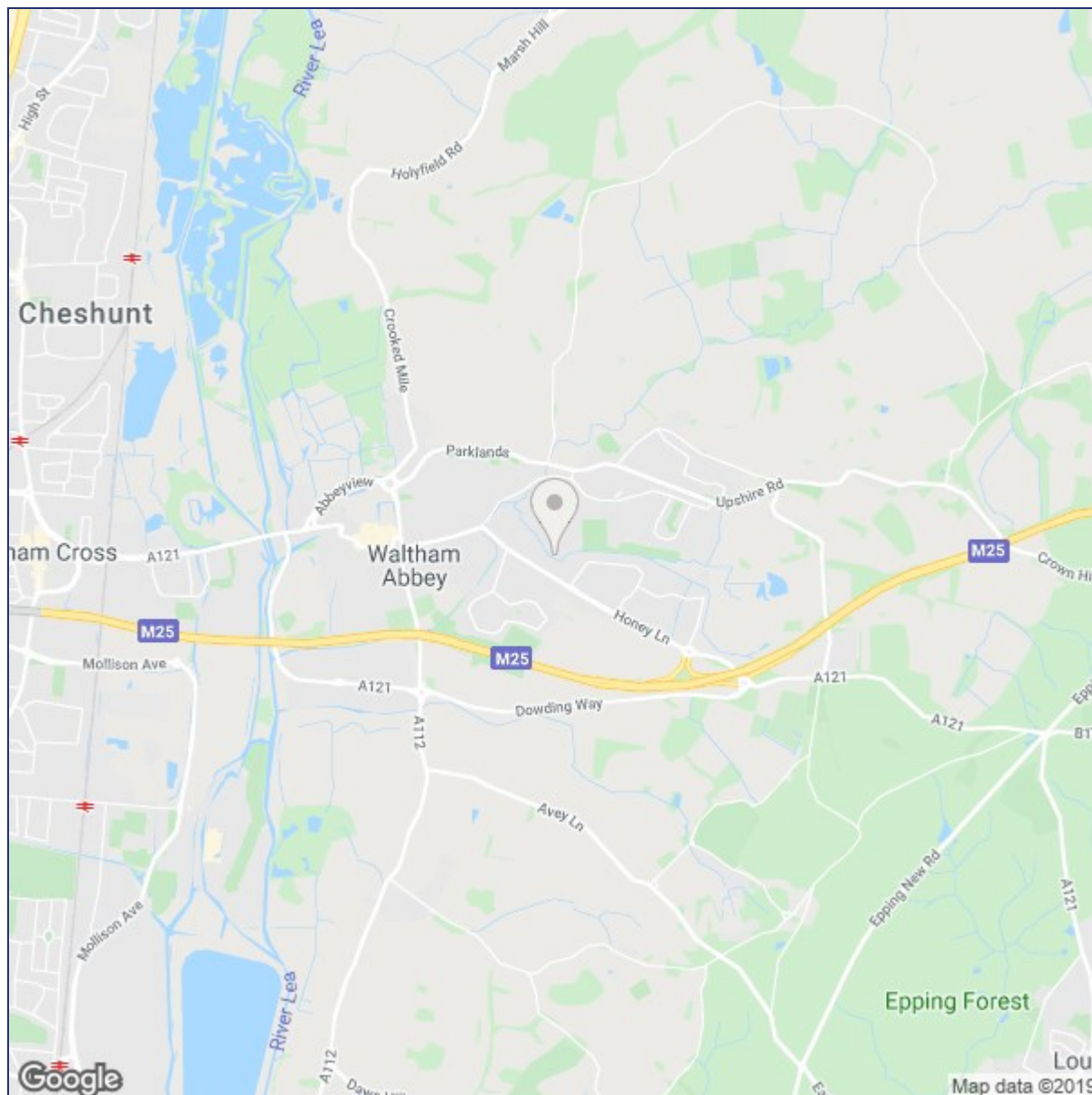

("These details are correct at time of going to press").

THE PROPERTY MISDESCRIPTIONS ACT 1991. The agent has not tested any apparatus, equipment, fixtures or services and so cannot verify that they are in working order, or fit for the purpose. References to the Tenure of a property are based on information supplied by the vendor. The agent has not had sight of the Title documents. A buyer is advised to obtain verification from their Solicitor or Surveyor.

