

FLETCHERS

ESTATE AGENTS



Acton Lane, W4

£600,000

A three bedroom terraced house that would benefit from modernisation and extending (STPP). The ground floor comprises of a reception room, dining room and separate kitchen. The property benefits from a patio garden, access to the loft from the landing and no onward chain.

Acton Lane runs from the heart of Chiswick up to Acton, just north of Southfield Road within half a mile off Chiswick Park station and within a quarter of a mile from South Acton station. Also providing easy access to Chiswick High Road and the local amenities as well as easy access in and out of London via the A4.

• Three Bedrooms • Potential To Extend (STPP) • Period Property • Patio Garden • Good Transport Links • No Onward Chain •

FLETCHERS

ESTATE AGENTS

Ground Floor

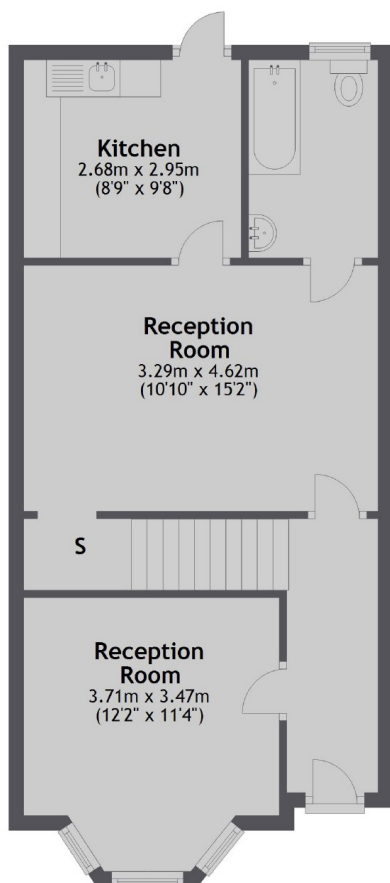

First Floor

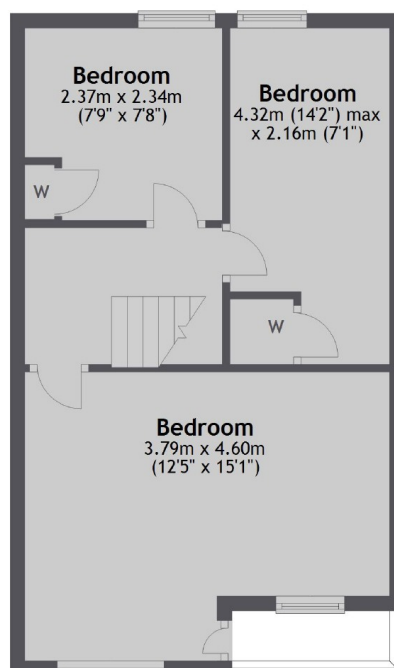

Total area: approx. 87.1 sq. metres (937.3 sq. feet)

Fletchers Chiswick Turnham Green
Sales
58 Turnham Green Terrace, London, W4
1QP
020 8987 3000

Energy Rating: D. We aim to make our particulars both accurate and reliable. However they are not guaranteed; nor do they form part of an offer or contract. If you require clarification on any points then please contact us, especially if you're traveling some distance to view. Please note that appliances and heating systems have not been tested and therefore no warranties can be given as to their good working order.