



## Syon Lane, Isleworth, London TW7 5NJ

A stunning newly refurbished three bedroom extended family home with large south-facing garden. Offering spacious through lounge, luxury wrap-round kitchen with separate dining and downstairs W/C. Upstairs consists of family bathroom suite with separate shower and three spacious bedrooms. This is one not to be missed. Early viewings are recommended!

Located within easy reach to SKY/GSK buildings and Syon Lane Rail Station

**£1,700 PER MONTH**

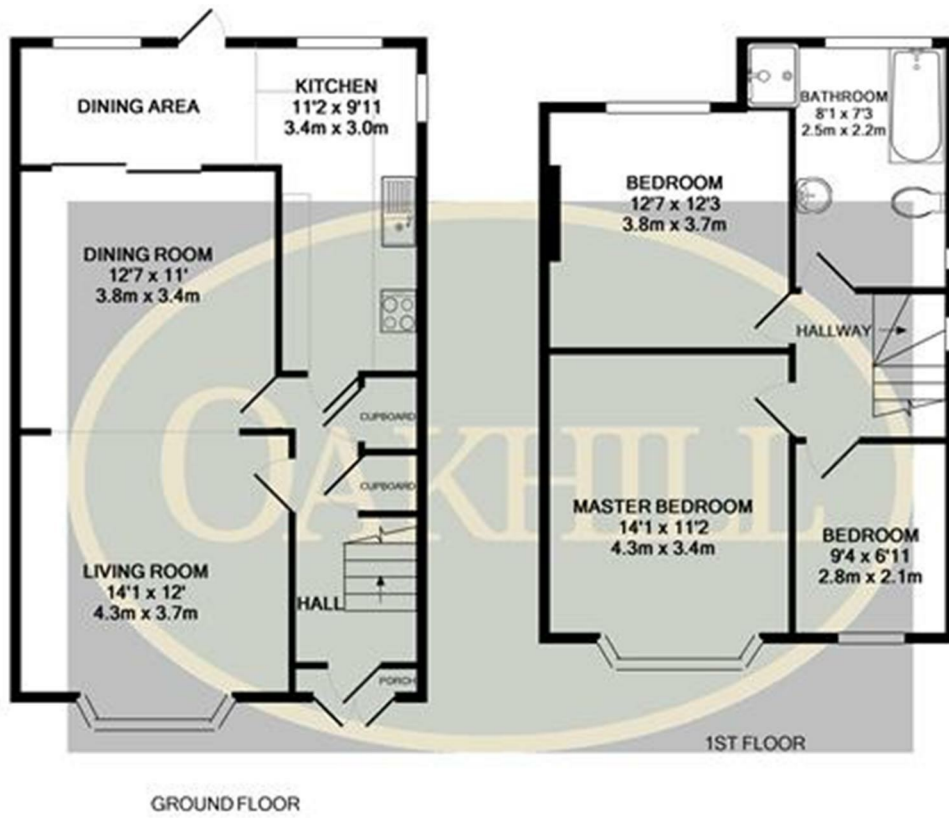

Whilst every attempt has been made to ensure the accuracy of the floor plan contained here, measurements of doors, windows, rooms and any other items are approximate and no responsibility is taken for any error, omission, or mis-statement. This plan is for illustrative purposes only and should be used as such by any prospective purchaser. The services, systems and appliances shown have not been tested and no guarantee as to their operability or efficiency can be given.  
 Made with Metropix ©2018

Energy Efficiency Rating		Current	Potential
Very energy efficient - lower running costs			
(92 plus) <b>A</b>			
(81-91) <b>B</b>			
(69-80) <b>C</b>			
(55-68) <b>D</b>			
(39-54) <b>E</b>			
(21-38) <b>F</b>			
(1-20) <b>G</b>			
Not energy efficient - higher running costs			
<b>England &amp; Wales</b>	EU Directive 2002/91/EC		

Environmental Impact (CO <sub>2</sub> ) Rating		Current	Potential
Very environmentally friendly - lower CO <sub>2</sub> emissions			
(92 plus) <b>A</b>			
(81-91) <b>B</b>			
(69-80) <b>C</b>			
(55-68) <b>D</b>			
(39-54) <b>E</b>			
(21-38) <b>F</b>			
(1-20) <b>G</b>			
Not environmentally friendly - higher CO <sub>2</sub> emissions			
<b>England &amp; Wales</b>	EU Directive 2002/91/EC		



6 South Street, Isleworth, TW7 7BG  
 Tel: 0208 568 4433  
 info@oakhillagents.co.uk  
 www.oakhillagents.co.uk

**OAKHILL**