



## Willcott Road, W3

£1,025,000

An immaculate three bedroom Victorian home with two reception rooms, potential to extend (STPP) and a garden.

Acton Town, Ealing Common, Acton Central (Overground) and Acton Main Line stations are all within a mile.

- Three Bedrooms • Victorian • Garden •
- Cellar • Two Reception Rooms • Dining Area •

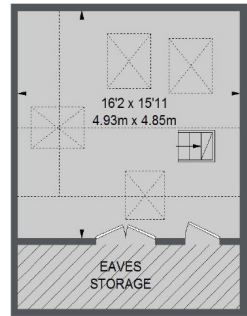

SECOND FLOOR



GROUND FLOOR

FIRST FLOOR

= REDUCED HEADROOM BELOW 1.5 M / 5'0

TOTAL APPROX. FLOOR AREA  
(EXCLUDING EAVES STORAGE)  
1670 SQ. FT. (155.14 SQ. M.)

Robertson Smith & Kempson Acton Sales  
98 High Street, London, W3  
6QX  
020 8896 3996  
actonsales@robertsonsmithandkempson.co.uk

Energy Rating: D. We aim to make our particulars both accurate and reliable. However they are not guaranteed; nor do they form part of an offer or contract. If you require clarification on any points then please contact us, especially if you're traveling some distance to view. Please note that appliances and heating systems have not been tested and therefore no warranties can be given as to their good working order.